

RFCT-SMA-CAP-GS-5: SUS303 STAINLESS STEEL PROTECTIVE CAP WITH GASKET FOR SMA JACK, RATED TO IP67

Material and Plating:

1. Shell: SUS303 stainless steel, passivated.
2. Gasket: silicone, color: red.

Environmental:

1. This product has been tested to IP67.
2. In order to achieve IP67 this cap is intended for use in conjunction with all rear mount SMA connectors from the GCT Nautilus range.
3. GCT will accept no responsibility for the performance of this cap if it is used with connectors not from the Nautilus range.

Notes:

1. In order to achieve IP67 sealing, then at least 5.64mm of thread on the SMA bulkhead jack is required. If there is less than 5.64mm thread then the cap will not achieve IP67. Contact GCT for more information.
2. It's likely if this cap is used with Front Mount SMA connectors from GCT's Nautilus range that the cap will not offer IP67 sealing due to the lack of thread depth, therefore this cap is not recommended to be used in applications with front mount SMA where an IP rating is required.
3. Operating temperature: -40°C~+125°C.
4. Caps to be installed finger tight only. Do not overtighten.

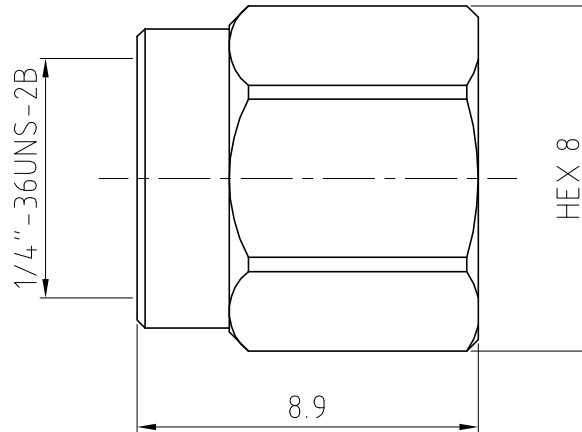

REV. DATE & DRN
 10 25/06/21-NYW RELEASE
 11 07/11/21-CC
 Add SUS303 to the title.
 Add GCT logo.
 12 12/05/25-NYW
 Add GCT logo.

Scale: NTS	THIRD ANGLE	Unstated Tolerances:
Drawn: CC		.X ±0.2
App'd: XXX	Title SMA CAP	.XX ±0.2
Date: 12 MAY '25	Revision: 1.2	.XXX ±0.2
	Unit: mm	ANGLES N/A

IP Rated
RF Products

www.gct.co www.gradconn.com

Drawing Number:
RFCT-SMA-CAP-GS-5

Sheet 1 of 1

Drawing © E and O E