

BB02-ND :- 1.27mmX1.27mm PIN HEADER, D/R, STRAIGHT OR RIGHT ANGLE, T/H TYPE - 6 TO 100 CONTACTS

SPECIFICATIONS

CURRENT RATING	1 AMP
INSULATOR RESISTANCE	5000 MEGOHMS MIN.
CONTACT RESISTANCE	20 MILIOHMS MAX.
DIELECTRIC WITHSTANDING	AC 500 V
OPERATING TEMPERATURE	-40°C TO +105°C
CONTACT MATERIAL	BRASS
INSULATOR MATERIAL	POLYESTER, UL 94V-0 STANDARD NYLON 6T
PLATING	GOLD OR TIN OVER 50U" NICKEL
SOLDERABILITY	IR REFLOW: 260°C FOR 10 SEC WAVE: 230°C FOR 5-10 SEC MANNUAL SOLDER: 350°C FOR 3-5 SEC

PACKED LOOSE IN BAG OR BOX.

MATES WITH :-

BB02-CL	BB02-CU
BB02-CM	BB02-CW
BB02-CN	BB02-CX
BB02-CQ	BB02-CZ
BB02-CR	

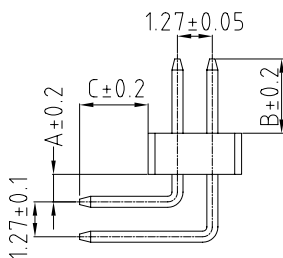

RIGHT ANGLE TYPE

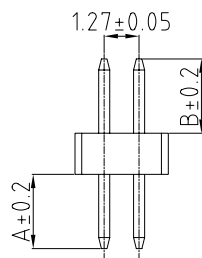

STRAIGHT TYPE

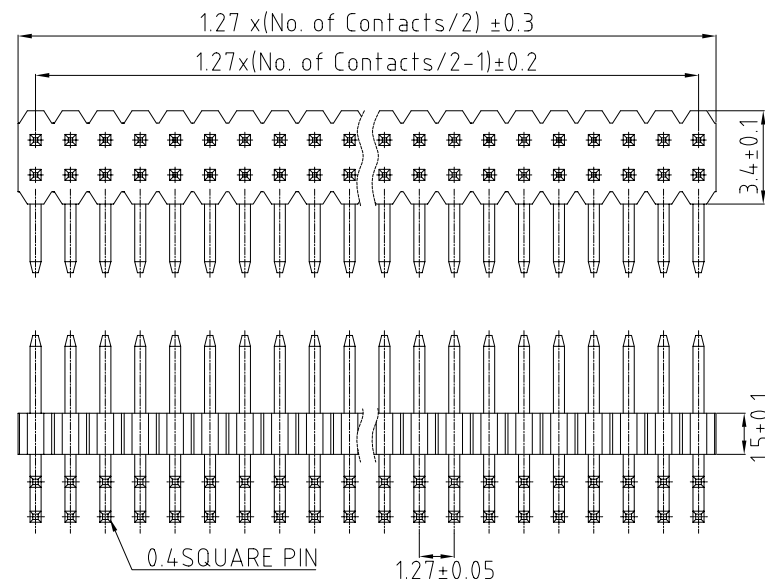

HOW TO ORDER



NO. OF CONTACTS
06 TO 98
00 = 100

CONTACT PLATING OPTIONS
K = GOLD FLASH (STANDARD)
A = 10U" GOLD ON CONTACT/GOLD FLASH ON TAIL
B = 15U" GOLD ON CONTACT/GOLD FLASH ON TAIL
C = 30U" GOLD ON CONTACT/GOLD FLASH ON TAIL
T = BRIGHT TIN
M = MATT TIN
D = GOLD FLASH ON CONTACT/TIN ON TAIL
E = 10U" GOLD ON CONTACT/TIN ON TAIL
F = 15U" GOLD ON CONTACT/TIN ON TAIL
G = 30U" GOLD ON CONTACT/TIN ON TAIL

CONNECTOR TYPE
S = STRAIGHT
R = RIGHT ANGLE

PIN LENGTH A (1/10mm)
PLEASE SPECIFY PIN LENGTH REQUIRED
I.E. 2.5mm = 25
STANDARD = 30
TOL. ±0.2mm

PIN LENGTH B (1/10mm)
PLEASE SPECIFY PIN LENGTH REQUIRED
I.E. 2.5mm = 25
STANDARD = 30
TOL. ±0.2mm

PIN LENGTH C (1/10mm)
PLEASE SPECIFY PIN LENGTH REQUIRED
I.E. 2.5mm = 25
STANDARD = 23
TOL. ±0.2mm

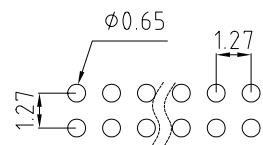

RECOMMENDED PCB LAYOUT

REV.	DATE & DRN
1.0	10/02/04 - IUR RELEASE
1.1	10/02/05 - NYW DRAWING MODIFICATION
1.2	10/16/06 - NYW AMEND B OPTION
1.3	05/03/08 - CHC DRAWING MODIFICATION

Scale: 5:1	THIRD ANGLE	Unstated Tolerances: 0 Dec Places 1 Dec Places 2 Dec Places 3 Dec Places	Material SEE NOTE
Drawn: CHC			
App'd: XXXX	Title: PIN HEADER		NOT TO SCALE
Date: 05 MAR '08	Revision: 1.3		Unit: mm

www.gradconn.com

THIS DRAWING IS CONFIDENTIAL AND MUST NOT BE COPIED OR DISCLOSED WITHOUT WRITTEN CONSENT

Type: BB02-ND
BB02-ND
Drawing Number:
Sheet 1 of 1
Drawing © E and OE