

BB02-JE :- 2.54mm (0.1") SOCKET, SINGLE ROW, THROUGH HOLE, 02 TO 40 CONTACTS

SPECIFICATIONS

CURRENT RATING 3 AMP
 INSULATOR RESISTANCE 1000 MEGOHMS MIN.
 CONTACT RESISTANCE 20 m ohms MAX.
 DIELECTRIC WITHSTANDING AC 600 V
 OPERATING TEMPERATURE -40°C TO +105°C
 CONTACT MATERIAL PHOSPHOR BRONZE
 INSULATOR MATERIAL THERMOPLASTIC, UL 94V-0
 NYLON 6T : STANDARD
 PBT : SPECIAL OPTION
 PLATING GOLD, TIN OR SELECTIVE OVER 30-50U" NICKEL
 SOLDERABILITY: NYLON 6T - IR REFLOW: 260°C FOR 10 SEC
 WAVE: 230°C FOR 5-10 SEC
 MANUAL SOLDER: 350°C FOR 3-5 SEC

NOTES:

1. PACKED IN TUBE OR TRAY \triangle
2. RECOMMENDED MATING PIN LENGTH: 4.5MM \triangle

MATES WITH: - BB02-HA BB02-HY
 BB02-HC BB02-TC
 BB02-HD BB02-TJ
 BB02-HG BB02-TK
 BB02-HH BB02-TP

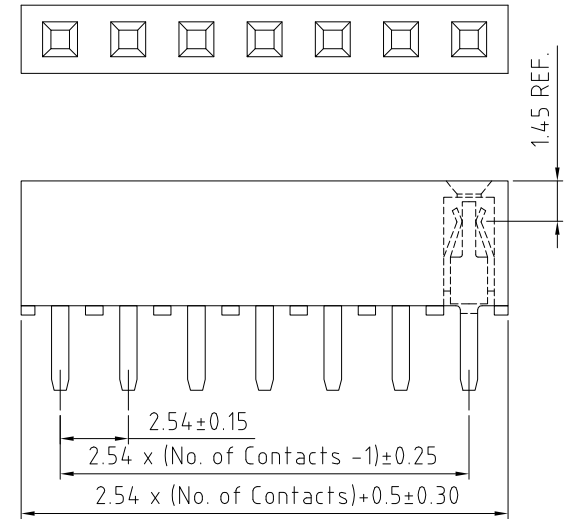
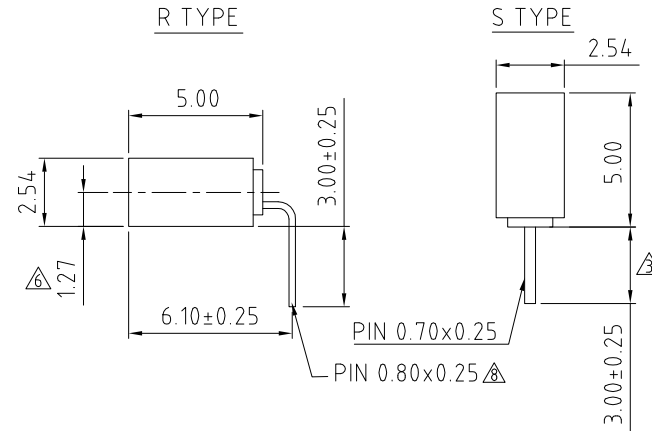

HOW TO ORDER

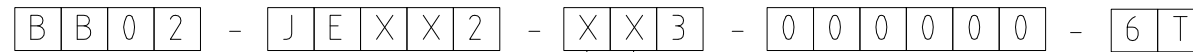

\triangle NO. OF CONTACTS: 02 TO 40

CONTACT PLATING OPTIONS:
 K = GOLD FLASH (STANDARD)
 A = 10U" GOLD ON CONTACT/GOLD FLASH ON TAIL
 B = 15U" GOLD ON CONTACT/GOLD FLASH ON TAIL
 C = 30U" GOLD ON CONTACT/GOLD FLASH ON TAIL
 T = BRIGHT TIN
 M = MATT TIN
 D = GOLD FLASH ON CONTACT/BRIGHT TIN ON TAIL
 E = 10U" GOLD ON CONTACT/BRIGHT TIN ON TAIL
 F = 15U" GOLD ON CONTACT/BRIGHT TIN ON TAIL
 G = 30U" GOLD ON CONTACT/BRIGHT TIN ON TAIL

CONNECTOR TYPE:
 S = STRAIGHT
 R = RIGHT ANGLE

INSULATOR MATERIAL: \triangle
 6T = NYLON 6T (STANDARD)
 BLANK = PBT (Not suitable for new designs.)

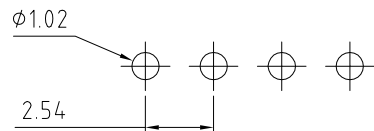

RECOMMENDED PC BOARD HOLE LAYOUT (TOLERANCE: ±0.05)

REV.	DATE & DRN
10	29/06/02 - SJT RELEASE
11	07/04/05 - NYW
\triangle	AMEND PACK OPTION
\triangle	AMEND NO. OF CONTACTS
12	17/02/09 - CHC
\triangle	ADD PLASTIC OPTION
\triangle	DRAWING MODIFICATION
13	18/10/06 - NYW
\triangle	AMEND PIN LENGTH OF S TYPE
14	29/05/07 - NYW
\triangle	ADD NOTES 2
15	27/05/08 - PN
\triangle	ADD MATT TIN PLATING
16	29/08/08 - NYW
\triangle	ADD R TYPE CENTERLINE
17	17/02/09 - CHC
\triangle	DRAWING MODIFICATION
18	23/04/14
\triangle	AMEND R TYPE PIN SIZE

Scale:	5:1	THIRD ANGLE	Unstated Tolerances: X. ± 0.30 .X ± 0.25 .XX ± 0.15 .XXX ± 0.10	Material	SEE NOTE
Drawn:	CHC				
App'd:	XXXX	Title	SOCKET	NOT TO SCALE	
Date:	23 APR. '14	Revision:	18		

www.gradconn.com

THIS DRAWING IS CONFIDENTIAL AND MUST NOT BE COPIED OR DISCLOSED WITHOUT WRITTEN CONSENT

Type:	BB02-JE
BB02-JE	
Drawing Number:	
Sheet 1	of 1
Drawing ©	E and O E