

BB02-HR :- 2.54mm X 2.54mm (0.1" X 0.1") SMT BOX HEADER, DUAL ROW, STRAIGHT, 06 TO 64 CONTACTS

SPECIFICATIONS :

CURRENT RATING 3 AMPS
 INSULATOR RESISTANCE 1000 MEGOHMS MIN.
 DIELECTRIC WITHSTANDING AC 600 V
 OPERATING TEMPERATURE -40°C TO +105°C
 CONTACT MATERIAL BRASS
 INSULATOR MATERIAL THERMOPLASTIC, UL 94V-0
 STANDARD NYLON-6T
 PLATING TIN, GOLD OR SELECTIVE OVER 30~50U" NICKEL
 SOLDERABILITY IR REFLOW: 260°C FOR 10 SEC
 MANUAL SOLDER: 350°C FOR 3-5 SEC

MATES WITH: - BB02-KA BB02-KU
 BB02-KD BB02-KW (perfect mate)
 BB02-KH BB02-LD
 BB02-KK
 BB02-KT

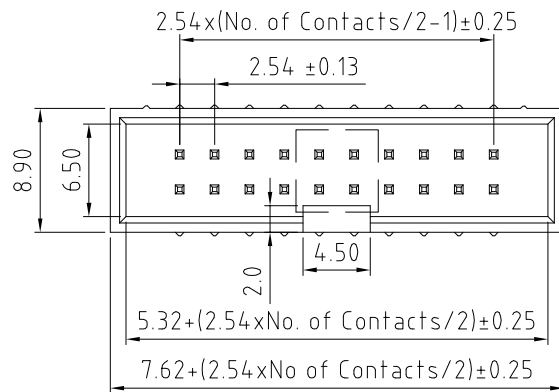

Pin #	Dim. D
06~10	6.0
12~64	8.5

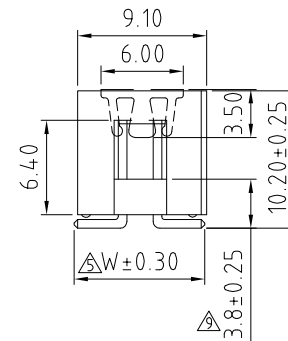
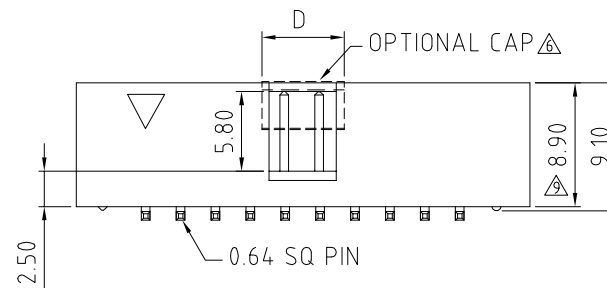

HOW TO ORDER

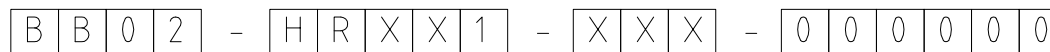

△ NO. OF CONTACTS:
 06 TO 64
 (SOME PIN# WOULD
 REQUIRE HIGHER MOQ.)

CONTACT PLATING OPTIONS:
 K = GOLD FLASH (STANDARD)
 A = 10U" GOLD ON CONTACT/GOLD FLASH ON TAIL
 B = 15U" GOLD ON CONTACT/GOLD FLASH ON TAIL
 C = 30U" GOLD ON CONTACT/GOLD FLASH ON TAIL
 T = BRIGHT TIN
 M = MATT TIN
 △ D = GOLD FLASH ON CONTACT/BRIGHT TIN ON TAIL
 E = 10U" GOLD ON CONTACT/BRIGHT TIN ON TAIL
 F = 15U" GOLD ON CONTACT/BRIGHT TIN ON TAIL
 G = 30U" GOLD ON CONTACT/BRIGHT TIN ON TAIL

"W" OPTIONS: △
 0 = 9.50
 A = 11.18
 B = 10.25

PACKAGING OPTIONS:
 2 = TRAY
 3 = TUBE (STANDARD)
 5 = TUBE + CAP
 6 = TAPE & REEL
 △8 = TAPE & REEL + CAP

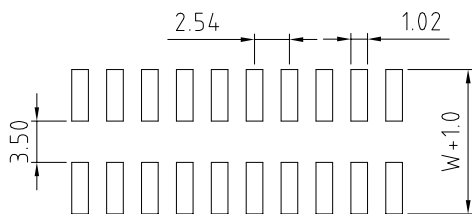

RECOMMENDED PC BOARD LAYOUT
 (TOLERANCE: ±0.05)

REV. DATE & DRN	10. 19/09/03 - NJR RELEASE
11. 16/07/07 - NJR	ADD PLATING OPTIONS
12. 15/08/06 - NYW	AMEND NO. OF CONTACTS
13. 12/01/07 - NYW	AMEND NO. OF CONTACTS
14. 16/07/07 - NYW	ADD PACK OPTION 5
15. 31/01/08 - NYW	DRAWING MODIFICATION
16. 10/07/08 - NYW	REWORK 66, 64 CONTACTS
17. 12/01/08 - NYW	AMEND PIN#
18. 13/02/09 - EHC	ADD W OPTIONS
19. 10/11/09 - NYW	PLATING MODIFICATION
20. 07/03/16 - NYW	AMEND AND ADD DIMENSION
21. 27/07/16 - NYW	AMEND MATING P/N
22. 17/04/17 - NYW	AMEND OPERATING TEMP.
23. 15/09/17 - NYW	AMEND CAP DIMENSION
24. 15/10/18 - NYW	ADD B TO W OPTION
25. 13/01/20 - NYW	AMEND OPERATING TEMP.
	ADD PACK OPTION 3
	AMEND PACK OPTION 5

Scale:	2.5:1
Drawn:	NJR
App'd:	XXXX
Date:	13 JAN. '20

THIRD ANGLE	
Title	BOX HEADER
Revision:	2.5

Unstated Tolerances:	X ± 0.30
	.X ± 0.25
	.XX ± 0.15
	.XXX ± 0.10

Material	SEE NOTE
	NOT TO SCALE
Unit:	mm

Type:	BB02-HR
Drawing Number:	BB02-HR
Sheet	1 of 1
Drawing	© E and O E