

BB02-DE :- 1.27mm x 2.54mm (0.05" x 0.1") PIN HEADER, DUAL ROW, RIGHT ANGLE, THROUGH HOLE, 06 TO 80 CONTACTS

SPECIFICATIONS

CURRENT RATING 1 AMP
 INSULATOR RESISTANCE 1000 MEGOHMS MIN.
 DIELECTRIC WITHSTANDING AC 300 V
 OPERATING TEMPERATURE -40°C TO +105°C
 CONTACT MATERIAL BRASS
 INSULATOR MATERIAL THERMOPLASTIC, UL 94V-0
 STANDARD : LCP + 30% G/F
 PLATING GOLD, TIN OR SELECTIVE OVER 30-50U" NICKEL
 SOLDERABILITY IR REFLOW: 280°C FOR 10 SEC
 WAVE: 250°C FOR 5-10 SEC
 MANUAL SOLDER: 380°C FOR 3-5 SEC

PACKED IN TRAY.

MATES WITH :- BB02-EA
 BB02-EB
 BB02-EC

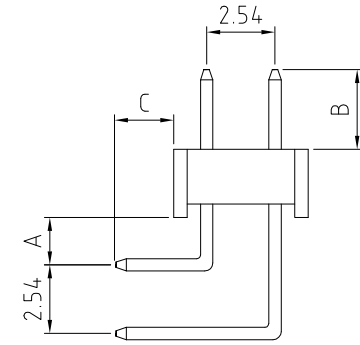
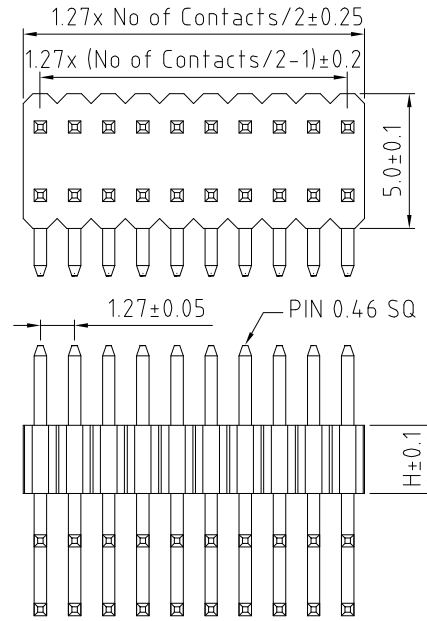

HOW TO ORDER

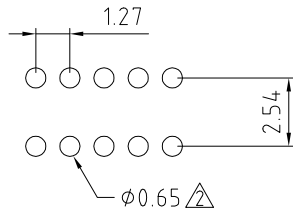
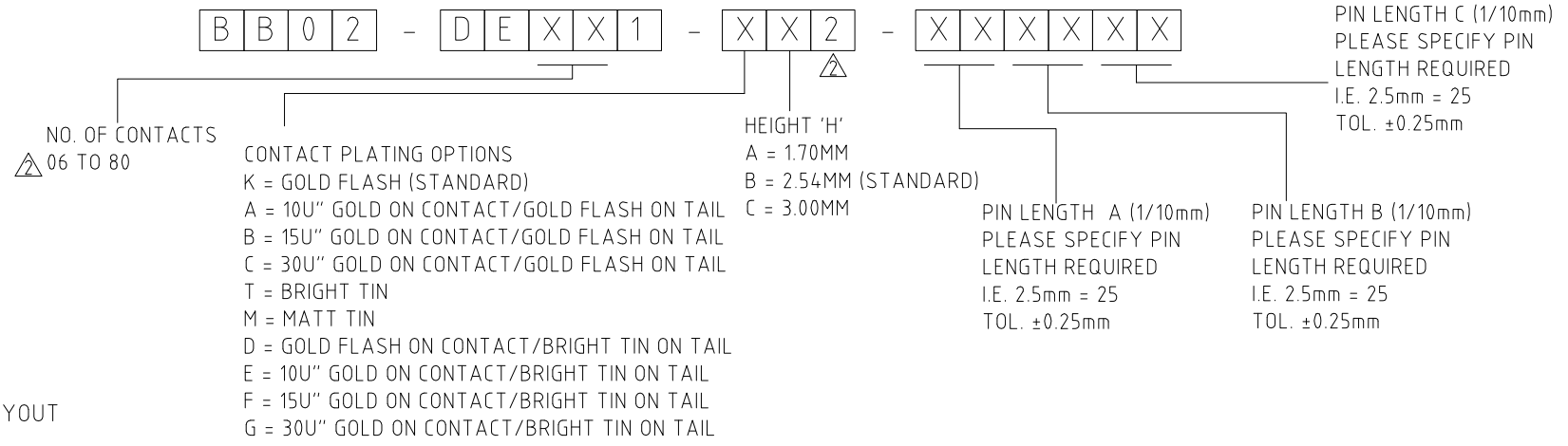

RECOMMENDED PC BOARD HOLE LAYOUT (TOLERANCE: ±0.05)

REV.	DATE & DRN	DESCRIPTION
10	25/06/03	N/R RELEASE
11	12/02/05	NYW DRAWING MODIFICATION
12	19/09/05	NYW AMEND PIN DIAMETER, AMEND PITCH OF CONTACTS, AMEND PLATING, AMEND PACKING
13	20/07/06	NYW DRAWING MODIFICATION
14	27/05/08	CHC PLATING MODIFICATION
15	29/02/08	CHC DRAWING MODIFICATION
16	20/05/11	NYW CHANGE INSULATOR TO LCP

Scale: 5:1	THIRD ANGLE	Unstated Tolerances: X ± 0.30 X ± 0.25 XX ± 0.15 XXX ± 0.10
Drawn: CHC	Title PIN HEADER	Material SEE NOTE
App'd: XXXX	Revision: 1.6	NOT TO SCALE
Date: 20 MAY '11		UNIT: mm

www.gradconn.com

THIS DRAWING IS CONFIDENTIAL AND MUST NOT BE COPIED OR DISCLOSED WITHOUT WRITTEN CONSENT

Type: BB02-DE
BB02-DE
Drawing Number:
Sheet 1 of 1
Drawing E and O E