

BB02-CE :- 1.27mm (0.05") SOCKET, SINGLE ROW, STRAIGHT, THROUGH HOLE, 2 - 35 CONTACTS. PROFILE: 8.5MM

SPECIFICATIONS

- CURRENT RATING 1 AMP
- INSULATOR RESISTANCE 1000 MEGOHMS MIN.
- CONTACT RESISTANCE 20m ohms MAX.
- DIELECTRIC WITHSTANDING AC 300 V
- OPERATING TEMPERATURE -40°C TO +105°C
- CONTACT MATERIAL PHOSPHOR BRONZE
- INSULATOR MATERIAL THERMOPLASTIC, UL 94V-0
STANDARD: LCP + 30% G/F
- PLATING GOLD, TIN OR SELECTIVE OVER 30~50U" NICKEL
- SOLDERABILITY IR REFLOW: 280°C FOR 10 SEC
WAVE: 250°C FOR 5-10 SEC
MANUAL SOLDER: 380°C FOR 3-5 SEC

PACKED IN TUBE OR BOX.

NOTES:

1. RECOMMENDED MATING PIN LENGTH : 4.0MM Δ

MATES WITH :- (0.46MM SQUARE PINS)

- Δ BB02-BL BB02-NH
- BB02-BM
- BB02-NM

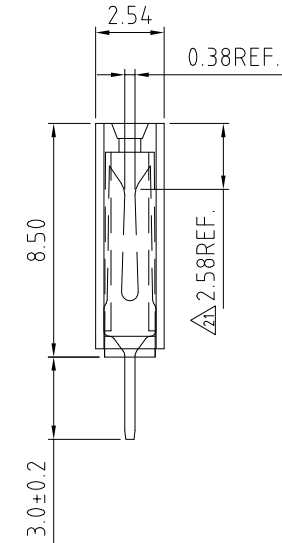
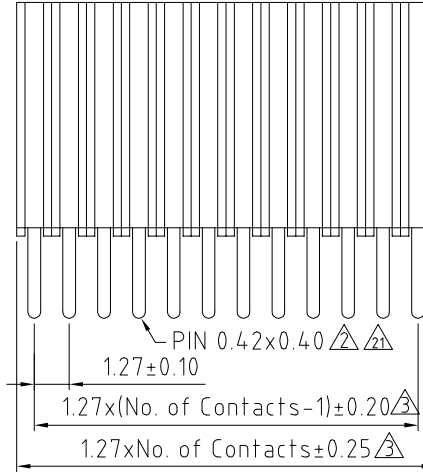
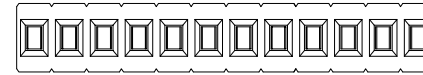

HOW TO ORDER

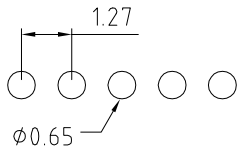
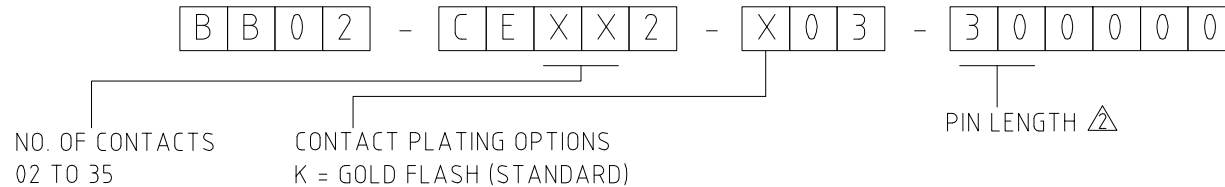

RECOMMENDED PC BOARD HOLE LAYOUT Δ
(TOLERANCE: ±0.05)

| |
|--|
| REV. DATE & DRN |
| 10 06/06/02 - S1T RELEASE |
| 11 11/02/05 - NYW DRAWING MODIFICATION |
| 12 21/07/05 - NYW CHANGE NO. OF CONTACTS |
| 13 29/07/05 - NYW AMEND PCB LAYOUT |
| 14 19/07/06 - NYW AMEND PIN DIMENSION |
| 15 05/06/07 - CHC DIMENSION MODIFICATION |
| 16 05/05/08 - CHC DRAWING MODIFICATION |
| 17 25/12/08 - CHC AMEND MATES WITH |
| 18 22/12/09 - NYW ADD TOLERANCE |
| 19 28/09/12 - NYW AMEND MATING PART |
| 20 06/07/15 - NYW CHANGE INSULATOR TO LCP |
| 21 12/07/21 - NYW REMOVE PLATING OPTIONS E-G |
| 22 01/07/21 - NYW CHANGE MIN. PIN# FROM 3 TO 2 |
| 23 01/07/21 - NYW UPDATE DIMENSIONS |

| |
|-------------------|
| Scale: 5:1 |
| Drawn: CHC |
| App'd: XXXX |
| Date: 12 JAN. '21 |

| |
|---------------|
| THIRD ANGLE |
| Title SOCKET |
| Revision: 2.1 |

| |
|---|
| Unstated Tolerances: X ± 0.30 X ± 0.25 XX ± 0.15 XXX ± 0.10 |
| Material SEE NOTE |
| NOT TO SCALE |
| UNIT: mm |

www.gradconn.com

| |
|---------------------|
| Type: BB02-CE |
| BB02-CE |
| Drawing Number: |
| Sheet 1 of 1 |
| Drawing © E and O E |