

CABLE 363 RF: RF CABLE ASSEMBLY, MURATA JSC PLUG + SMA STRAIGHT PLUG + 0.81MM CABLE - 3GHz

SPECIFICATIONS

1. MURATA JSC PLUG, P/N: MXJA01
2. 0.81MM COAXIAL CABLE, COLOR: WHITE
3. SMA STRAIGHT PLUG, P/N: RFCT-SMA023-F08

NOTES:

1. WORKING FREQUENCY RANGE: DC-3GHz
2. OPERATING TEMPERATURE: -40°C TO +85°C
3. IMPEDANCE: 50 OHM

USAGE PRECAUTIONS: CABLES USING 'MICRO' COAX ARE DELICATE:

- (i) HANDLE WITH CARE.
- (ii) DO NOT TWIST; APPLY EXCESSIVE FORCES OR SHARP BENDS TO THE CABLE. DO NOT FORCEFULLY DEFORM WIRES.
- (iii) CONSULT CONNECTOR MANUFACTURER'S DATASHEETS FOR DETAILED NOTES ON HANDLING INSTRUCTIONS.

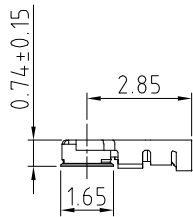
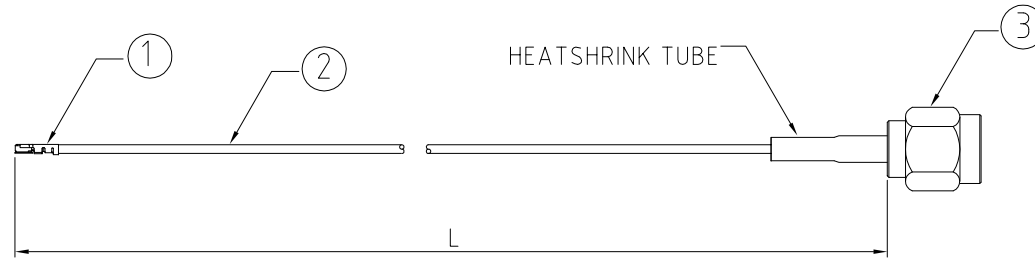

MURATA JSC DETAIL

HOW TO ORDER
CABLE 363 RF - X X X

"L" LENGTH IN MM
eg: 100MM = 100
(MIN. 025-MAX.400)
STANDARD = 100, 150, 200)
Tolerance: <50mm : ±2mm.
51-200mm: ±5mm.
201-400mm: ±7mm.

REV. DATE & DRN TO 12/17/19 - NYW RELEASE

Scale: NTS	THIRD ANGLE	Unstated .X .XX .XXX ANGLES	Tolerances: N/A N/A N/A N/A	Material SEE NOTE
Drawn: NYW				
App'd: XXX	Title CABLE ASSEMBLY	NOT TO SCALE		
Date: 13 NOV. '19	Revision: 1.0	Unit: mm		



www.gradconn.com

THIS DRAWING IS CONFIDENTIAL AND MUST NOT BE COPIED OR DISCLOSED WITHOUT WRITTEN CONSENT

Type: Cable 363 RF
CABLE 363 RF
Drawing Number:
Sheet 1 of 1
Drawing © E and O E