

BB02-RM :- 2.00mm (0.079") PIN HEADER, SINGLE ROW, STRAIGHT, THROUGH HOLE, BOARD SPACER - 02 to 40 CONTACTS

SPECIFICATIONS

| | |
|-------------------------|---|
| CURRENT RATING | 2 AMP |
| INSULATOR RESISTANCE | 1000 MEGOHMS MIN. |
| DIELECTRIC WITHSTANDING | AC 500 V |
| CONTACT RESISTANCE | 20m OHMS MAX. |
| OPERATING TEMPERATURE | -40°C TO +105°C |
| CONTACT MATERIAL | BRASS |
| INSULATOR MATERIAL | THERMOPLASTIC, UL 94V-0 NYLON 6T (STANDARD) |
| PLATING | GOLD, TIN, OR SELECTIVE OVER 30-50U" NICKEL |
| SOLDERABILITY: | IR REFLOW: 260°C FOR 10 SEC WAVE: 230°C FOR 5-10 SEC MANUAL SOLDER: 350°C FOR 3-5 SEC |

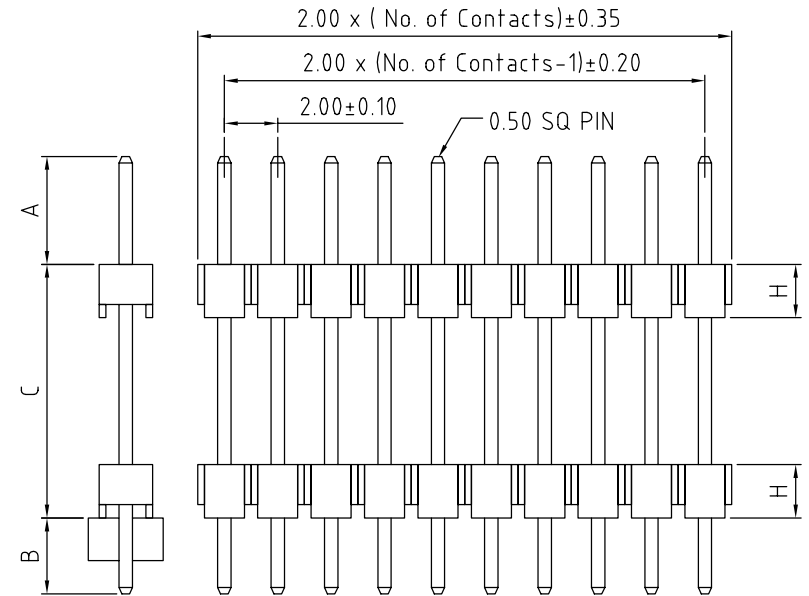
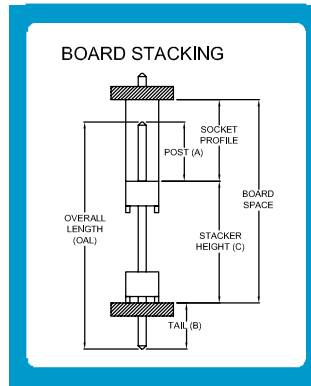

STANDARD PACKAGING: LOOSE IN BAG OR BOX.

MATES WITH: - BB02-GD BB02-RK BB02-RW
BB02-GS BB02-RS

NOTES:
1. MAX. OAL (OVERALL PIN LENGTH A+C+B) = 45mm.

HOW TO ORDER

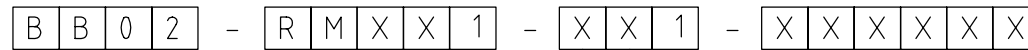

NO. OF CONTACTS
02 TO 40

CONTACT PLATING OPTIONS

- K = GOLD FLASH (STANDARD)
- A = 10U" GOLD ON CONTACT/GOLD FLASH ON TAIL
- B = 15U" GOLD ON CONTACT/GOLD FLASH ON TAIL
- C = 30U" GOLD ON CONTACT/GOLD FLASH ON TAIL
- T = BRIGHT TIN
- M = MATT TIN
- D = GOLD FLASH ON CONTACT/BRIGHT TIN ON TAIL
- E = 10U" GOLD ON CONTACT/BRIGHT TIN ON TAIL
- F = 15U" GOLD ON CONTACT/BRIGHT TIN ON TAIL
- G = 30U" GOLD ON CONTACT/BRIGHT TIN ON TAIL

"H" INSULATOR HEIGHT OPTION
A = 1.5
B = 2.0 (STANDARD)

PIN LENGTH A (1/10mm)
SPECIFY PIN LENGTH
STANDARD = 40 = 4.0mm
MINIMUM = 10 = 1.0mm
MAXIMUM = 150 = 15.0mm
TOL.: ±0.25mm

PIN LENGTH B (1/10mm)
SPECIFY PIN LENGTH
STANDARD = 28 = 2.8mm
MINIMUM = 10 = 1.0mm
MAXIMUM = 150 = 15.0mm
TOL.: ±0.25mm

PIN LENGTH C (1/10mm)
SPECIFY PIN LENGTH
STANDARD = 75 = 7.5mm
MINIMUM = H HEIGHT x 2
MAXIMUM = SEE NOTE: 1
TOL.: ±0.25mm

LONGER PIN LENGTH REQUIRED?
If pin length required is longer than 9.9mm (99), then use a '/' to separate the numbers.
Example: A=6.0mm, B=3.0mm, C=12.5mm, mark as 60 / 30 / 125.

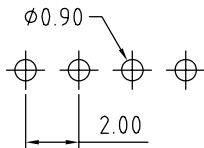

RECOMMENDED PCB LAYOUT

| | | | | | |
|------------------|-------------------|---|----------------------|--|--------------------|
| Scale: 5:1 | THIRD ANGLE | Unstated Tolerances: X ± 0.30 X ± 0.25 .XX ± 0.15 .XXX ± 0.10 | Material SEE NOTE | www.gradconn.com | Type: BB02-RM |
| Drawn: NYW | | | | | BB02-RM |
| App'd: XXXX | Title: PIN HEADER | | NOT TO SCALE | | Drawing Number: |
| Date: 05 JAN '09 | Revision: 1.0 | | Unit: mm | | Sheet 1 of 1 |
| | | | | THIS DRAWING IS CONFIDENTIAL AND MUST NOT BE COPIED OR DISCLOSED WITHOUT WRITTEN CONSENT | Drawing C E and OE |