

BB02-NU :- 1.27mm (0.05") FEMALE HEADER, SINGLE ROW, STRAIGHT, THROUGH HOLE, 2 - 33 CONTACTS

SPECIFICATIONS

CURRENT RATING 1 AMP
 INSULATOR RESISTANCE 1000 MEGOHMS MIN.
 CONTACT RESISTANCE 20m ohms MAX.
 DIELECTRIC WITHSTANDING AC 300 V
 OPERATING TEMPERATURE -40°C TO +105°C
 CONTACT MATERIAL PHOSPHOR BRONZE
 INSULATOR MATERIAL THERMOPLASTIC, UL 94V-0
 STANDARD: LCP + 30% G/F
 PLATING GOLD, TIN OR SELECTIVE OVER 30~50U" NICKEL
 SOLDERABILITY IR REFLOW: 280°C FOR 10 SEC
 WAVE: 250°C FOR 5-10 SEC
 MANUAL SOLDER: 380°C FOR 3-5 SEC

PACKED IN TUBE OR TRAY.

NOTES:

1. RECOMMENDED MATING PIN LENGTH : 2.0MM
2. THIS PART IS SUITABLE FOR 1.5MM AND 3.0MM MATING PIN.

MATES WITH :- (0.46MM SQUARE PINS)
 BB02-BL BB02-NH
 BB02-BM BB02-NM

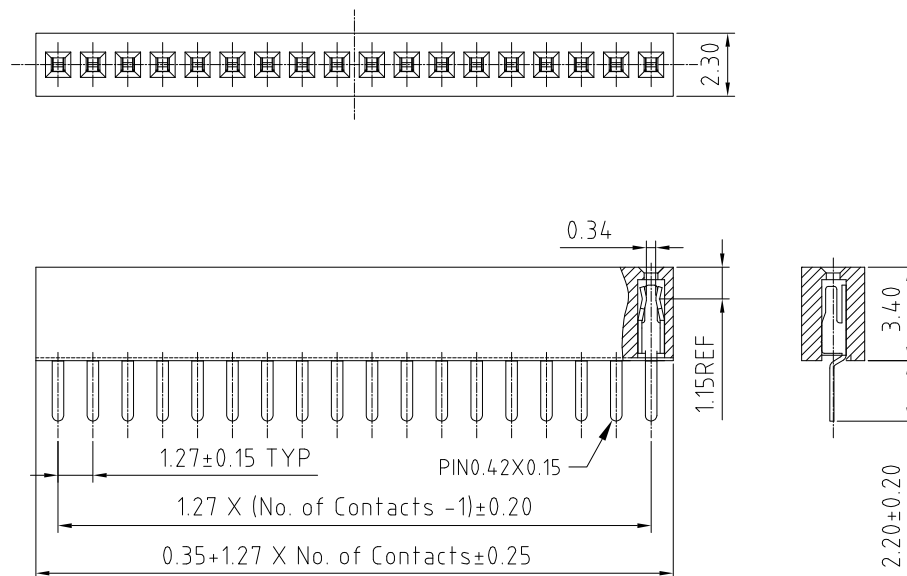

HOW TO ORDER

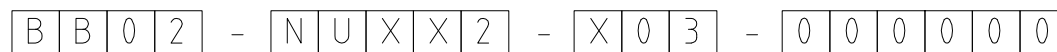

NO. OF CONTACTS
02 to 33

CONTACT PLATING OPTIONS
 K = GOLD FLASH (STANDARD)
 A = 10U" GOLD ON CONTACT/GOLD FLASH ON TAIL
 B = 15U" GOLD ON CONTACT/GOLD FLASH ON TAIL
 C = 30U" GOLD ON CONTACT/GOLD FLASH ON TAIL
 T = BRIGHT TIN
 M = MATT TIN
 D = GOLD FLASH ON CONTACT/BRIGHT TIN ON TAIL

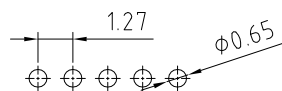

RECOMMENDED PC BOARD HOLE LAYOUT
(TOLERANCE: ±0.05)

REV. DATE EORN
 10 26/07/09 - CHC RELEASE
 11 REMOVE PLATING OPTIONS E-G

Scale: 1:1	THIRD ANGLE	Unstated Tolerances: X ± 0.30 X ± 0.25 XX ± 0.15 XXX ± 0.10	Material SEE NOTE
Drawn: CHC			
App'd: XXXX	Title SOCKET		NOT TO SCALE
Date: 5 OCT. '12	Revision: 11		UNIT: mm

www.gradconn.com

THIS DRAWING IS CONFIDENTIAL AND MUST NOT BE COPIED OR DISCLOSED WITHOUT WRITTEN CONSENT

Type: BB02-NU
BB02-NU
Drawing Number:
Sheet 1 of 1
Drawing © E and O E