

BB02-NC :- 1.27mm (0.05") PIN HEADER, SINGLE ROW, STRAIGHT, THROUGH HOLE TYPE - 02 TO 33 CONTACTS

SPECIFICATIONS :

CURRENT RATING 1 AMP
 INSULATOR RESISTANCE 1000 MEGOHMS MIN.
 DIELECTRIC WITHSTANDING AC 300 V
 CONTACT RESISTANCE 20m OHMS MAX.
 OPERATING TEMPERATURE -40°C TO +105°C
 CONTACT MATERIAL BRASS
 INSULATOR MATERIAL THERMOPLASTIC, UL 94V-0
 STANDARD: LCP (H=1.50MM, 2.0MM, 2.54MM)
 NYLON 6T (H=1.00MM)

PLATING GOLD, TIN, OR SELECTIVE OVER 30-50U" NICKEL
 SOLDERABILITY LCP - IR REFLOW: 280°C FOR 10 SEC
 MANUAL SOLDER: 380°C FOR 3-5 SEC
 NYLON 6T - IR REFLOW: 260°C FOR 10 SEC
 MANNUAL SOLDER: 350°C FOR 3-5 SEC

MATES WITH :- BB02-CP
 BB02-CT
 BB02-CY

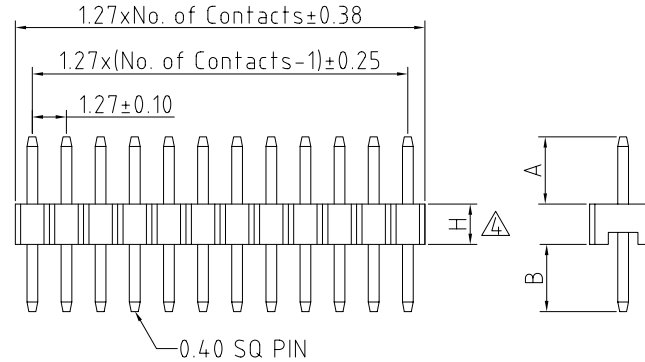
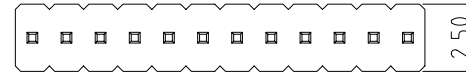

HOW TO ORDER

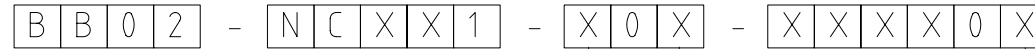

NO. OF CONTACTS
02 TO 33

CONTACT PLATING OPTIONS
 K = GOLD FLASH (STANDARD)
 A = 10U" GOLD ON CONTACT/GOLD FLASH ON TAIL
 B = 15U" GOLD ON CONTACT/GOLD FLASH ON TAIL
 C = 30U" GOLD ON CONTACT/GOLD FLASH ON TAIL
 T = BRIGHT TIN
 M = MATT TIN
 D = GOLD FLASH ON CONTACT/BRIGHT TIN ON TAIL
 E = 10U" GOLD ON CONTACT/BRIGHT TIN ON TAIL
 F = 15U" GOLD ON CONTACT/BRIGHT TIN ON TAIL
 G = 30U" GOLD ON CONTACT/BRIGHT TIN ON TAIL

PACKAGING OPTIONS
 2 = BOX (STANDARD)
 8 = T & R + CAP

PIN LENGTH A (1/10mm)
 PLEASE SPECIFY PIN LENGTH REQUIRED
 I.E. 2.5mm = 25
 STANDARD = 30
 TOL. ±0.25mm

PIN LENGTH B (1/10mm)
 PLEASE SPECIFY PIN LENGTH REQUIRED
 I.E. 2.5mm = 25
 STANDARD = 30
 TOL. ±0.25mm

HEIGHT "H"
 0 = 1.0MM
 A = 1.5MM
 B = 2.0MM
 C = 2.54MM

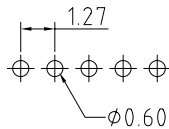

RECOMMENDED PCB LAYOUT
(TOLERANCE: ±0.05)

10	10/02/06	NJR	RELEASE
11	01/02/05	NYW	DRAWING MODIFICATION
12	23/08/05	NYW	AMEND INSULATOR WIDTH AND NO. OF CONTACTS
13	02/03/06	NYW	ADD INSULATOR OPTION W.
14	02/06/06	NYW	ADD INSULATOR HEIGHT.
15	08/08/06	NYW	DRAWING MODIFICATION
16	17/04/07	NYW	ADD INSULATOR HEIGHT E.
17	24/04/07	NYW	ADD PACK OPTION 8.
18	16/08/08	NYW	PLATING MODIFICATION CHANGE INSULATOR TO LCP.
19	05/01/09	NYW	REMOVE CE, CF FROM MATING PARTS.
20	03/12/09	NYW	CHANGE 10 INSULATOR TO NYLON 6T. DRAWING MODIFICATION REMOVE H=17 (D) OPTION.

Scale:	5:1
Drawn:	NJR
App'd:	XXXX
Date:	3 DEC '09

THIRD ANGLE	
Title	PIN HEADER
Revision:	2.0

Unstated Tolerances:	X ± 0.30 X ± 0.25 XX ± 0.15 XXX ± 0.10
Material	SEE NOTE
NOT TO SCALE	
Unit:	mm

Material	SEE NOTE
NOT TO SCALE	
Unit:	mm

www.gradconn.com

THIS DRAWING IS CONFIDENTIAL AND MUST NOT BE COPIED OR DISCLOSED WITHOUT WRITTEN CONSENT

Type:	BB02-NC
BB02-NC	
Drawing Number:	
Sheet 1	of 1
Drawing	E and O E