

BB02-JF :- 2.54mm ( 0.1") FEMALE HEADER PROFILE:7.1mm, SINGLE ROW 02 to 40 CONTACTS

**SPECIFICATIONS**

CURRENT RATING 3 AMP  
 CONTACT RESISTANCE 20MOHMS MAX  
 INSULATOR RESISTANCE 1000 MEGOHMS MIN.  
 DIELECTRIC WITHSTANDING AC 600 V  
 OPERATING TEMPERATURE -40°C TO +105°C  
 CONTACT MATERIAL PHOSPHER BRONZE  
 INSULATOR MATERIAL THERMOPLASTIC, UL 94V-0  
 NYLON 6T : STANDARD  
 PBT : SPECIAL OPTION  
 PLATING GOLD, TIN OR SELECTIVE OVER 30-50U" NICKEL  
 SOLDERABILITY: NYLON 6T - IR REFLOW: 260°C FOR 10 SEC  
 WAVE: 230°C FOR 5-10 SEC  
 MANUAL SOLDER: 350°C FOR 3-5 SEC

**NOTES:**

- 1. PACKED IN TRAY.  $\triangle$
- 2. RECOMMENDED MATING PIN LENGTH: 4.5MM.  $\triangle$

MATES WITH :- BB02-HA BB02-HY  
 BB02-HC BB02-TC  
 BB02-HD BB02-TJ  
 BB02-HG BB02-TK  
 BB02-HH BB02-TP

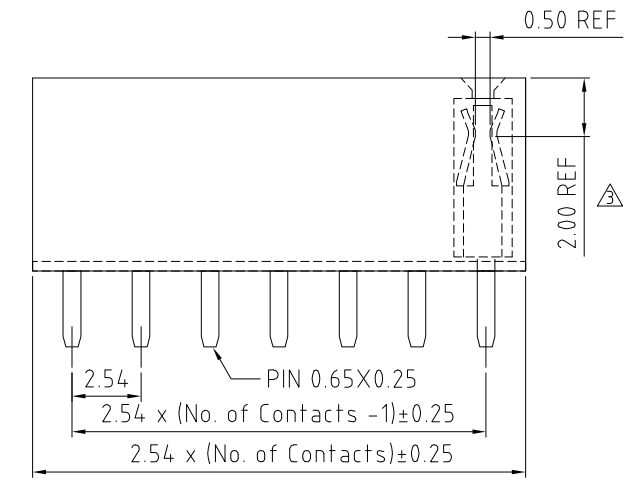
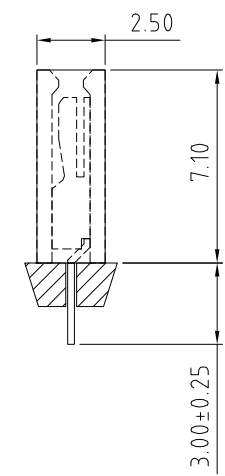
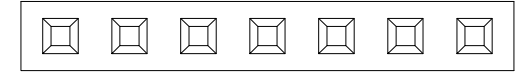

**HOW TO ORDER**

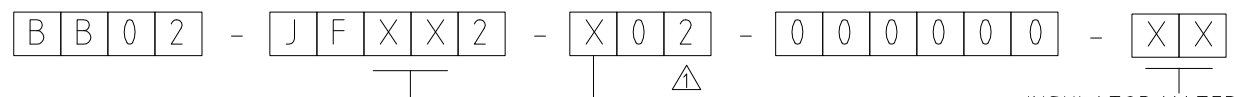

NO. OF CONTACTS:  $\triangle$  02 TO 40

CONTACT PLATING OPTIONS:  
 K = GOLD FLASH (STANDARD)  
 A = 10U" GOLD ON CONTACT/GOLD FLASH ON TAIL  
 B = 15U" GOLD ON CONTACT/GOLD FLASH ON TAIL  
 C = 30U" GOLD ON CONTACT/GOLD FLASH ON TAIL  
 T = BRIGHT TIN  
 M = MATT TIN  
 D = GOLD FLASH ON CONTACT/BRIGHT TIN ON TAIL  
 E = 10U" GOLD ON CONTACT/BRIGHT TIN ON TAIL  
 F = 15U" GOLD ON CONTACT/BRIGHT TIN ON TAIL  
 G = 30U" GOLD ON CONTACT/BRIGHT TIN ON TAIL

INSULATOR MATERIAL:  $\triangle$   
 6T = NYLON 6T (STANDARD)  
 BLANK = PBT (Not suitable for new designs.)

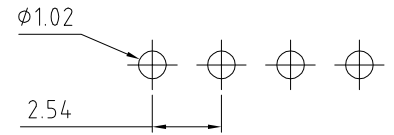

RECOMMENDED PC BOARD HOLE LAYOUT (TOLERANCE: ±0.05)

REV.	DATE & DRN
10	29/06/02 - SJT RELEASE
11	16/09/05 - NYW
$\triangle$	AMEND NO. OF CONTACTS.
$\triangle$	AMEND PLASTIC MATERIAL.
$\triangle$	AMEND PACKAGING.
12	17/08/06 - NYW
$\triangle$	ADD PLASTIC OPTION.
$\triangle$	DRAWING MODIFICATION.
13	05/09/06 - NYW
$\triangle$	ADD CONTACT POINT.
14	29/05/07 - NYW
$\triangle$	ADD NOTES 2.
15	27/05/08 - PN
$\triangle$	ADD MATT TIN PLATING.
16	17/02/09 - CHC
$\triangle$	DRAWING MODIFICATION.

Scale: 5:1	THIRD ANGLE	Unstated Tolerances: X = ± 0.30 .X = ± 0.25 .XX = ± 0.15 XXX = ± 0.10	Material SEE NOTE
Drawn: CHC			
App'd: XXXX	Title SOCKET		NOT TO SCALE
Date: 17 FEB '09	Revision: 1.6		Unit: mm

www.gradconn.com

THIS DRAWING IS CONFIDENTIAL AND MUST NOT BE COPIED OR DISCLOSED WITHOUT WRITTEN CONSENT

Type: BB02-JF
BB02-JF
Drawing Number:
Sheet 1 of 1
Drawing © E and O E