

BB02-HR :- 2.54mm X 2.54mm (0.1" X 0.1") SMT BOX HEADER, DUAL ROW, STRAIGHT, 06 TO 64 CONTACTS

SPECIFICATIONS :

CURRENT RATING 3 AMPS  
 INSULATOR RESISTANCE 1000 MEGOHMS MIN.  
 DIELECTRIC WITHSTANDING AC 600 V  
 OPERATING TEMPERATURE -40°C TO +105°C  
 CONTACT MATERIAL BRASS  
 INSULATOR MATERIAL THERMOPLASTIC, UL 94V-0  
 STANDARD NYLON-6T  
 PLATING TIN, GOLD OR SELECTIVE OVER 30~50U" NICKEL  
 SOLDERABILITY IR REFLOW: 260°C FOR 10 SEC  
 MANUAL SOLDER: 350°C FOR 3-5 SEC

MATES WITH: - BB02-KA BB02-KU  
 BB02-KD BB02-KW (perfect mate)  
 BB02-KH BB02-LD  
 BB02-KK  
 BB02-KT

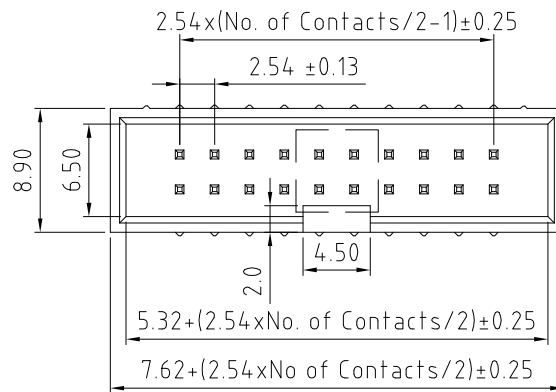

Pin #	Dim. D
06~10	6.0
12~64	8.5

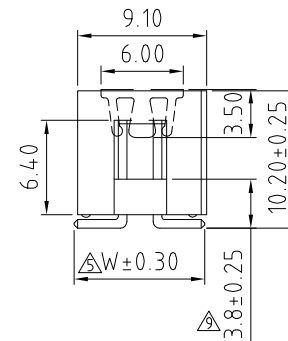
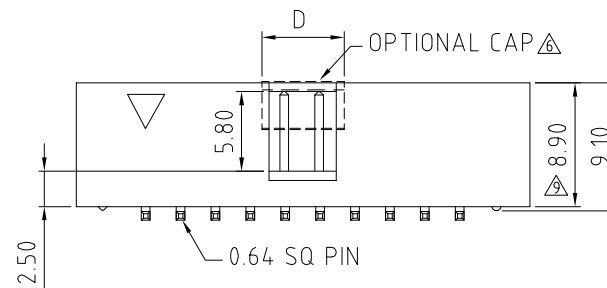

HOW TO ORDER

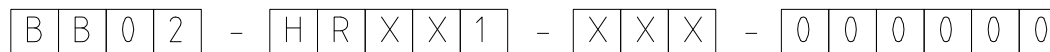

△ NO. OF CONTACTS:  
 06 TO 64  
 (SOME PIN# WOULD  
 REQUIRE HIGHER MOQ.)

CONTACT PLATING OPTIONS:  
 K = GOLD FLASH (STANDARD)  
 A = 10U" GOLD ON CONTACT/GOLD FLASH ON TAIL  
 B = 15U" GOLD ON CONTACT/GOLD FLASH ON TAIL  
 C = 30U" GOLD ON CONTACT/GOLD FLASH ON TAIL  
 T = BRIGHT TIN  
 M = MATT TIN  
 △ D = GOLD FLASH ON CONTACT/BRIGHT TIN ON TAIL  
 E = 10U" GOLD ON CONTACT/BRIGHT TIN ON TAIL  
 F = 15U" GOLD ON CONTACT/BRIGHT TIN ON TAIL  
 G = 30U" GOLD ON CONTACT/BRIGHT TIN ON TAIL

"W" OPTIONS: △  
 0 = 9.50  
 A = 11.18  
 B = 10.25  
 PACKAGING OPTIONS:  
 2 = TRAY  
 △ 5 = TRAY + CAP  
 6 = TAPE & REEL  
 △ 8 = TAPE & REEL + CAP

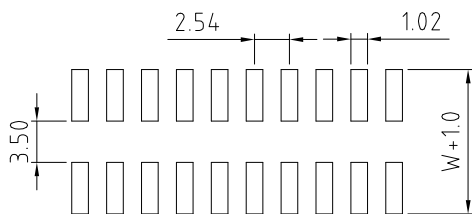

RECOMMENDED PC BOARD LAYOUT  
 (TOLERANCE: ±0.05)

REV. DATE & DRN	10. 19/09/03 - NJR - RELEASE
11. 16/07/07 - NJR - DIMENSIONS	11. 16/07/07 - NJR - DIMENSIONS
12. 15/08/06 - NYW - AMEND NO. OF CONTACTS	12. 15/08/06 - NYW - AMEND NO. OF CONTACTS
13. 12/01/07 - NYW - DRAWING MODIFICATION	13. 12/01/07 - NYW - DRAWING MODIFICATION
14. 16/07/07 - NYW - AMEND PIN#	14. 16/07/07 - NYW - AMEND PIN#
15. 31/01/08 - NYW - ADD W OPTIONS	15. 31/01/08 - NYW - ADD W OPTIONS
16. 10/07/08 - NYW - PLATING MODIFICATION	16. 10/07/08 - NYW - PLATING MODIFICATION
17. 17/07/08 - NYW - CHANGE TAPE & REEL & CAP TO CODE & I/MAS CODE 7L	17. 17/07/08 - NYW - CHANGE TAPE & REEL & CAP TO CODE & I/MAS CODE 7L
18. 13/02/09 - EHC - DRAWING MODIFICATION	18. 13/02/09 - EHC - DRAWING MODIFICATION
19. 10/11/09 - NYW - AMEND AND ADD DIMENSION	19. 10/11/09 - NYW - AMEND AND ADD DIMENSION
20. 07/03/16 - NYW - AMEND MATING P/N	20. 07/03/16 - NYW - AMEND MATING P/N
21. 27/07/16 - NYW - AMEND OPERATING TEMP.	21. 27/07/16 - NYW - AMEND OPERATING TEMP.
22. 17/04/17 - NYW - AMEND CAP DIMENSION	22. 17/04/17 - NYW - AMEND CAP DIMENSION
23. 15/09/17 - NYW - ADD B TO W OPTION	23. 15/09/17 - NYW - ADD B TO W OPTION
24. 15/10/18 - NYW - AMEND OPERATING TEMP.	24. 15/10/18 - NYW - AMEND OPERATING TEMP.

Scale: 2.5:1	THIRD ANGLE	Unstated Tolerances: X ± 0.30 X ± 0.25 XX ± 0.15 XXX ± 0.10	Material SEE NOTE
Drawn: NJR			
App'd: XXXX	Title BOX HEADER		NOT TO SCALE
Date: 15 OCT. '18	Revision: 2.4		Unit: mm

www.gradconn.com

Type: BB02-HR
BB02-HR
Drawing Number:
Sheet 1 of 1
Drawing © E and O E