

BB02-HE :- 2.54mm x 2.54mm (0.1" x 0.1") PIN HEADER, DUAL ROW, THROUGH HOLE, 04 to 80 CONTACTS, STRAIGHT OR RIGHT ANGLE

SPECIFICATIONS

CURRENT RATING 3 AMP
 INSULATOR RESISTANCE 1000 MEGOHMS MIN.
 DIELECTRIC WITHSTANDING AC 600 V
 OPERATING TEMPERATURE -40°C TO 105°C
 CONTACT MATERIAL BRASS
 INSULATOR MATERIAL POLYESTER UL 94V-0
 NYLON 6T : STANDARD
 PBT : SPECIAL OPTION
 PLATING GOLD, TIN OR SELECTIVE OVER 30-50U" NICKEL
 SOLDERABILITY: NYLON 6T - IR REFLOW: 260°C FOR 10 SEC
 WAVE: 230°C FOR 5-10 SEC
 MANUAL SOLDER: 350°C FOR 3-5 SEC
 PBT - MANUAL SOLDER: 330°C FOR 3-5 SEC
 (NOT SUITABLE FOR HI-TEMP PROCESS)

PACKED LOOSE IN BAG OR BOX.

MATES WITH :- BB02-JM BB02-KM BB02-LE
 BB02-KA BB02-KQ
 BB02-KD BB02-KS
 BB02-KF BB02-KT
 BB02-KG BB02-KU
 BB02-KH BB02-KW
 BB02-KK BB02-LD

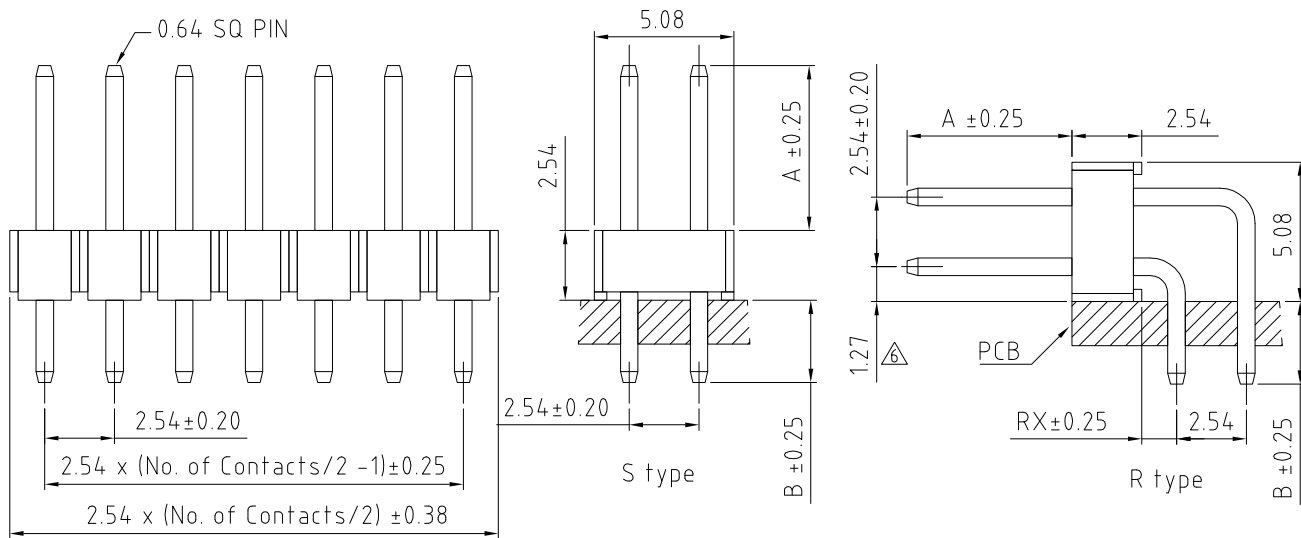

HOW TO ORDER

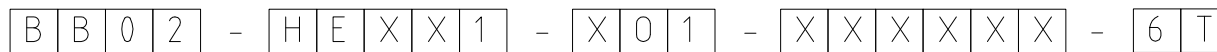

NO. OF CONTACTS
04 to 80

CONTACT PLATING OPTIONS:
 K = GOLD FLASH (STANDARD)
 A = 10U" GOLD ON CONTACT/GOLD FLASH ON TAIL
 B = 15U" GOLD ON CONTACT/GOLD FLASH ON TAIL
 C = 30U" GOLD ON CONTACT/GOLD FLASH ON TAIL
 T = BRIGHT TIN
 M = MATT TIN
 D = GOLD FLASH ON CONTACT/BRIGHT TIN ON TAIL
 E = 10U" GOLD ON CONTACT/BRIGHT TIN ON TAIL
 F = 15U" GOLD ON CONTACT/BRIGHT TIN ON TAIL
 G = 30U" GOLD ON CONTACT/BRIGHT TIN ON TAIL

PIN LENGTH A (1/10mm)
 PLEASE SPECIFY PIN LENGTH REQUIRED
 I.E. 2.5mm = 25
 STANDARD = 60

PIN LENGTH B (1/10mm)
 PLEASE SPECIFY PIN LENGTH REQUIRED
 I.E. 2.5mm = 25
 STANDARD = 30

INSULATOR MATERIAL Δ
 6T = NYLON 6T (STANDARD)
 BLANK = PBT (Not suitable for new designs.)

CONNECTOR TYPE
 S1 = STRAIGHT
 R1 = RIGHT ANGLE 1.5mm
 R2 = RIGHT ANGLE 2.0mm
 Δ R3 = RIGHT ANGLE 2.5mm

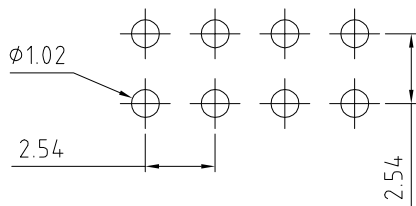

RECOMMENDED PC BOARD HOLE LAYOUT
(TOLERANCE: ±0.05)

REV	DATE & DRN
1.0	21/07/03 - SJT NEW
1.1	23/08/04 - CHC
1.2	25/07/05 - NYW
1.3	27/04/06 - NYW
1.4	14/08/06 - NYW
1.5	18/07/08 - NYW
1.6	05/08/08 - NYW
1.7	06/02/09 - CHC
1.8	27/07/16 - NYW
1.9	15/10/18 - NYW

ADD DIM. TOLERANCE.
ADD PLASTIC OPTION.
DRAWING MODIFICATION.
PLATING MODIFICATION.
ADD DISPOSITION.
DRAWING MODIFICATION.
APPEND OPERATING TEMP.
APPEND OPERATING TEMP.

Scale:	5:1
Drawn:	SJT
App'd:	XXX
Date:	15 OCT. '18

THIRD ANGLE	
Title	PIN HEADER
Revision:	1.9

Unstated Tolerances:
X ±0.30
X ±0.25
XX ±0.15
XXX ±0.10

Material	SEE NOTE
	NOT TO SCALE
Unit	mm

Type:	BB02-HE
	BB02-HE
Drawing Number:	
Sheet 1	of 1
Drawing	E and O E