

BB02-HA :- 2.54mm (0.1") PIN HEADER, SINGLE ROW, THROUGH HOLE 02 TO 40 CONTACTS

SPECIFICATIONS

CURRENT RATING 3 AMP
 INSULATOR RESISTANCE 1000 MEGOHMS MIN.
 DIELECTRIC WITHSTANDING AC 600 V
 OPERATING TEMPERATURE -40°C TO 105°C
 CONTACT MATERIAL BRASS
 INSULATOR MATERIAL THERMOPLASTIC, UL 94V-0
 NYLON 6T : STANDARD
 PBT : SPECIAL OPTION
 PLATING GOLD, TIN OR SELECTIVE OVER 30-50U" NICKEL
 SOLDERABILITY: NYLON 6T - IR REFLOW: 260°C FOR 10 SEC
 WAVE: 230°C FOR 5-10 SEC
 MANUAL SOLDER: 350°C FOR 3-5 SEC
 PBT - MANUAL SOLDER: 330°C FOR 3-5 SEC
 (NOT SUITABLE FOR HI-TEMP PROCESS)

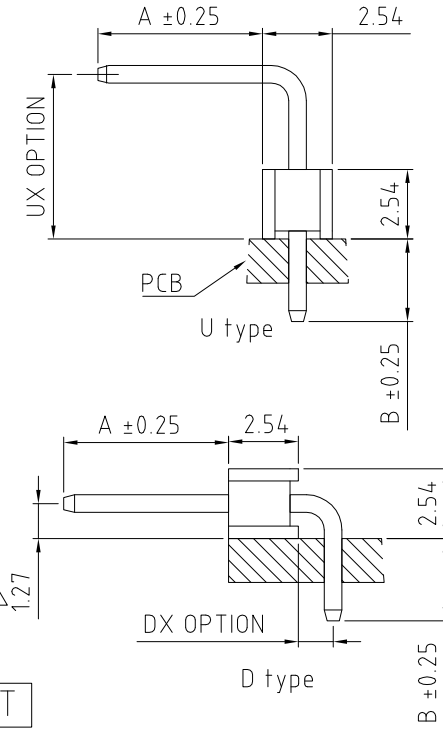
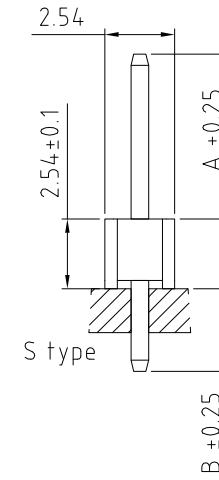
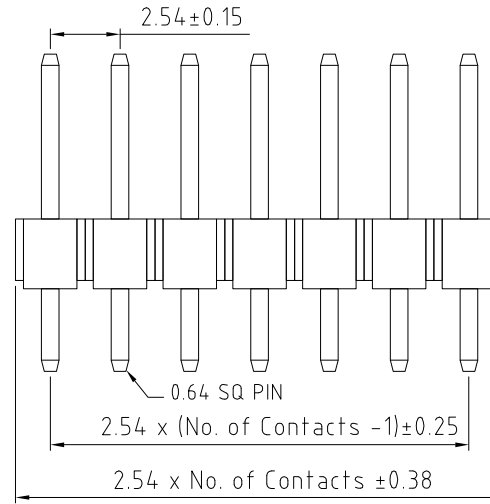

PACKED LOOSE IN BAG OR BOX.

- MATES WITH :-
- BB02-JB BB02-JL
 - BB02-JC BB02-JR
 - BB02-JD BB02-JS
 - BB02-JE BB02-JT
 - BB02-JF BB02-JU
 - BB02-JG BB02-KR
 - BB02-JJ

HOW TO ORDER

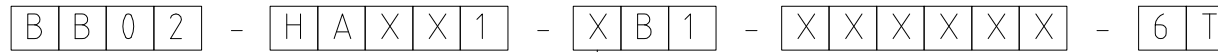

NO. OF CONTACTS:
02 TO 40

CONTACT PLATING OPTIONS:
 K = GOLD FLASH (STANDARD)
 A = 10U" GOLD ON CONTACT/GOLD FLASH ON TAIL
 B = 15U" GOLD ON CONTACT/GOLD FLASH ON TAIL
 C = 30U" GOLD ON CONTACT/GOLD FLASH ON TAIL
 T = BRIGHT TIN
 M = MATT TIN
 D = GOLD FLASH ON CONTACT/BRIGHT TIN ON TAIL
 E = 10U" GOLD ON CONTACT/BRIGHT TIN ON TAIL
 F = 15U" GOLD ON CONTACT/BRIGHT TIN ON TAIL
 G = 30U" GOLD ON CONTACT/BRIGHT TIN ON TAIL

PIN LENGTH A (1/10mm)
 PLEASE SPECIFY PIN LENGTH REQUIRED
 I.E. 2.5mm = 25
 STANDARD = 60

PIN LENGTH B (1/10mm)
 PLEASE SPECIFY PIN LENGTH REQUIRED
 I.E. 2.5mm = 25
 STANDARD = 30

CONNECTOR TYPE:
 S0 = STRAIGHT
 U1 = UP ANGLE 4.8mm
 U2 = UP ANGLE 6.0mm
 U3 = UP ANGLE 6.6mm
 U4 = UP ANGLE 2.86mm
 U5 = UP ANGLE 3.3mm △
 U6 = UP ANGLE 8.5mm △
 D1 = DOWN ANGLE 1.5mm
 D2 = DOWN ANGLE 2.0mm
 D3 = DOWN ANGLE 0.32mm
 D4 = DOWN ANGLE 1.0mm △
 D5 = DOWN ANGLE 0.68mm △

INSULATOR MATERIAL △
 6T = NYLON 6T (STANDARD)
 BLANK = PBT (Not suitable for new designs.)

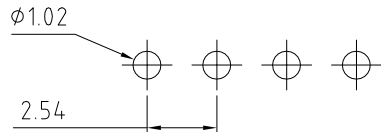

RECOMMENDED PCB HOLE LAYOUT
(TOLERANCE: ±0.05)

REV.	DATE & DRN
10	29/06/02 - SJT - NEW
11	03/07/04 - NJR
12	23/08/04 - NYW
13	25/01/05 - NYW
14	14/08/06 - NYW
15	25/02/08 - NYW
16	29/08/08 - NYW
17	06/02/09 - CHC
18	19/06/09 - NYW
19	11/09/13 - NYW
20	27/01/16 - NYW
21	12/10/18 - NYW

Scale:	5:1
Drawn:	SJT
App'd:	XXXX
Date:	12 OCT. '18

THIRD ANGLE	
Title	PIN HEADER
Revision:	2.1

Unstated Tolerances:	X ± 0.30
	.X ± 0.25
	.XX ± 0.15
	.XXX ± 0.10

Material	SEE NOTE
NOT TO SCALE	
Unit:	mm

Type:	BB02-HA
Drawing Number:	BB02-HA
Sheet 1	of 1
Drawing	E and OE