

BB02-CR :- 1.27mm X 1.27mm (0.05" X 0.05") SMD SOCKET, DUAL ROW, STRAIGHT, 6 TO 100 CONTACTS, DUAL ENTRY

SPECIFICATIONS

CURRENT RATING 1 AMP
 INSULATOR RESISTANCE 1000 MEGOHMS MIN.
 CONTACTS RESISTANCE 20m OHMS MAX.
 DIELECTRIC WITHSTANDING AC 300 V
 OPERATING TEMPERATURE -40°C TO +105°C
 CONTACT MATERIAL PHOSPHOR BRONZE
 INSULATOR MATERIAL THERMOPLASTIC, UL 94V-0
 STANDARD: LCP+30% G/F Δ

PLATING GOLD OR TIN OVER MIN. 30U" NICKEL
 SOLDERABILITY: IR REFLOW: 280°C FOR 10 SEC
 MANUAL SOLDER: 380°C FOR 3-5 SEC

NOTES:

1. RECOMMENDED MATING PIN LENGTH FROM TOP ENTRY IS 3.0MM Δ

MATES WITH:- BB02-BC BB02-BS
 BB02-BD BB02-NE
 BB02-BK
 BB02-BP

Film Width	
No. of Pins	Size
06 - 50	5mm
52 - 100	10mm

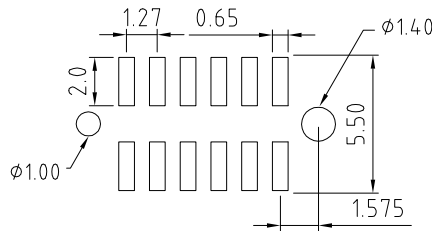
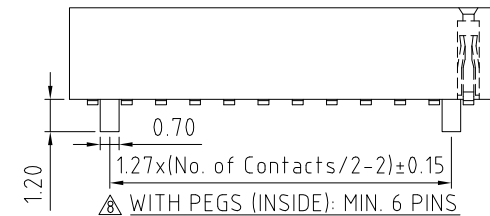
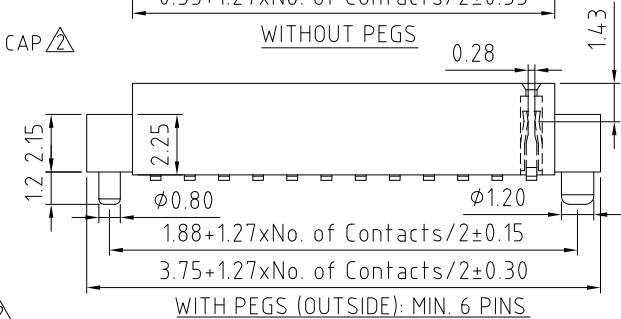
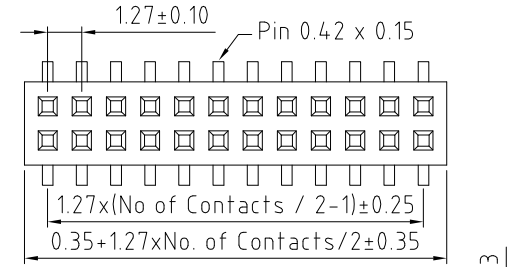
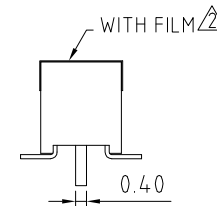
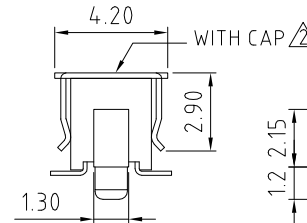
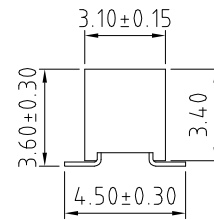

TOP ENTRY WITH PEGS (OUTSIDE)

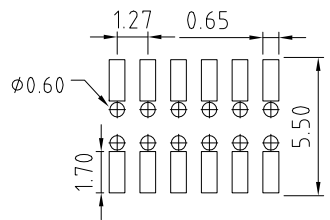

BOTTOM ENTRY WITHOUT PEGS

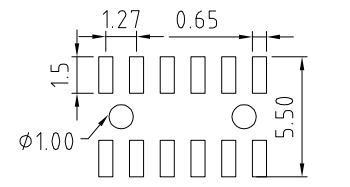

TOP ENTRY WITH PEGS (INSIDE)

RECOMMENDED PCB LAYOUT (TOLERANCE: ±0.05)

HOW TO ORDER



NO. OF CONTACTS :
 06 TO 98
 00 = 100

CONTACT PLATING OPTIONS :
 K = GOLD FLASH (STANDARD)
 A = 10U" GOLD ON CONTACT/GOLD FLASH ON TAIL
 B = 15U" GOLD ON CONTACT/GOLD FLASH ON TAIL
 C = 30U" GOLD ON CONTACT/GOLD FLASH ON TAIL
 T = BRIGHT TIN
 M = MATT TIN

PACKING OPTIONS :
 3 = TUBE
 4 = TUBE + FILM
 5 = TUBE + CAP
 6 = TAPE & REEL
 7 = TAPE & REEL+FILM
 8 = TAPE & REEL+CAP

LOCATING PEGS OPTIONS : Δ
 A = WITH PEGS (OUTSIDE)
 Δ E = WITH PEGS (INSIDE)
 0 = WITHOUT PEGS

10	13/06/05 - NYW RELEASE
11	21/07/05 - NYW
Δ	ADD LOCATING PEG OPTION.
Δ	AMEND PCB LAYOUT.
12	06/11/05 - NYW
Δ	ADD FILM & CAP
13	20/07/06 - NYW
Δ	DRAWING MODIFICATION
14	05/06/07 - CHC
Δ	ADD NOTES 1.
Δ	ADD BOTTOM ENTRY LAYOUT.
15	16/10/07 - CHC
Δ	REMOVE SELECTIVE GOLD
Δ	REMOVE SELECTIVE GOLD
16	27/05/08 - CHC
Δ	ADD PLATING MODIFICATION
17	07/08/08 - CHC
Δ	DRAWING MODIFICATION
18	23/08/11 - NYW
Δ	ADD WITH PEGS OPTION.
19	03/09/11 - NYW
Δ	AMEND NICKEL THICKNESS.
20	03/09/11 - NYW
Δ	CHANGE INSULATOR TO LCP.
21	08/07/13 - NYW
Δ	AMEND INSULATOR TOL.
22	07/03/14 - NYW
Δ	AMEND MATING P/N.
23	23/10/14 - NYW
Δ	AMEND INSULATOR AND PROFILE TOLERANCE.

Scale:	5:1	THIRD ANGLE	Unstated Tolerances: X: ±0.30 X: ±0.25 XX: ±0.15 XXX: ±0.10	Material	SEE NOTE
Drawn:	CHC				
App'd:	XXXX	Title	SOCKET		NOT TO SCALE
Date:	23 OCT. '14	Revision:	2.3		UNIT: mm

www.gradconn.com

THIS DRAWING IS CONFIDENTIAL AND MUST NOT BE COPIED OR DISCLOSED WITHOUT WRITTEN CONSENT

Type:	BB02-CR
DRAWING NUMBER:	BB02-CR
Sheet	1 of 1
Drawing	E and O E