

BB02-CP :- 1.27mm (0.05") STRAIGHT SMD FEMALE HEADER, SINGLE ROW - 2 TO 40 CONTACTS, DUAL ENTRY

SPECIFICATIONS

CURRENT RATING	1 AMP
INSULATOR RESISTANCE	1000 MEGOHMS MIN.
DIELECTRIC WITHSTANDING	300 V AC/DC
CONTACT RESISTANCE	20m OHMS MAX.
OPERATING TEMPERATURE	-40°C TO +105°C
CONTACT MATERIAL	PHOSPHOR BRONZE
INSULATOR MATERIAL	THERMOPLASTIC, UL 94V-0
PLATING	GOLD, TIN OR SELECTIVE OVER 30~50U" NICKEL
SOLDERABILITY	IR REFLOW: 280°C FOR 10 SEC MANUAL SOLDER: 380°C FOR 3-5 SEC

NOTES:

1. RECOMMENDED MATING PIN LENGTH FOR TOP ENTRY: 3.5MM. \triangle
2. PARTS WITH SMALL NUMBER OF CONTACTS MAY BE PACKED IN BOX INSTEAD OF TUBE.

MATES WITH: - (0.40 SQUARE PINS)
 BB02-NA BB02-NS
 BB02-NB BB02-5B
 BB02-NC

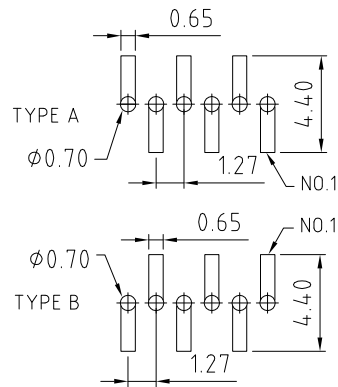
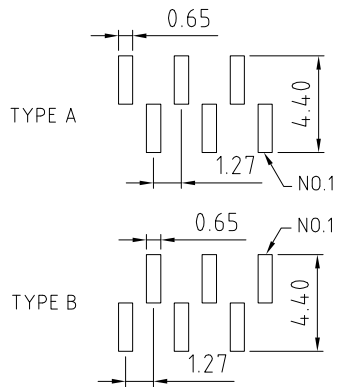
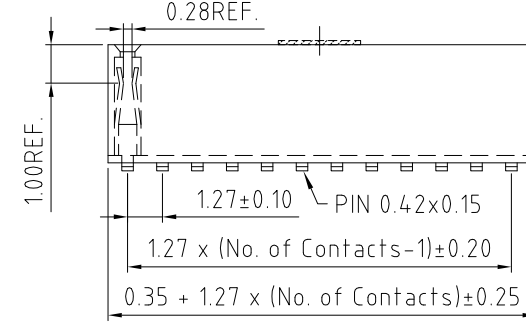
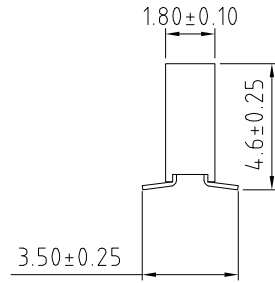
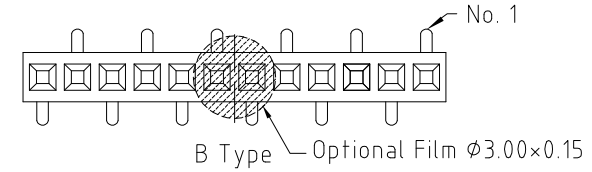
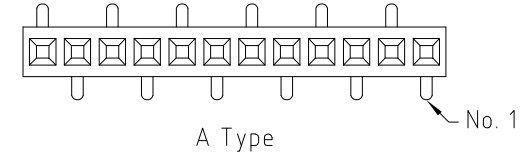

RECOMMENDED PCB LAYOUT FOR TOP ENTRY (TOLERANCE: ±0.05)

RECOMMENDED PCB LAYOUT FOR BOTTOM ENTRY (TOLERANCE: ±0.05)

HOW TO ORDER

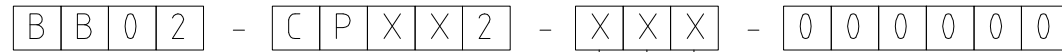

NO. OF CONTACTS:
02 TO 40

CONTACT PLATING OPTIONS:
 K = GOLD FLASH (STANDARD)
 A = 10U" GOLD ON CONTACT/GOLD FLASH ON TAIL
 B = 15U" GOLD ON CONTACT/GOLD FLASH ON TAIL
 C = 30U" GOLD ON CONTACT/GOLD FLASH ON TAIL
 T = BRIGHT TIN
 M = MATT TIN
 D = GOLD FLASH ON CONTACT/BRIGHT TIN ON TAIL

FOOTPRINT TYPE:
 A = A TYPE
 B = B TYPE

PACKAGING OPTIONS: \triangle
 3 = TUBE
 4 = TUBE + FILM
 6 = TAPE & REEL
 7 = TAPE & REEL + FILM
 (See Note 2.)

REV. DATE & DRN	10. 09/07/05 - NYW RELEASE
11. 17/07/06 - NYW	REWORK PACK OPTION
12. 28/07/06 - NYW	REVISED LAYOUT, ADD FEEL, DRAWING MODIFICATION
13. 05/06/07 - CHC	ADD NOTES 1.
14. 11/17/07 - NYW	ADD BOTTOM ENTRY LAYOUT, REMOVE PLATING OPTION E, F, G.
15. 05/05/08 - CHC	AMEND MATES WITH.
16. 26/12/08 - CHC	DRAWING MODIFICATION
17. 22/12/09 - NYW	AMEND MATING PART.
18. 28/09/10 - NYW	CHANGE INSULATOR TO LCP.
19. 26/17/10 - NYW	REMOVE PLATING OPTIONS E-G, ADD NOTE 2.
20. 23/10/14 - NYW	AMEND PROFILE AND FOOTPRINT TOLERANCE.
21. 14/06/16 - NYW	AMEND FILM TYPE.

Scale: 5:1	THIRD ANGLE	Unstated Tolerances: X. ± 0.30 X ± 0.25 XX ± 0.15 XXX ± 0.10	Material SEE NOTE
Drawn: CHC			
App'd: XXXX	Title SOCKET		NOT TO SCALE
Date: 14 JUN. '16	Revision: 2.1		UNIT: mm

www.gradconn.com

THIS DRAWING IS CONFIDENTIAL AND MUST NOT BE COPIED OR DISCLOSED WITHOUT WRITTEN CONSENT

Type: BB02-CP
BB02-CP
Drawing Number:
Sheet 1 of 1
Drawing © E and OE