

CH03-BG - SIM CARD HOLDER 6 OR 8 PINS

FEATURES

1. GENERAL CHARACTERISTICS
 DIMENSIONS: 29.70L x 17.20W x 2.20H mm
 WEIGHT: APPROX. 0.80g
 CONTACT PRINCIPLE: FRICTION TECHNOLOGY
 OPERATING POSITION: SHAFT UP / DOWN / HORIZONTAL
 MOUNTING SYSTEM: SMT TYPE
 DURABILITY: 10,000 CYCLES MIN.

2. MECHANICAL CHARACTERISTICS
 INSULATION MATERIAL: THERMOPLASTIC, UL 94V-0

3. ELECTRICAL CHARACTERISTICS
 NUMBER OF CONTACTS (OPTIONAL): 6, 8 PINS
 CONTACT RESISTANCE: 50M OHMS TYP. 100M OHMS MAX.
 INSULATION RESISTANCE: > 1000M OHMS / 500V DC

4. SOLDERABILITY
 WAVE: NOT APPLICABLE
 VAPORPHASE: 215°C, 30 SEC. MAX.
 IR REFLOW: 260°C, 10 SEC. MAX.
 MANUAL SOLDERING: 360°C, 3 SEC. MAX.

5. ENVIRONMENTAL CHARACTERISTICS
 OPERATING TEMPERATURE: -40°C ~ +85°C
 OPERATING HUMIDITY: 10% ~ 95% RH
 STORAGE TEMPERATURE: -40°C ~ +85°C
 STORAGE HUMIDITY: 10% ~ 95% RH
 THERMAL SHOCK -40°C ~ +85°C, 5 CYCLES
 DAMP HEAT: 40°C, 90% RH, 500 HR
 SALT MIST: 35°C, 5%, NaCl, 48 HR

NOTES:
 1. ACCEPTABLE SIM CARD SIZE SHOULD MEET GSM 11.11 SPECIFICATION REQUIREMENT.

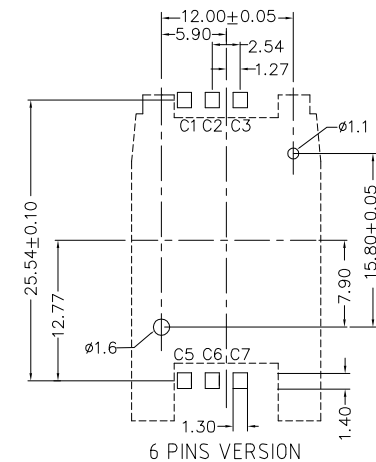
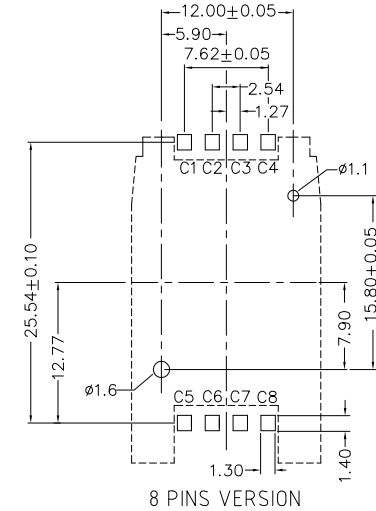
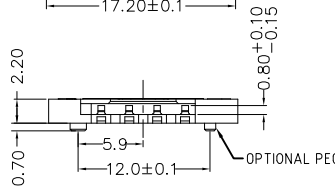
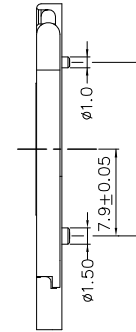
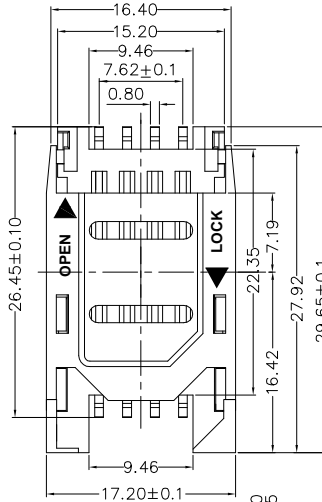
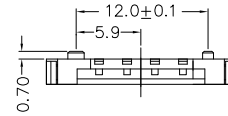
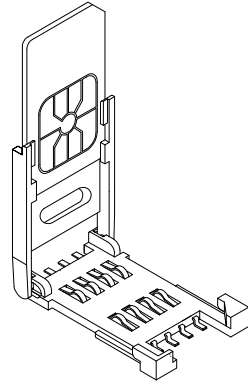

HOW TO ORDER

CH03

BGX X0

0XR

NO. OF CONTACTS
06 OR 08

WITH OR WITHOUT
LOCATING PEG
A = WITH
B = WITHOUT

PACKAGING OPTIONS
R = REEL
(600PCS/REEL)

RECOMMENDED PCB LAYOUT

REV.	DATE & DRN
10	07/07/06 - NYW RELEASE
11	28/07/05 - NYW
12	29/05/07 - NYW
13	28/09/07 - NYW
14	20/07/07 - NYW
15	28/04/09 - PN

16	AMEND PACK OPTION
17	ADD NOTES 1
18	REMOVE PACK OPTION TUBE
19	ADD SEPARATE PCB LAYOUT
20	PACKAGING DRAWING ADDED

Scale:	2:1	THIRD ANGLE	Unstated Tolerances: 0 Dec Places 1 Dec Places 2 Dec Places 3 Dec Places	Material SEE NOTE
Drawn:	NYW			
App'd:	XXXX	Title	SIM CARD ACCEPTOR	NOT TO SCALE
Date:	28 APR '09	Revision:	15	Unit: mm

www.gradconn.com

THIS DRAWING IS CONFIDENTIAL AND MUST NOT BE COPIED OR DISCLOSED WITHOUT WRITTEN CONSENT

Type:	CH03-BG
CH03-BG	
Drawing Number:	
Sheet 1	of 2
Drawing C	E and O E

CH03-BG - SIM CARD HOLDER 6 OR 8 PINS - PACKAGING DRAWING

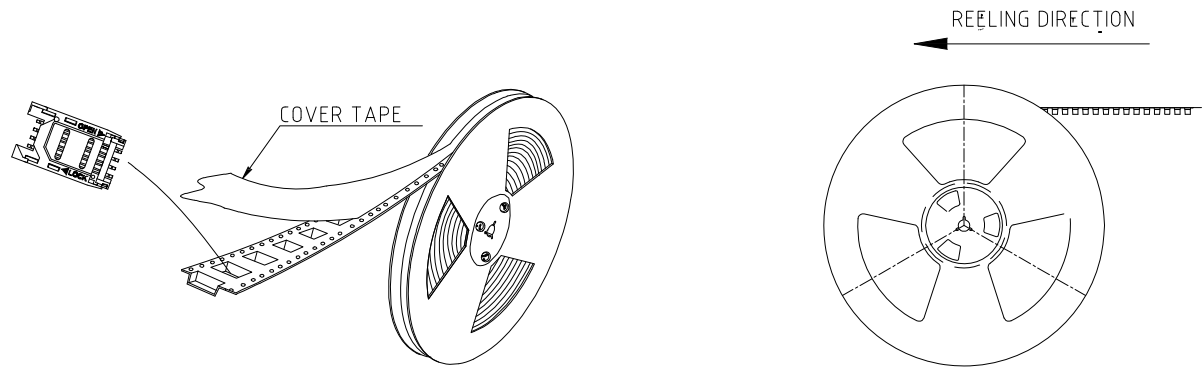
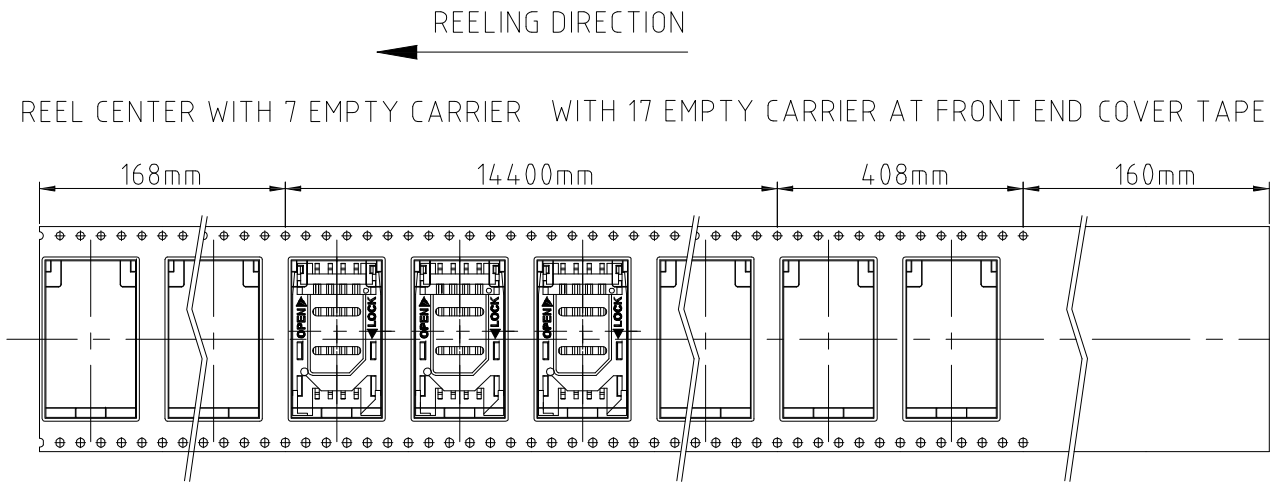
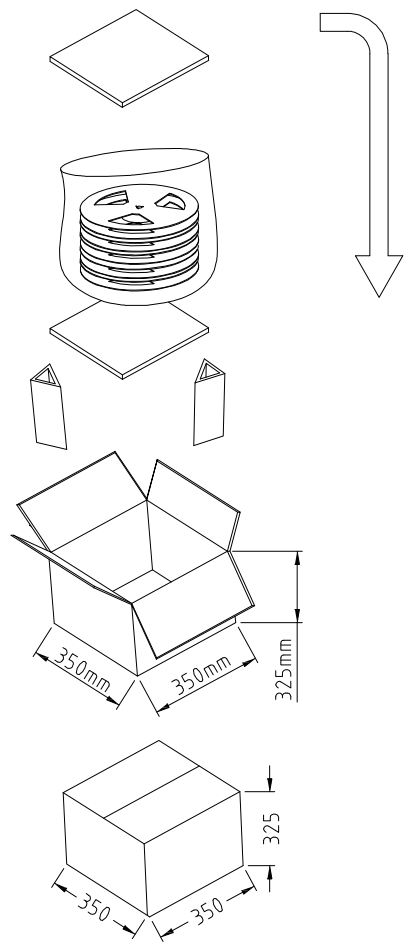

- NOTES:
1. REEL DIA.: 33CM.
 2. 600PCS PER REEL, GROSS WEIGHT: 1.06KG.
 3. 6 REELS PER FULL CARTON, GROSS WEIGHT: 7.56KG.

REV. DATE & DRN 10/28/07/09 - AE PACKAGING DRAWING ADDED	Scale: NTS	THIRD ANGLE	Unstated Tolerances:	Material SEE NOTE
	Drawn: AE			
	App'd: XXXX	Title SIM CARD ACCEPTOR		NOT TO SCALE
	Date: 28 APR '09	Revision: 1.0		Unit: mm

 www.gradconn.com		Type: CH03-BK
		CH03-BG
THIS DRAWING IS CONFIDENTIAL AND MUST NOT BE COPIED OR DISCLOSED WITHOUT WRITTEN CONSENT		Drawing Number:
		Sheet 2 of 2
		Drawing C <input type="radio"/> E and O E

 www.gradconn.com		Type: CH03-BK
		CH03-BG
THIS DRAWING IS CONFIDENTIAL AND MUST NOT BE COPIED OR DISCLOSED WITHOUT WRITTEN CONSENT		Drawing Number:
		Sheet 2 of 2
		Drawing C <input type="radio"/> E and O E