

BB02-AZ:- 0.8x1.2MM SOCKET, DUAL ROW, STRAIGHT, SMT TYPE, 06 TO 100 CONTACTS, DUAL ENTRY

SPECIFICATIONS

CURRENT RATING: 0.5AMP
 INSULATOR RESISTANCE: 1000 MEGOHMS MIN.
 DIELECTRIC WITHSTANDING: AC 300 V
 CONTACT RESISTANCE: 20m OHMS MAX.
 OPERATING TEMPERATURE: -40°C TO +105°C
 CONTACT MATERIAL: PHOSPHOR BRONZE
 INSULATOR MATERIAL: THERMOPLASTIC, UL 94V-0
 STANDARD: LCP
 PLATING: GOLD, TIN OR SELECTIVE FLASH OVER 30-50U" NICKEL
 SOLDERABILITY IR REFLOW: 280°C FOR 10 SEC
 MANUAL SOLDER: 380°C FOR 3-5 SEC

MATES WITH: - BB02-AY BB02-AW

NOTES:

1. RECOMMENDED MATING PIN LENGTH FOR TOP ENTRY: 2.0MM.
2. PARTS WITH SMALLER PIN NUMBERS MAY BE PACKED LOOSE IN BOX INSTEAD OF TUBE.

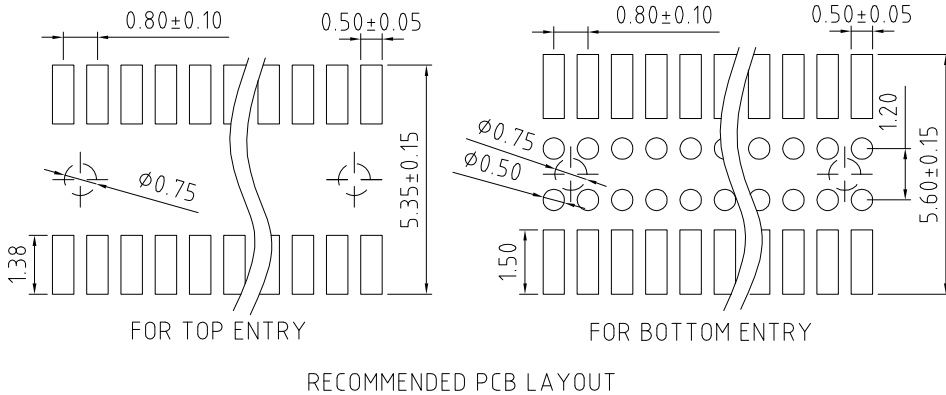
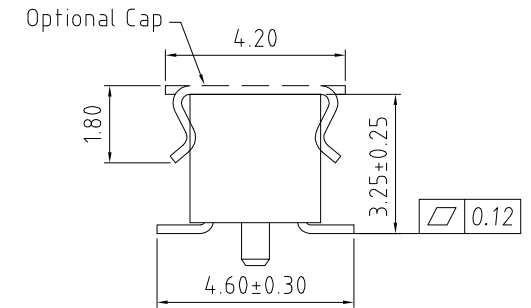
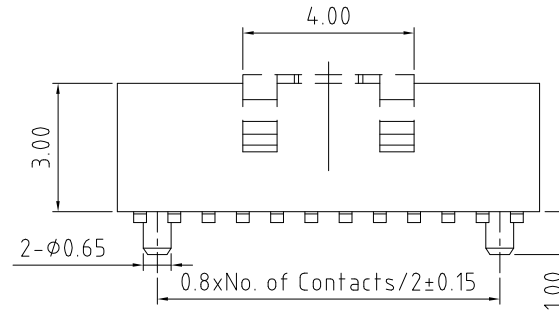
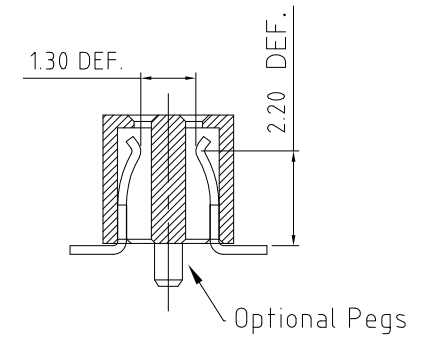
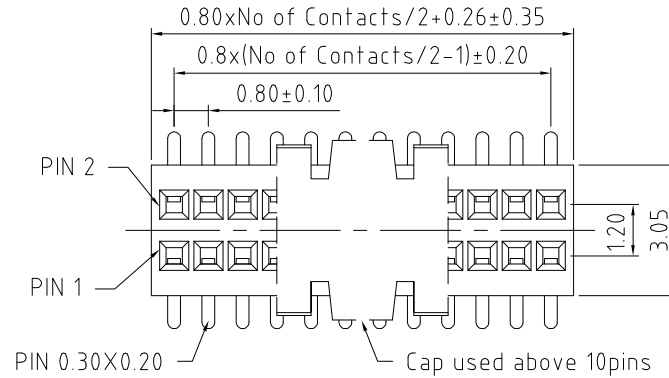

HOW TO ORDER

BB02 - AZXX2 - X0X - X00000

NO. OF CONTACTS:
 06 to 98
 00 = 100

CONTACT PLATING OPTIONS:
 K = GOLD FLASH (STANDARD)
 T = BRIGHT TIN
 M = MATT TIN
 D = GOLD FLASH ON CONTACT/BRIGHT TIN ON TAIL

PACKAGING OPTIONS:
 3 = TUBE
 5 = TUBE + CAP
 6 = TAPE & REEL
 8 = TAPE & REEL + CAP
 (see Note 2)

LOCATING PEGS OPTIONS:
 A = WITH PEGS
 B = WITHOUT PEGS

REV. DATE & DRN
 10. 08/08/08-NYW RELEASE
 11. 13/03/14 - NYW
 12. 17/11/15 - NYW
 ADD LOCATING PEGS OPTIONS

Scale: 8:1	THIRD ANGLE	Unstated Tolerances: X ± 0.25 XX ± 0.15 XXX ± 0.10	Material SEE NOTE
Drawn: NYW		Title: SOCKET	NOT TO SCALE
App'd: XXX	Revision: 12	Unit: mm	

www.gradconn.com

THIS DRAWING IS CONFIDENTIAL AND MUST NOT BE COPIED OR DISCLOSED WITHOUT WRITTEN CONSENT

Type BB02-AZ
BB02-AZ
Drawing Number:
Sheet 1 of 1
Drawing © E and OE