

BB02-VA: 5.08mm (0.2") HEADER, STRAIGHT, THROUGH HOLE, SINGLE ROW - 02 to 20 CONTACTS

SPECIFICATIONS

CURRENT RATING 7.9 AMP  
 INSULATOR RESISTANCE 5000 MEGOHMS MIN.  
 CONTACT RESISTANCE 20m ohms MAX.  
 DIELECTRIC WITHSTANDING 1500V AC/DC  
 OPERATING TEMPREATURE -55°C TO +125°C  
 CONTACT MATERIAL BRASS  
 INSULATOR MATERIAL LCP, UL 94V-0  
 PLATING: MATTE TIN OVER 30-50U" NICKEL  
 SOLDERABILITY IR REFLOW: 280°C FOR 10 SEC  
 WAVE: 250°C FOR 5-10 SEC  
 MANUAL SOLDER: 380°C FOR 3-5 SEC

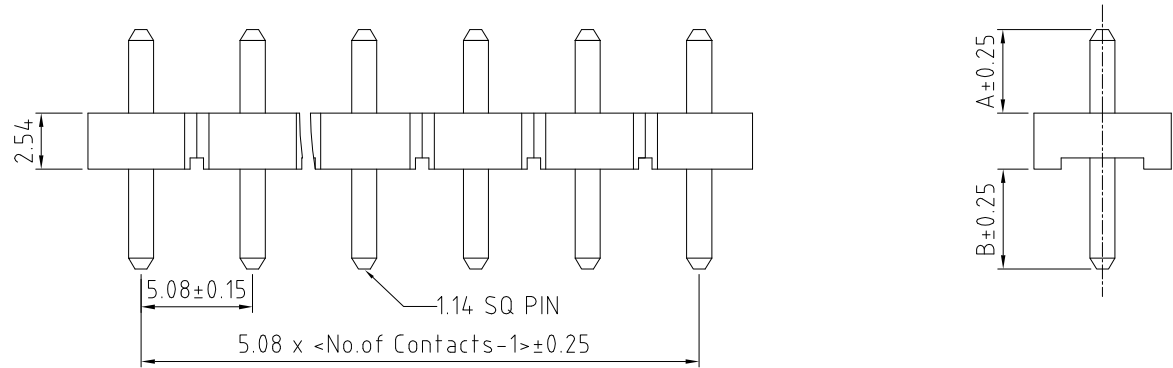

PACKAGE: BULK.

MATES WITH: - BB02-VM  
 BB02-VN

NOTES:

1. GOLD FLASH PLATING IS AVAILABLE UPON REQUEST, PLEASE CONTACT US FOR MORE INFORMATION.

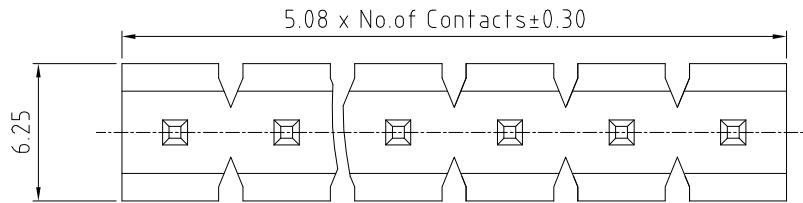

HOW TO ORDER

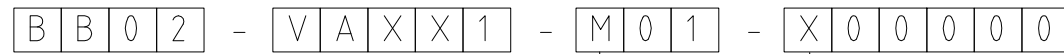

NO. OF CONTACTS  
02 TO 20

CONTACT PLATING OPTIONS  
M = MATT TIN (STANDARD)

Pin length options:

CODE	A (mm)	B (mm)	CODE	A (mm)	B (mm)
A	3.80	4.55	K	26.5	3.00
B	15.00	2.00	L	16.1	3.00
C	10.80	3.40			
D	13.00	10.64			
E	6.60	3.56			
F	20.83	2.82			
G	13.20	4.55			
H	15.05	13.91			
I	22.00	3.00			
J	12.46	3.00			

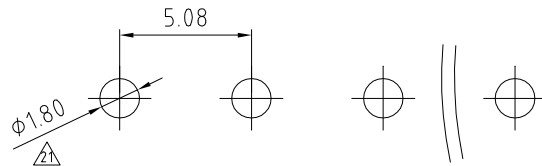

RECOMMENDED PC BOARD LAYOUT  
 (Tolerance: ±0.05mm)

REV. DATE & DRN

10. 02/05/07 - NYW RELEASE

11. 05/12/07 - NYW

12. 05/05/08 - NYW

13. 12/06/08 - CHC

14. 24/10/08 - CRC

15. 25/12/08 - NYW

16. 06/03/09 - NYW

17. 23/03/09 - NYW

18. 09/09/09 - CHC

19. 23/02/10 - CHC

20. 10/03/10 - NYW

21. 21/05/10 - CHC

22. 03/04/12 - NYW

ADD PIN LENGTH B

REMOVE PLATING OPTIONS: A, B, C, I, E, F, G

ADD PIN LENGTH C

REMOVE PLATING OPTIONS: K, D

ADD PIN LENGTH D

ADD PIN LENGTH E

DRAWING MODIFICATION

ADD NOTES 1

ADD PIN LENGTH F

ADD PIN LENGTH G

ADD PIN LENGTH H, I, J, K

AMEND RECOMMENDED Pcb HOLE

ADD PIN LENGTH L OPTION

Scale: 4:1

Drawn: CHC

App'd: XXXX

Date: 3 APR '12

THIRD ANGLE

Title: HEADER

Revision: 2.2

Unstated Tolerances:  
 X ± 0.30  
 X ± 0.25  
 XX ± 0.15  
 .XXX ± 0.10

Material: SEE NOTE

NOT TO SCALE

Unit: mm

Type: BB02-VA

BB02-VA

Drawing Number:

Sheet 1 of 1

Drawing © E and O E