

BB02-US: 3.96mm (0.156") SOCKET, STRAIGHT, THROUGH HOLE, SINGLE ROW - 02 to 24 CONTACTS

SPECIFICATIONS

CURRENT RATING 7.9 AMP
 INSULATOR RESISTANCE 5000 MEGOHMS MIN.
 CONTACT RESISTANCE 30m OHMS MAX.
 DIELECTRIC WITHSTANDING 1500V AC/DC
 OPERATING TEMPREATURE -55°C TO +105°C
 CONTACT MATERIAL PHOSPHOR BRONZE
 INSULATOR MATERIAL LCP, UL 94V-0 OR OTHER HIGH LEVEL PLASTIC
 PLATING: 100U" MATTE TIN OVER 30-50U" NICKEL
 SOLDERABILITY IR REFLOW: 280°C FOR 10 SEC
 WAVE: 250°C FOR 5-10 SEC
 MANUAL SOLDER: 380°C FOR 3-5 SEC

MATES WITH: - BB02-UG
 BB02-UH
 BB02-UJ

NOTES:

1. GOLD FLASH PLATING IS AVAILABLE UPON REQUEST, PLEASE CONTACT US FOR MORE INFORMATION.
2. RECOMMENDED MATING PIN LENGTH: 5.0MM.

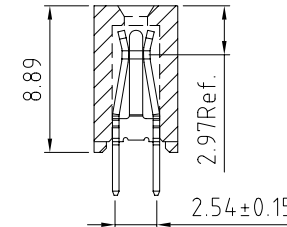
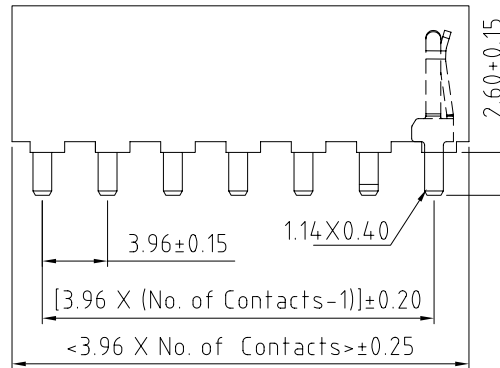
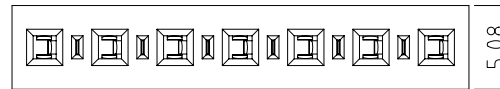

HOW TO ORDER



NO. OF CONTACTS
02 TO 24

CONTACT PLATING OPTIONS
M = MATTE TIN (STANDARD)

PACKAGE OPTIONS
3 = TUBE / BOX
5 = TUBE + CAP
6 = T & R
8 = T & R + CAP

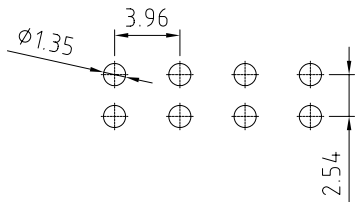

(TOLERANCE: ±0.05)
RECOMMENDED PC BOARD LAYOUT

REV. DATE & DRN	10. 3/17/08 - CHC RELEASE
11. 25/07/08 - NYW DRAWING MODIFICATION	
12. 05/03/09 - NYW REMOVE OTHER PLATING AND ADD NOTES 1	
13. 25/07/10 - NYW ADD CONTACT DETAIL. ADD NOTES 2.	

Scale: 3:1	THIRD ANGLE	Unstated Tolerances: X ± 0.30 X ± 0.25 XX ± 0.15 XXX ± 0.10	Material SEE NOTE
Drawn: CHC			
App'd: XXXX	Title SOCKET		NOT TO SCALE
Date: 25 JAN '10	Revision: 13		Unit: mm

Type: BB02-US
BB02-US
Drawing Number:
Sheet 1 of 1
Drawing © E and O E