

BB02-RX :-2.00mm x 2.00mm (0.079" x 0.079") SOCKET, RIGHT ANGLE, SMT, DUAL ROW - 04 to 80 CONTACTS

SPECIFICATIONS :

CURRENT RATING 2 AMP
 INSULATOR RESISTANCE 1000 MEGOHMS MIN.
 CONTACT RESISTANCE 20m ohms MAX.
 DIELECTRIC WITHSTANDING AC 500 V
 OPERATING TEMPREATURE -55°C TO +105°C
 CONTACT MATERIAL PHOSPHOR BRONZE
 INSULATOR MATERIAL THERMOPLASTIC, UL 94V-0
 STANDARD: LCP
 PLATING GOLD, TIN OR SELECTIVE OVER 30-50U" NICKEL
 SOLDERABILITY IR REFLOW: 280°C FOR 10 SEC
 MANNUAL SOLDER: 380°C FOR 3-5 SEC

NOTES:

1. RECOMMANED MATING PIN LENGTH: 3.2MM

MATES WITH: BB02-FA BB02-FU BB02-FP (straight version only)
 BB02-FD BB02-FZ BB02-FQ (straight version only)
 BB02-FE BB02-RH BB02-FS (straight version only)
 BB02-FG BB02-RN BB02-FY (straight version only)

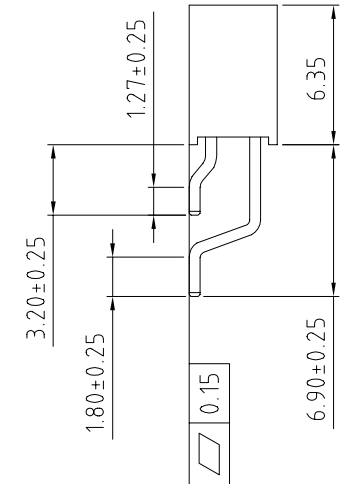
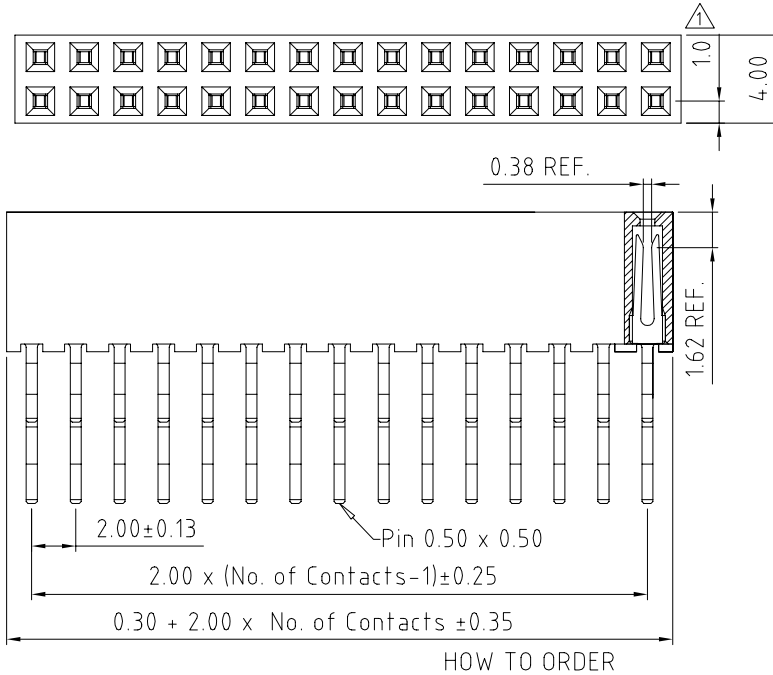

HOW TO ORDER

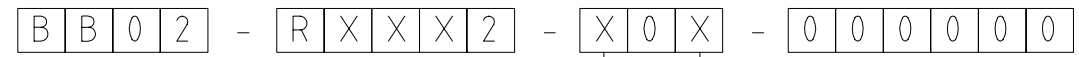

NO. OF CONTACTS
04 TO 80

CONTACT PLATING OPTIONS
 K = GOLD FLASH (STANDARD)
 A = 10U" GOLD ON CONTACT/GOLD FLASH ON TAIL
 B = 15U" GOLD ON CONTACT/GOLD FLASH ON TAIL
 C = 30U" GOLD ON CONTACT/GOLD FLASH ON TAIL
 T = BRIGHT TIN
 M = MATT TIN
 D = GOLD FLASH ON CONTACT/BRIGHT TIN ON TAIL
 E = 10U" GOLD ON CONTACT/BRIGHT TIN ON TAIL
 F = 15U" GOLD ON CONTACT/BRIGHT TIN ON TAIL
 G = 30U" GOLD ON CONTACT/BRIGHT TIN ON TAIL

PACKAGING OPTIONS
 3 - TUBE
 6 - T & R
 STANDARD = 3

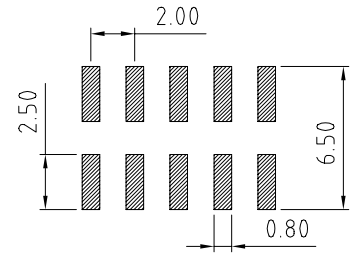

RECOMMENDED PCB LAYOUT
(TOLERANCE: ±0.05)

REV. DATE & DRN
 10 20/07/10 - CHC RELEASE
 11 03/07/11 - NYW
 ADD DIMENSION

Scale: 4:1	THIRD ANGLE	Unstated Tolerances: X ± 0.30 X ± 0.25 XX ± 0.15 XXX ± 0.10	Material SEE NOTE
Drawn: CHC			
App'd: NYW	Title SOCKET		NOT TO SCALE
Date: 3 JAN '11	Revision: 1.1		Unit: mm

© THIS DRAWING IS CONFIDENTIAL AND MUST NOT BE COPIED OR DISCLOSED WITHOUT WRITTEN CONSENT

Type: BB02-RX
BB02-RX
Drawing Number:
Sheet 1 of 1
Drawing © E and OE