

BB02-FG :- 2.00mm x 2.0mm (0.079" x 0.079") PIN HEADER, DUAL ROW, STRAIGHT OR RIGHT ANGLE - 04 to 80 CONTACTS

SPECIFICATIONS

CURRENT RATING 2 AMP Δ
 INSULATOR RESISTANCE 1000 MEGOHMS MIN.
 DIELECTRIC WITHSTANDING AC 500 V
 CONTACT RESISTANCE 20 MEGOHMS MAX.
 OPERATING TEMPERATURE -40°C TO +105°C
 CONTACT MATERIAL BRASS
 INSULATOR MATERIAL POLYESTER, UL 94V-0
 STANDARD = NYLON 6T Δ
 PLATING GOLD, TIN, OR SELECTIVE OVER 30-50U" NICKEL
 SOLDERABILITY: IR REFLOW: 260°C FOR 10 SEC
 WAVE: 230°C FOR 5-10 SEC
 MANNUAL SOLDER: 350°C FOR 3-5

PACKED IN TUBE OR TRAY Δ

MATES WITH :- BB02-GH BB02-GT
 BB02-GK BB02-GY
 BB02-GL BB02-GZ
 BB02-GM BB02-RG
 BB02-GP BB02-RJ
 BB02-GQ BB02-RP

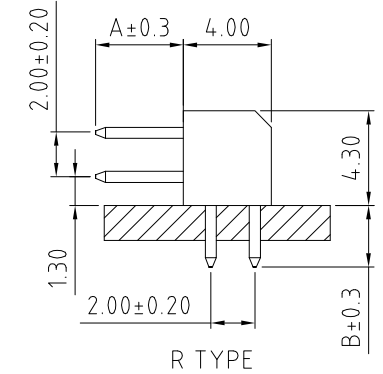
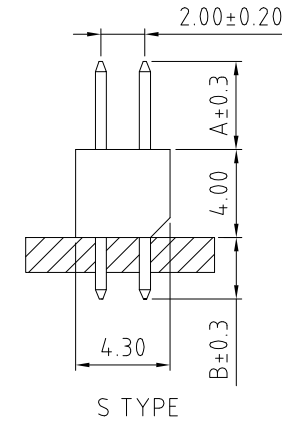
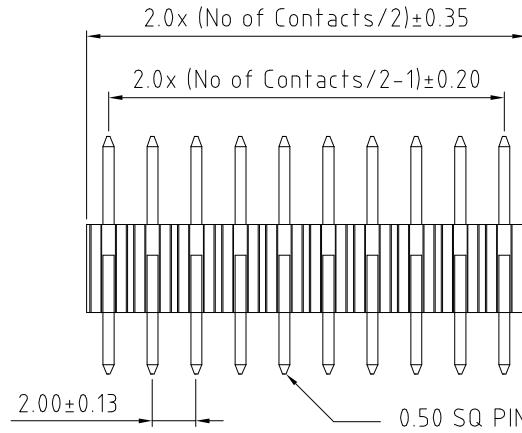

HOW TO ORDER

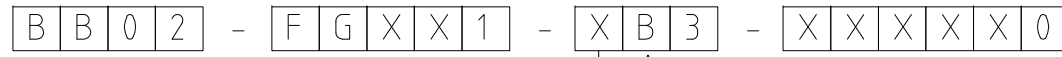

NO. OF CONTACTS
04 TO 80 Δ

CONTACT PLATING OPTIONS Δ Δ

- K = GOLD FLASH (STANDARD)
- A = 10U" GOLD ON CONTACT/GOLD FLASH ON TAIL
- B = 15U" GOLD ON CONTACT/GOLD FLASH ON TAIL
- C = 30U" GOLD ON CONTACT/GOLD FLASH ON TAIL
- T = BRIGHT TIN
- M = MATT TIN
- D = GOLD FLASH ON CONTACT/TIN ON TAIL
- E = 10U" GOLD ON CONTACT/TIN ON TAIL
- F = 15U" GOLD ON CONTACT/TIN ON TAIL
- G = 30U" GOLD ON CONTACT/TIN ON TAIL

PIN LENGTH A (1/10mm)
PLEASE SPECIFY PIN LENGTH REQUIRED
I.E. 2.5mm = 25
STANDARD = 40

PIN LENGTH B (1/10mm)
PLEASE SPECIFY PIN LENGTH REQUIRED
I.E. 2.5mm = 25
STANDARD = 28
(MIN. 1.65MM)

CONNECTOR TYPE
S = STRAIGHT
R = RIGHT ANGLE

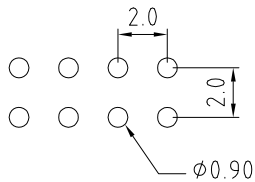

(TOLERANCE: ±0.05)

RECOMMENDED PC BOARD HOLE LAYOUT

| | |
|------|---------------------------|
| REV. | DATE & DRN |
| 1.0 | 27/05/03 - N/R RELEASE |
| 1.1 | 03/03/04 - N/R |
| 1.2 | 03/03/04 - N/R |
| 1.3 | 29/07/04 - NYW |
| 1.4 | 28/04/05 - CHC |
| 1.5 | AMEND SPECIFICATIONS |
| 1.6 | 05/09/05 - NYW |
| 1.7 | REMOVE PIN OPTION C. |
| 1.8 | AMEND PLATING |
| 1.9 | 09/08/06 - NYW |
| 2.0 | ADD PLASTIC OPTION. |
| 2.1 | DRAWING MODIFICATION. |
| 2.2 | 24/11/06 - NYW |
| 2.3 | AMEND MIN PINH Dg -> 0.4. |
| 2.4 | 25/07/07 - CHC |
| 2.5 | REMOVE MATERIAL PBT |
| 2.6 | 16/01/08 - NYW |
| 2.7 | PLATING MODIFICATION. |
| 2.8 | 31/02/08 - CHC |
| 2.9 | DRAWING MODIFICATION. |

| | | | | | |
|--------|------------|-------------|---|----------|--------------|
| Scale: | 4:1 | THIRD ANGLE | Unstated Tolerances: X ± 0.30 X ± 0.25 XX ± 0.15 XXX ± 0.10 | Material | SEE NOTE |
| Drawn: | CHC | | | | |
| App'd: | XXXX | Title | PIN HEADER | | NOT TO SCALE |
| Date: | 31 DEC '08 | Revision: | 1.9 | Unit: | mm |

www.gradconn.com

THIS DRAWING IS CONFIDENTIAL AND MUST NOT BE COPIED OR DISCLOSED WITHOUT WRITTEN CONSENT

| | |
|-----------------|-------------|
| Type: | BB02-FG |
| Drawing Number: | BB02-FG |
| Sheet | 1 of 1 |
| Drawing | © E and O E |