

BB02-JJ - 2.54mm (0.1") SOCKET, SINGLE ROW, RIGHT ANGLE, THROUGH HOLE, 02 to 40 CONTACTS, FOOTPRINT = 7.62mm

SPECIFICATIONS

CURRENT RATING 3 AMP
 INSULATOR RESISTANCE 1000 MEGOHMS MIN
 DIELECTRIC WITHSTANDING 600V AC/DC
 CONTACT RESISTANCE 20 MEGOHMS MAX.
 OPERATING TEMPERATURE -40°C TO +105°C
 CONTACT MATERIAL PHOSPHOR BRONZE
 INSULATOR MATERIAL THERMOPLASTIC, UL 94V-0
 NYLON 6T : STANDARD
 PBT : SPECIAL OPTION

PLATING GOLD OR TIN OVER 30-50U" NICKEL
 SOLDERABILITY: NYLON 6T - IR REFLOW: 260°C FOR 10 SEC
 WAVE: 230°C FOR 5-10 SEC
 MANUAL SOLDER: 350°C FOR 3-5 SEC

NOTES:

1. PACKED IN TUBE.
2. RECOMMENDED MATING PIN LENGTH: 4.5MM. Δ

MATES WITH: - BB02-HA BB02-HY
 BB02-HC BB02-TA
 BB02-HD BB02-TC
 BB02-HG BB02-TJ
 BB02-HH BB02-TK

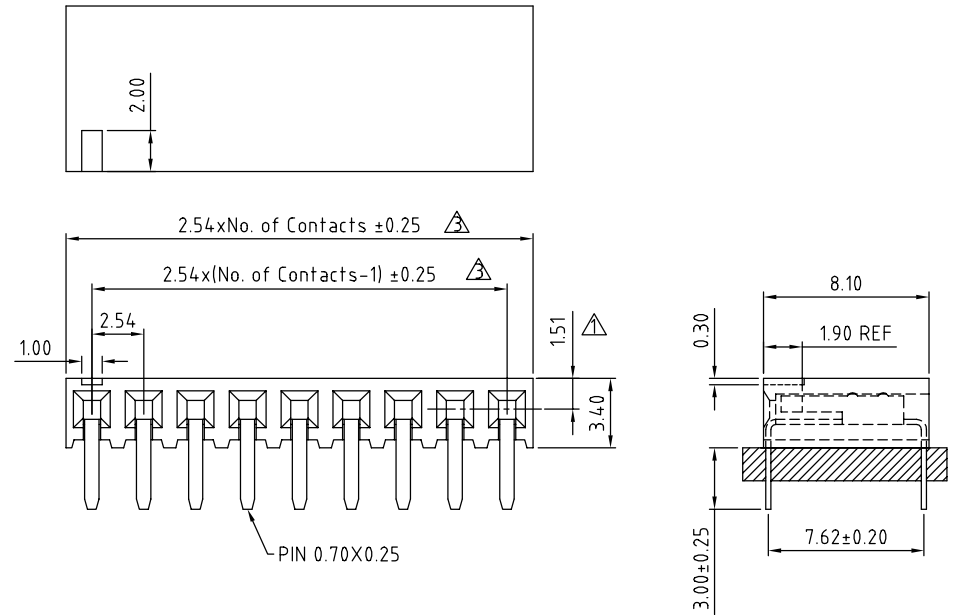

HOW TO ORDER

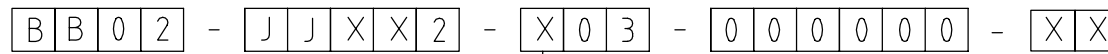

NO OF CONTACTS
02 TO 40

CONTACT PLATING OPTIONS Δ
 K = GOLD FLASH (STANDARD)
 A = 10U" GOLD ON CONTACT/GOLD FLASH ON TAIL
 B = 15U" GOLD ON CONTACT/GOLD FLASH ON TAIL
 C = 30U" GOLD ON CONTACT/GOLD FLASH ON TAIL
 T = BRIGHT TIN
 M = MATT TIN

INSULATOR MATERIAL Δ
 6T = NYLON 6T (STANDARD)
 BLANK = PBT (Not suitable for new designs.)

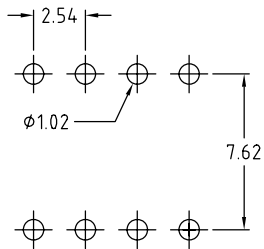

RECOMMENDED PC BOARD LAYOUT
(TOLERANCE: ±0.05)

10	31/02/06-NYW	RELEASE
11	15/01/05-NYW	
12	07/07/05-NYW	
13	17/07/05-NYW	
14	15/08/06-NYW	
15	07/07/05-NYW	
16	22/07/05-NYW	
17	27/05/08-PN	
18	17/02/09-CHC	

Scale	4=1	THIRD ANGLE	Unstated Tolerances X. ± 0.30 .X ± 0.25 .XX ± 0.15 .XXX ± 0.10	Material	SEE NOTE	 www.gradconn.com	Type	BB02-JJ
Drawn	CHC						Drawing Number BB02-JJ	
App'd	XXX	Title	SOCKET		NOT TO SCALE	Sheet	1 of 1	
Date	17 FEB '09	Revision	: 18	Unit:	mm	THIS DRAWING IS CONFIDENTIAL AND MUST NOT BE COPIED OR DISCLOSED WITHOUT WRITTEN CONSENT	Drawing E and O E	