

BB02-YL:- 1.00MM (0.039") PIN HEADER, SINGLE ROW, STRAIGHT, THROUGH HOLE TYPE, 02 TO 40 CONTACTS, BOARD SPACER

SPECIFICATIONS

CURRENT RATING: 1AMP
 INSULATOR RESISTANCE: 500 MEGOHMS MIN.
 DIELECTRIC WITHSTANDING: AC 600 V
 CONTACT RESISTANCE: 20m OHMS MAX.
 OPERATING TEMPERATURE: -40°C TO +105°C
 CONTACT MATERIAL: BRASS
 INSULATOR MATERIAL: POLYESTER UL 94V-0
 STANDARD: LCP
 PLATING: GOLD FLASH OR TIN OVER 30-50U" NICKEL
 SOLDERABILITY IR REFLOW: 280°C FOR 10 SEC
 WAVE: 250°C FOR 5-10 SEC
 MANNUAL SOLDER: 380°C FOR 3-5 SEC

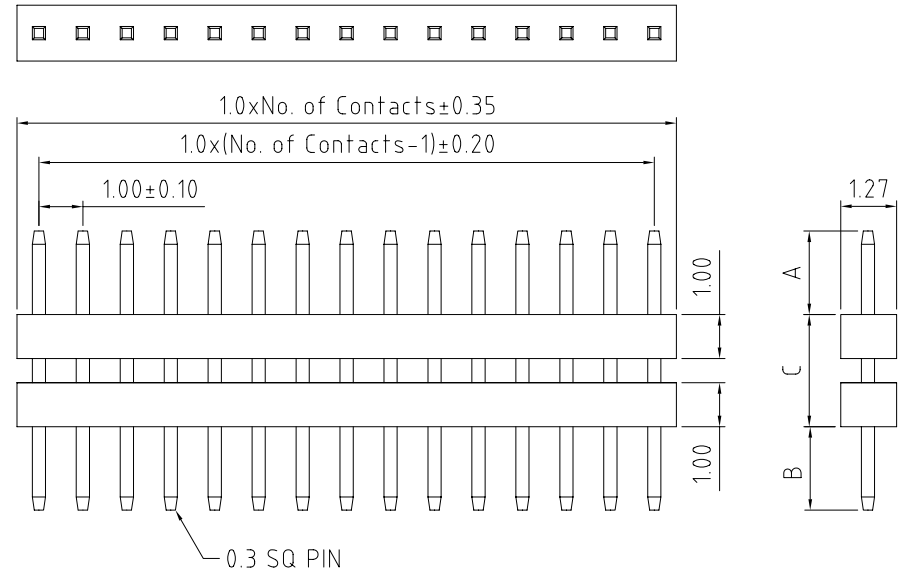
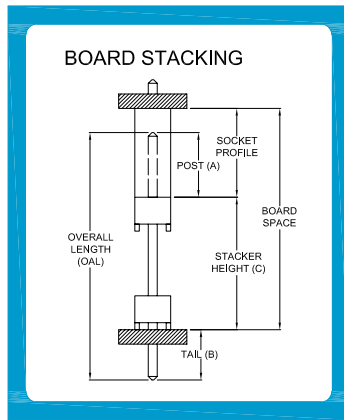

PACKAGING: LOOSE IN BOX OR BAG.

MATES WITH: - BB02-WD BB02-WF
 BB02-WE

NOTES:

- MIN. OAL (OVERALL PIN LENGTH A+B+C) = 5.1MM.
- MAX. OAL (OVERALL PIN LENGTH A+C+B) = 20MM. Δ

HOW TO ORDER



<p>NO. OF CONTACTS 02 to 40</p>	<p>CONTACT PLATING OPTIONS K = GOLD FLASH (STANDARD) T = BRIGHT TIN M = MATT TIN</p>	<p>PIN LENGTH A (1/10mm) SPECIFY PIN LENGTH STANDARD = 15 = 1.5mm MINIMUM = 10 = 1.0mm MAXIMUM = 150 = 15.0mm TOL.: ±0.25mm</p>	<p>PIN LENGTH B (1/10mm) SPECIFY PIN LENGTH STANDARD = 30 = 3.0mm MINIMUM = 10 = 1.0mm MAXIMUM = 150 = 15.0mm TOL.: ±0.25mm</p>	<p>PIN LENGTH C (1/10mm) SPECIFY PIN LENGTH MINIMUM = 20 = 2.0mm MAXIMUM = SEE NOTES 2 TOL.: ±0.25mm</p>
-------------------------------------	--	---	---	--

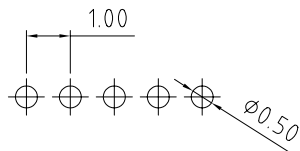

(TOLERANCE: ±0.05)
 RECOMMENDED PCB HOLE LAYOUT

LONGER PIN LENGTH REQUIRED?
 If pin length required is longer than 9.9mm (99), then use a '/' to separate the numbers.
 Example: A=6.0mm, B=3.0mm, C=11.0mm, mark as 60 / 30 / 110.

REV.	DATE & DRN
10	04/02/09 - NYW RELEASE
11	19/06/09 - NYW AMEND STANDARD A = 15.
12	30/11/09 - CHC AMEND NOTES 2.

Scale: 8:1	THIRD ANGLE		Unstated Tolerances: X ± 0.30 XX ± 0.25 XXX ± 0.15 XXXX ± 0.10	Material: SEE NOTE
Drawn: NYW	Title: PIN HEADER			NOT TO SCALE
App'd: XXX	Revision: 1.2			Unit: mm

www.gradconn.com

THIS DRAWING IS CONFIDENTIAL AND MUST NOT BE COPIED OR DISCLOSED WITHOUT WRITTEN CONSENT

Type: BB02-YL
BB02-YL
Drawing Number:
Sheet 1 of 1
Drawing © E and O E