

BB02-YJ

CUSTOMER PRODUCT SPECIFICATION SHEET



BB02-YJ:- 1.00MM (0.039") PIN HEADER, SINGLE ROW, STRAIGHT, THROUGH HOLE TYPE, 02 TO 40 CONTACTS

SPECIFICATIONS

CURRENT RATING: 1AMP
 INSULATOR RESISTANCE: 1000 MEGOHMS MIN.
 DIELECTRIC WITHSTANDING: AC 300 V
 CONTACT RESISTANCE: 20m OHMS MAX.
 OPERATING TEMPERATURE: -40°C TO +105°C
 CONTACT MATERIAL: BRASS
 INSULATOR MATERIAL: THERMOPLASTIC, UL 94V-0
 STANDARD: LCP + 30% G/F
 PLATING: GOLD FLASH OR TIN OVER 30-50U" NICKEL
 SOLDERABILITY IR REFLOW: 280°C FOR 10 SEC
 WAVE: 250°C FOR 5-10 SEC
 MANUAL SOLDER: 380°C FOR 3-5 SEC

PACKAGING: LOOSE IN BOX OR BAG.

MATES WITH: - BB02-WD
 BB02-WE
 BB02-WF

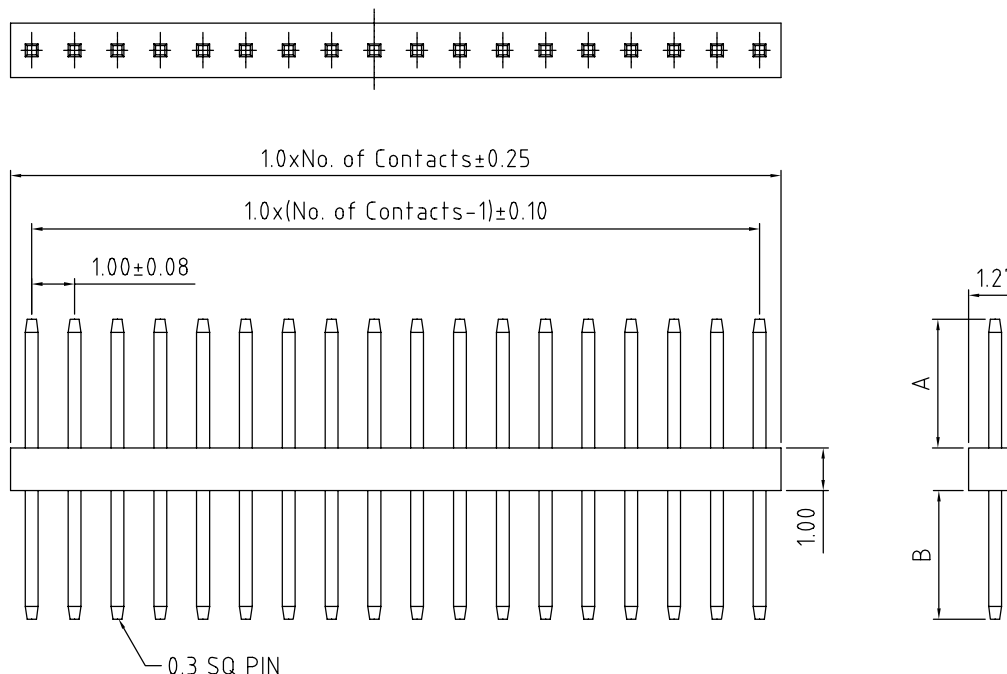

HOW TO ORDER

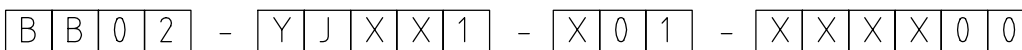

NO. OF CONTACTS 02 to 40	CONTACT PLATING OPTIONS K = GOLD FLASH (STANDARD) T = BRIGHT TIN M = MATT TIN	PIN LENGTH A (1/10mm) PLEASE SPECIFY PIN LENGTH REQUIRED I.E. 2.5mm = 25 TOL. ±0.25mm STANDARD = 15 MINIMUM = 10 MAXIMUM = 80	PIN LENGTH B (1/10mm) PLEASE SPECIFY PIN LENGTH REQUIRED I.E. 2.5mm = 25 TOL. ±0.25mm STANDARD = 30 MINIMUM = 10 MAXIMUM = 80
-----------------------------	--	---	---

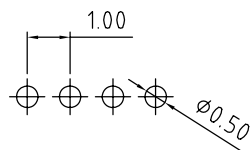

RECOMMENDED PCB HOLE LAYOUT

REV.	DATE & DRN
1.0	19/04/08-NYW- RELEASE
1.1	11/09/08-NYW- CHANGE MIN. PINE FROM 05 TO 02.
1.2	11/08/08-NYW- ADD T AND M PLATING OPTIONS.
1.3	25/12/08-NYW- DRAWING MODIFICATION.
1.4	26/03/09 - NYW - REMOVE NOTE 1.
1.5	19/06/09 - NYW - CHANGE STANDARD A = 15.
1.6	18/08/11 - NYW - ADD MIN. AND MAX. A & B PIN LENGTH.

Scale: 8:1	THIRD ANGLE	Unstated Tolerances: X ± 0.30 .X ± 0.25 .XX ± 0.15 .XXX ± 0.10	Material SEE NOTE
Drawn: NYW		Title: PIN HEADER	NOT TO SCALE
App'd: XXX		Date: 18 AUG '11	Unit: mm

www.gradconn.com

THIS DRAWING IS CONFIDENTIAL AND MUST NOT BE COPIED OR DISCLOSED WITHOUT WRITTEN CONSENT

Type BB02-YJ
BB02-YJ
Drawing Number:
Sheet 1 of 1
Drawing © E and O E