

BB02-DG :- 1.27mm x 2.54mm (0.05" x 0.1") DUAL ROW PIN HEADER, STRAIGHT, THROUGH HOLE, 06 TO 80 CONTACTS

**SPECIFICATIONS**

CURRENT RATING	1 AMP
INSULATOR RESISTANCE	1000 MEGOHMS MIN.
DIELECTRIC WITHSTANDING	AC 300 V
OPERATING TEMPERATURE	-40°C TO +105°C
CONTACT MATERIAL	BRASS
INSULATOR MATERIAL	POLYESTER UL 94V-0 STANDARD NYLON 6T
PLATING	GOLD, TIN OR SELECTIVE OVER 30~50U" NICKEL
SOLDERABILITY	IR REFLOW: 260°C FOR 10 SEC WAVE: 230°C FOR 5-10 SEC MANUAL SOLDER: 350°C FOR 5-10 SEC

PACKED IN TRAY OR BOX.

MATES WITH :- BB02-EA  
BB02-EB  
BB02-EC

NOTES:  
1. MAX. OAL (OVERALL PIN LENGTH A+C+B) = 40mm.

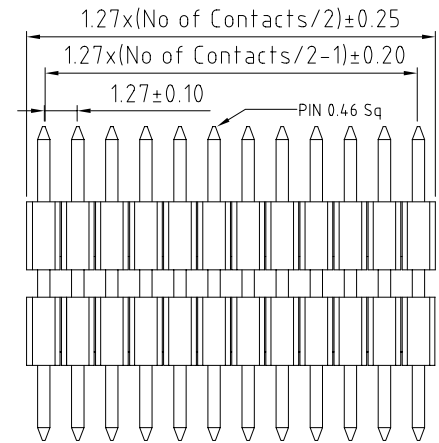
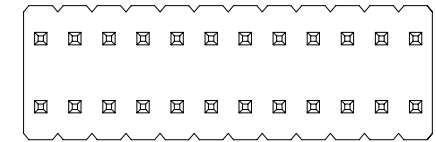
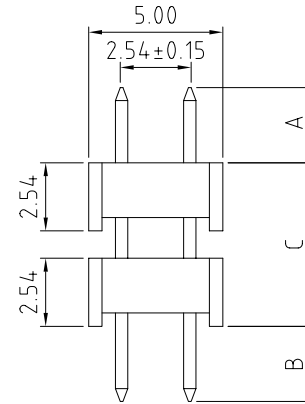
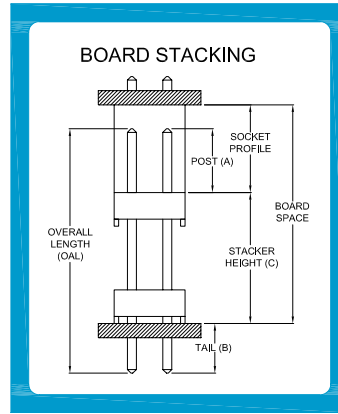

**HOW TO ORDER**

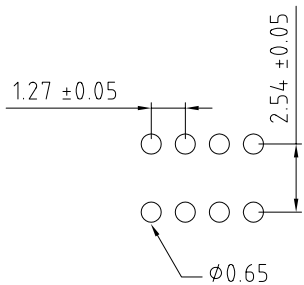
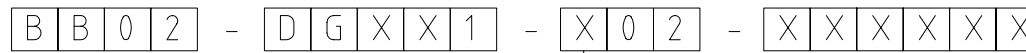

RECOMMENDED PC BOARD HOLE LAYOUT

NO. OF CONTACTS  
06 TO 80

CONTACT PLATING OPTIONS  
 K = GOLD FLASH (STANDARD)  
 A = 10U" GOLD ON CONTACT/GOLD FLASH ON TAIL  
 B = 15U" GOLD ON CONTACT/GOLD FLASH ON TAIL  
 C = 30U" GOLD ON CONTACT/GOLD FLASH ON TAIL  
 T = BRIGHT TIN  
 M = MATT TIN  
 D = GOLD FLASH ON CONTACT/BRIGHT TIN ON TAIL  
 E = 10U" GOLD ON CONTACT/BRIGHT TIN ON TAIL  
 F = 15U" GOLD ON CONTACT/BRIGHT TIN ON TAIL  
 G = 30U" GOLD ON CONTACT/BRIGHT TIN ON TAIL

PIN LENGTH A (1/10mm)  
 SPECIFY PIN LENGTH  
 STANDARD = 40 = 4.0mm  
 MINIMUM = 10 = 1.0mm  
 MAXIMUM = 150 = 15.0mm  
 TOL.: ±0.25mm

PIN LENGTH B (1/10mm)  
 SPECIFY PIN LENGTH  
 STANDARD = 26 = 2.6mm  
 MINIMUM = 10 = 1.0mm  
 MAXIMUM = 150 = 15.0mm  
 TOL.: ±0.25mm

PIN LENGTH C (1/10mm)  
 SPECIFY PIN LENGTH  
 MINIMUM = 51 = 5.1mm  
 MAXIMUM = SEE NOTE: 1  
 TOL.: ±0.25mm

LONGER PIN LENGTH REQUIRED?  
 If pin length required is longer than 9.9mm (99), then use a '/' to separate the numbers.  
 Example: A=6.0mm, B=3.0mm, C=12.5mm, mark as 60 / 30 / 125.

Scale: 5:1	THIRD ANGLE	Unstated Tolerances: X ± 0.30 X ± 0.25 XX ± 0.15 XXX ± 0.10	Material SEE NOTE	 www.gradconn.com THIS DRAWING IS CONFIDENTIAL AND MUST NOT BE COPIED OR DISCLOSED WITHOUT WRITTEN CONSENT	Type: BB02-DG
Drawn: NYW		Title: PIN HEADER	NOT TO SCALE		BB02-DG
App'd: XXXX	Revision: 1.0	UNIT: mm			Drawing Number: Sheet 1 of 1
Date: 5 JAN '09					Drawing © E and O E