

BB02-NU :- 1.27mm (0.05") FEMALE HEADER, SINGLE ROW, STRAIGHT, THROUGH HOLE, 2 - 33 CONTACTS

SPECIFICATIONS

CURRENT RATING	1 AMP
INSULATOR RESISTANCE	1000 MEGOHMS MIN.
CONTACT RESISTANCE	20m ohms MAX.
DIELECTRIC WITHSTANDING	AC 300 V
OPERATING TEMPERATURE	-40°C TO +105°C
CONTACT MATERIAL	PHOSPHOR BRONZE
INSULATOR MATERIAL	POLYESTER, UL 94V-0
	STANDARD: LCP
PLATING	GOLD, TIN OR SELECTIVE OVER 30~50U" NICKEL
SOLDERABILITY	IR REFLOW: 280°C FOR 10 SEC
	WAVE: 250°C FOR 5-10 SEC
	MANNUAL SOLDER: 380°C FOR 3-5 SEC

PACKED IN TUBE OR TRAY.

NOTES:

1. RECOMMENDED MATING PIN LENGTH : 2.0MM
2. THIS PART IS SUITABLE FOR 1.5MM AND 3.0MM MATING PIN.

MATES WITH :- (0.46MM SQUARE PINS)
 BB02-BL BB02-NH
 BB02-BM BB02-NM

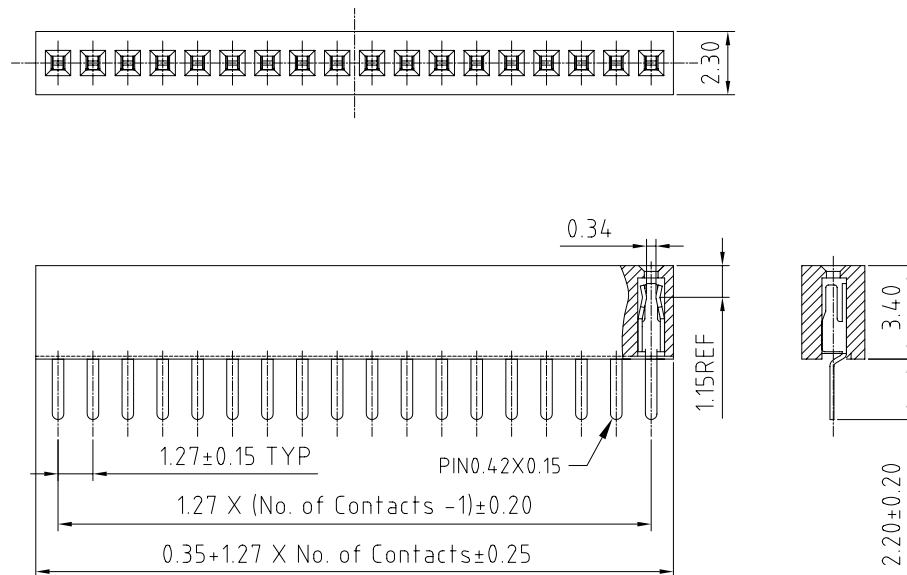

HOW TO ORDER

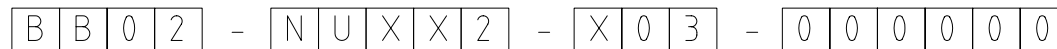

NO. OF CONTACTS
02 to 33

CONTACT PLATING OPTIONS

- K = GOLD FLASH (STANDARD)
- A = 10U" GOLD ON CONTACT/GOLD FLASH ON TAIL
- B = 15U" GOLD ON CONTACT/GOLD FLASH ON TAIL
- C = 30U" GOLD ON CONTACT/GOLD FLASH ON TAIL
- T = BRIGHT TIN
- M = MATT TIN
- D = GOLD FLASH ON CONTACT/BRIGHT TIN ON TAIL
- E = 10U" GOLD ON CONTACT/BRIGHT TIN ON TAIL
- F = 15U" GOLD ON CONTACT/BRIGHT TIN ON TAIL
- G = 30U" GOLD ON CONTACT/BRIGHT TIN ON TAIL

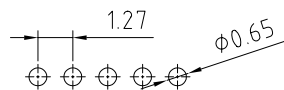

RECOMMENDED PC BOARD HOLE LAYOUT
(TOLERANCE: ±0.05)

REV. DATE & DRN
10 24/07/09 - CHC RELEASE

Scale: 1:1	THIRD ANGLE	Unstated Tolerances: X ± 0.30 X ± 0.25 XX ± 0.15 XXX ± 0.10	Material SEE NOTE	 www.gradconn.com THIS DRAWING IS CONFIDENTIAL AND MUST NOT BE COPIED OR DISCLOSED WITHOUT WRITTEN CONSENT	Type: BB02-NU
Drawn: CHC			NOT TO SCALE		BB02-NU
App'd: XXXX	Title: SOCKET		UNIT: mm		Drawing Number:
Date: 24 JUL '09	Revision: 1.0				Sheet 1 of 1
					Drawing © E and O E