

BB02-CR :- 1.27mm X 1.27mm (0.05" X 0.05") SMD SOCKET, DUAL ROW, STRAIGHT, 6 TO 100 CONTACTS, DUAL ENTRY

SPECIFICATIONS

CURRENT RATING 1 AMP
 INSULATOR RESISTANCE 1000 MEGOHMS MIN.
 CONTACTS RESISTANCE 20m OHMS MAX.
 DIELECTRIC WITHSTANDING AC 300 V
 OPERATING TEMPERATURE -40°C TO +105°C
 CONTACT MATERIAL PHOSPHOR BRONZE
 INSULATOR MATERIAL THERMOPLASTIC, UL 94V-0

Film Width	
No. of Pins	Size
06 - 50	5mm
52 - 100	10mm

(STANDARD: NYLON 6T FOR 6~50 CONTACTS,
 LCP+30% G/F FOR 52~100 CONTACTS)

PLATING GOLD OR TIN OVER MIN. 30U" NICKEL
 SOLDERABILITY: NYLON 6T - IR REFLOW: 260°C FOR 10 SEC
 MANUAL SOLDER: 350°C FOR 3-5 SEC
 LCP - IR REFLOW: 280°C FOR 10 SEC
 MANUAL SOLDER: 380°C FOR 3-5 SEC

NOTES:
 1. RECOMMENDED MATING PIN LENGTH FROM TOP ENTRY IS 3.0MM

MATES WITH:- BB02-BC BB02-BS
 BB02-BD BB02-BY
 BB02-BE BB02-BZ
 BB02-BK BB02-NE
 BB02-BP

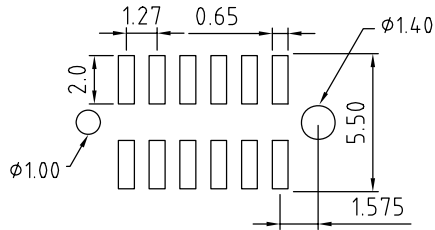

TOP ENTRY WITH PEGS (OUTSIDE)

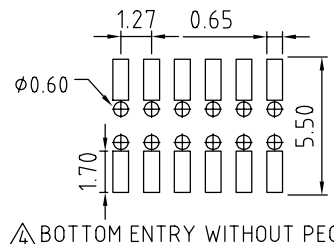

BOTTOM ENTRY WITHOUT PEGS

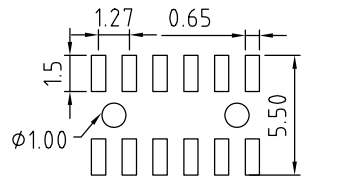

TOP ENTRY WITH PEGS (INSIDE)

RECOMMENDED PCB LAYOUT (TOLERANCE: ±0.05)

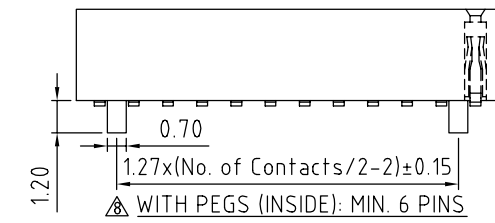
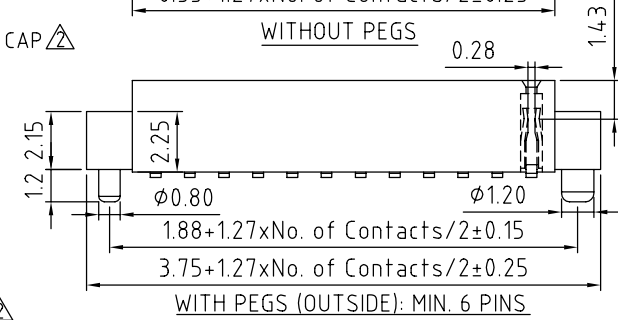
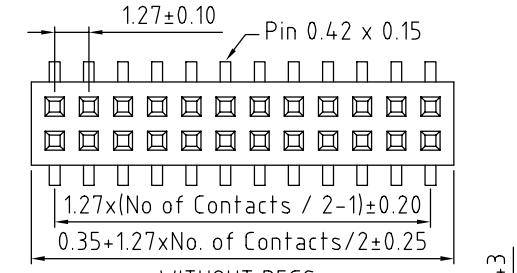
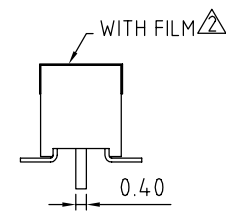
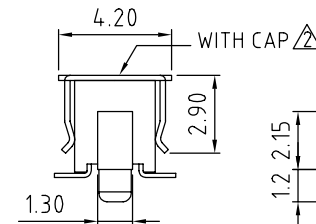
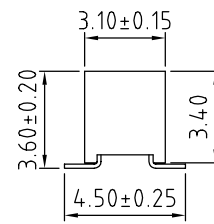

HOW TO ORDER



NO. OF CONTACTS :
 06 TO 98
 00 = 100

CONTACT PLATING OPTIONS :
 K = GOLD FLASH (STANDARD)
 A = 10U" GOLD ON CONTACT/GOLD FLASH ON TAIL
 B = 15U" GOLD ON CONTACT/GOLD FLASH ON TAIL
 C = 30U" GOLD ON CONTACT/GOLD FLASH ON TAIL
 T = BRIGHT TIN
 M = MATT TIN

PACKING OPTIONS :
 3 = TUBE
 4 = TUBE & FILM
 5 = TUBE & CAP
 6 = T+R
 7 = T+R+FILM
 8 = T+R+CAP

LOCATING PEGS OPTIONS :
 A = WITH PEGS (OUTSIDE)
 E = WITH PEGS (INSIDE)
 0 = WITHOUT PEGS

REV. DATE & DRN	1.0 13/06/05 - NYW RELEASE
	1.1 21/07/05 - NYW
	ADD LOCATING PEG OPTION.
	ADD PCB LAYOUT.
	1.2 04/11/05 - NYW
	ADD FILM & CAP.
	1.3 20/07/06 - NYW
	DRAWING MODIFICATION.
	1.4 05/06/07 - CHC
	ADD NOTES 1.
	1.5 06/10/07 - CHC
	REMOVE PLATING GOLD
	CONFORMAL PLATING.
	1.6 27/06/08 - CHC
	PLATING MODIFICATION.
	1.7 07/08/08 - CHC
	DRAWING MODIFICATION.
	1.8 23/08/11 - NYW
	ADD LOCATING PEGS OPTION.
	1.9 08/08/11 - NYW
	ADD NICKEL THICKNESS.

Scale: 5:1	THIRD ANGLE	Unstated Tolerances: X ± 0.30 X ± 0.25 XX ± 0.15 XXX ± 0.10	Material SEE NOTE
Drawn: CHC			
App'd: XXXX	Title SOCKET		NOT TO SCALE
Date: 31 AUG '11	Revision: 1.9		UNIT: mm

www.gradconn.com

THIS DRAWING IS CONFIDENTIAL AND MUST NOT BE COPIED OR DISCLOSED WITHOUT WRITTEN CONSENT

Type: BB02-CR
BB02-CR
DRAWING NUMBER:
Sheet 1 of 1
Drawing © E and O E