

BB02-BD

CUSTOMER PRODUCT SPECIFICATION SHEET

RoHS Compliant

BB02-BD :- 1.27mm X 1.27mm (0.05" X 0.05") R/A PIN HEADER, DUAL ROW, THROUGH HOLE - 4 TO 100 CONTACTS

SPECIFICATIONS

CURRENT RATING 1 AMP
 INSULATOR RESISTANCE 1000 MEGOHMS MIN.
 DIELECTRIC WITHSTANDING AC 300 V
 OPERATING TEMPERATURE -40°C TO +105°C
 CONTACT MATERIAL BRASS
 INSULATOR MATERIAL THERMOPLASTIC, UL 94V-0
 STANDARD : LCP+30%GF
 PLATING GOLD, TIN, OR SELECTIVE OVER MIN. 30U" NICKEL
 SOLDER ABILITY IR REFLOW: 280°C FOR 10 SEC
 WAVE: 250°C FOR 5-10 SEC
 MANUAL SOLDER: 380°C FOR 3-5 SED

PACKED IN TUBE OR BOX

MATES WITH :- BB02-CL BB02-CU
 BB02-CM BB02-CW
 BB02-CN BB02-CZ
 BB02-CQ
 BB02-CR

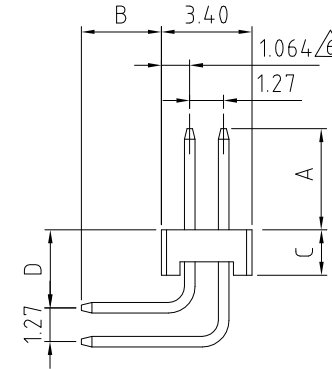
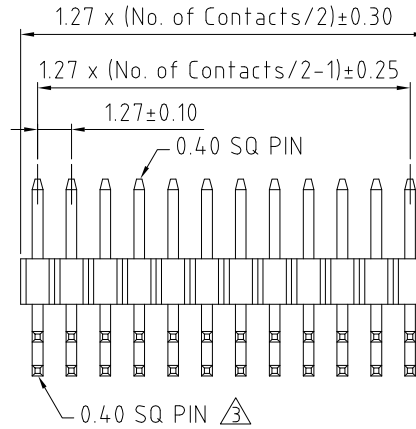

C & D OPTIONS:

CODE	C	D
A	2.7	3.10
B	1.7	3.30
C	1.5	3.30
D	2.7	2.90
E	1.7	1.90
F	1.5	1.70
G	1.0	3.50
H	1.5	1.90
I	2.5	3.77
K	1.5	2.50
L	1.0	1.65

(CUSTOM LENGTH AVAILABLE UPON REQUEST)

HOW TO ORDER

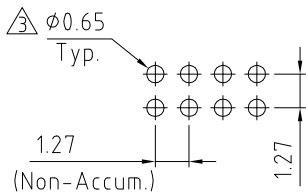
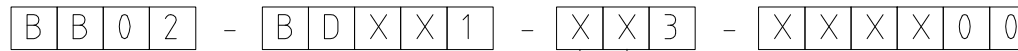

RECOMMENDED PC BOARD HOLE LAYOUT (TOLERANCE: ±0.05)

NO. OF CONTACTS
 04 TO 100 (FOR C = 1.7, 1.5)
 00 = 100 CONTACTS
 04 TO 80 (FOR C = 2.7)

CONTACT PLATING OPTIONS
 K = GOLD FLASH (STANDARD)
 A = 10U" GOLD ON CONTACT/GOLD FLASH ON TAIL
 B = 15U" GOLD ON CONTACT/GOLD FLASH ON TAIL
 C = 30U" GOLD ON CONTACT/GOLD FLASH ON TAIL
 T = BRIGHT TIN
 M = MATT TIN
 D = GOLD FLASH ON CONTACT/BRIGHT TIN ON TAIL
 E = 10U" GOLD ON CONTACT/BRIGHT TIN ON TAIL
 F = 15U" GOLD ON CONTACT/BRIGHT TIN ON TAIL
 G = 30U" GOLD ON CONTACT/BRIGHT TIN ON TAIL

HEIGHT 'C' & 'D' OPTIONS:
 (SEE CHART FOR DETAIL)

PIN LENGTH A (1/10mm)
 PLEASE SPECIFY PIN LENGTH REQUIRED IN mm
 I.E. 2.5mm = 25
 STANDARD = 38
 TOL. ±0.25

PIN LENGTH B (1/10mm)
 PLEASE SPECIFY PIN LENGTH REQUIRED IN mm
 I.E. 2.5mm = 25
 STANDARD = 30
 TOL. ±0.25

REV.	DATE	DRN
1.0	22/04/02	- A/KCL RELEASE
1.1	28/07/04	- CHC
1.2	10/02/05	- NYW
1.3	07/05/05	- NYW
1.4	13/03/06	- CHC
1.5	17/07/06	- NYW
1.6	02/05/07	- NYW
1.7	10/02/07	- NYW
1.8	05/06/07	- NYW
1.9	12/10/07	- NYW
2.0	30/10/08	- CHC
2.1	02/12/08	- CHC
2.2	25/02/09	- CHC
2.3	21/05/09	- CHC
2.4	12/08/10	- NYW
2.5	15/11/11	- NYW

11	28/07/04	- CHC
12	10/02/05	- NYW
13	07/05/05	- NYW
14	13/03/06	- CHC
15	17/07/06	- NYW
16	02/05/07	- NYW
17	10/02/07	- NYW
18	05/06/07	- NYW
19	12/10/07	- NYW
20	30/10/08	- CHC
21	02/12/08	- CHC
22	25/02/09	- CHC
23	21/05/09	- CHC
24	12/08/10	- NYW
25	15/11/11	- NYW

Scale:	5:1
Drawn:	CHC
App'd:	XXXX
Date:	15 NOV. '11

THIRD ANGLE	
Title	PIN HEADER
Revision:	2.5

Unstated Tolerances:	X. ± 0.30
	.X ± 0.25
	.XX ± 0.15
	.XXX ± 0.10

Material	SEE NOTE
NOT TO SCALE	
Unit	mm

www.gradconn.com

THIS DRAWING IS CONFIDENTIAL AND MUST NOT BE COPIED OR DISCLOSED WITHOUT WRITTEN CONSENT

Type:	BB02-BD
Drawing Number:	BB02-BD
Sheet	1 of 1
Drawing	© E and O E