

BB02-AY:- 0.8x1.2MM PIN HEADER, DUAL ROW, STRAIGHT, SMT TYPE, 06 TO 100 CONTACTS

SPECIFICATIONS

CURRENT RATING: 0.5AMP
 INSULATOR RESISTANCE: 1000 MEGOHMS MIN.
 DIELECTRIC WITHSTANDING: AC 300 V
 CONTACT RESISTANCE: 20m OHMS MAX.
 OPERATING TEMPERATURE: -40°C TO +105°C
 CONTACT MATERIAL: PHOSPHOR BRONZE
 INSULATOR MATERIAL: POLYESTER UL 94V-0
 STANDARD: NYLON 9T
 PLATING: GOLD, TIN OR SELECTIVE FLASH OVER 30-50U" NICKEL
 SOLDERABILITY IR REFLOW: 260°C FOR 10 SEC
 WAVE: 230°C FOR 5-10 SEC
 MANUAL SOLDER: 350°C FOR 3-5 SEC

MATES WITH: - BB02-AZ

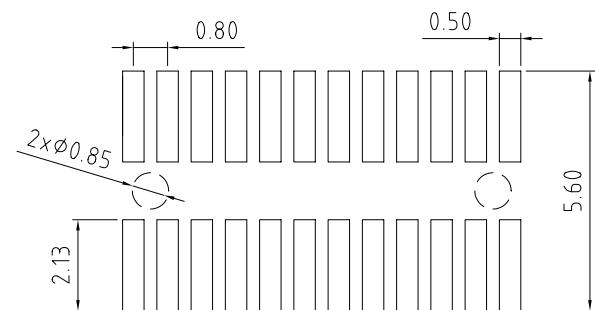
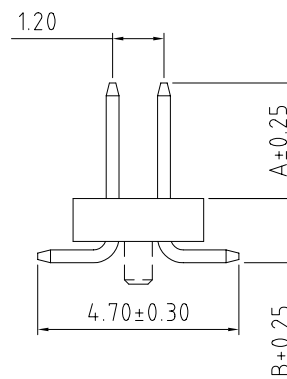
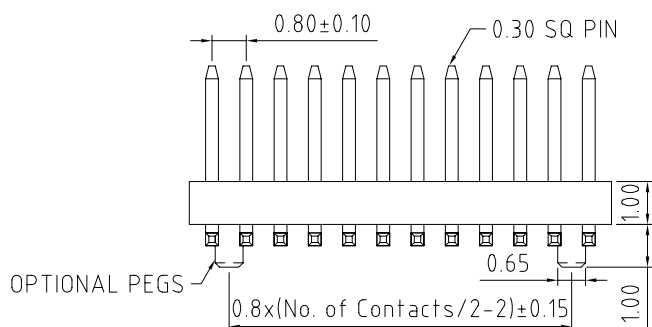
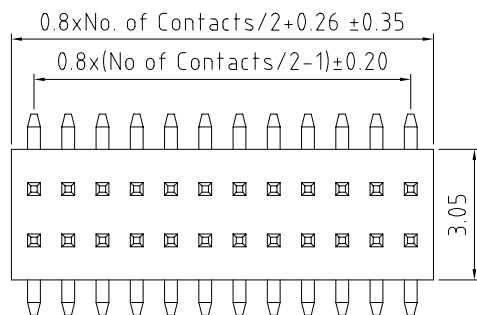

RECOMMENDED PCB HOLE LAYOUT

HOW TO ORDER

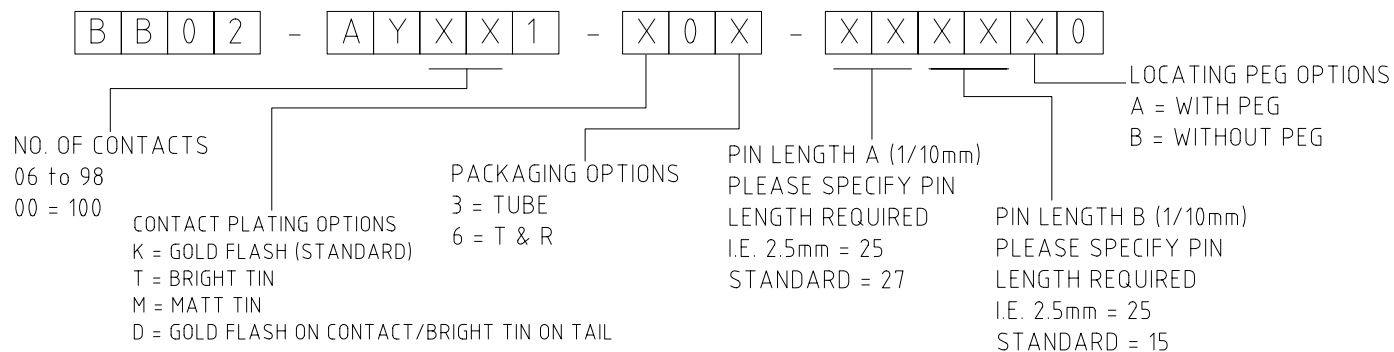

REV. DATE & DRN
 10 18/08/08/NYW RELEASE

Scale: 8:1	THIRD ANGLE	Unstated Tolerances: X ± 0.25 XX ± 0.15 XXX ± 0.10	Material SEE NOTE	 www.gradconn.com THIS DRAWING IS CONFIDENTIAL AND MUST NOT BE COPIED OR DISCLOSED WITHOUT WRITTEN CONSENT	Type BB02-AY
Drawn: NYW			NOT TO SCALE		BB02-AY
App'd: XXX	Title: PIN HEADER				Drawing Number:
Date: 8 AUG '08	Revision: 1.0		Unit: mm		Sheet 1 of 1
					Drawing © E and O E