

BB02-AL - 0.8mm (0.0315") BOARD STACKER FEMALE RIGHT ANGLE SMT TYPE 10 TO 68 CONTACTS, WITH LOCATING PEGS

SPECIFICATIONS

CURRENT RATING	0.5 AMP AC/DC
VOLTAGE RATING	100V AC/DC
INSULATOR RESISTANCE	100 MEGOHMS MIN AT 250V DC
CONTACT RESISTANCE	40m OHM MAX
DIELECTRIC WITHSTANDING	AC 500V(r.ms.) AT 0.5mA FOR 1 MIN.
OPERATING TEMPERATURE	-40°C TO +105°C
CONTACT MATERIAL	PHOSPHOR BRONZE
INSULATOR MATERIAL	THERMOPLASTIC UL94V-0 STANDARD: NYLON 46
MAX. PROCESSING TEMP	260°C FOR 5-10 SEC
PLATING	GOLD FLASH ALL OVER 30~50U" NICKEL
MATING CYCLE	500 TIMES MIN. $\Delta$

MATING PARTS AND MATING HEIGHT: -

P/N (PLUG)	P/N (SOCKET)	PLUG HEIGHT A	MATING HEIGHT H
AHXX1-KAX	ALXX2-K0X	3.55MM	5.65MM
AHXX1-KBX	ALXX2-K0X	4.05MM	6.15MM

NOTES:

- $\Delta$ 1. MOQ: TUBE - 5,000PCS, REEL - FULL REEL QTY  $\geq$  5,000PCS.
- $\Delta$ 2. OTHER EVEN NUMBER CIRCUIT SIZES ARE POSSIBLE, UPTO A MAXIMUM OF 100 CONTACTS, BUT ARE NOT TOOLED AT THIS TIME. PLEASE CONTACT GRADCONN FOR DETAILS.

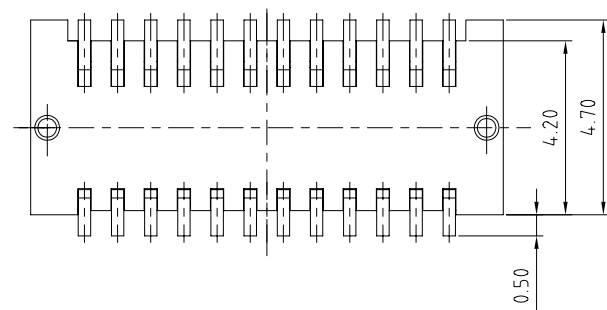
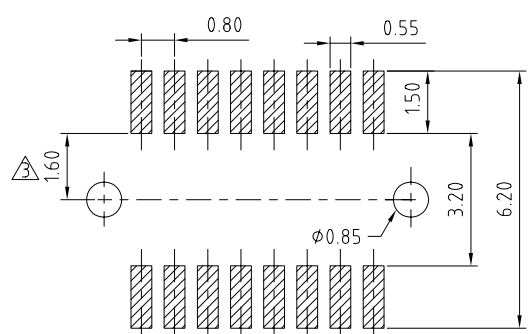
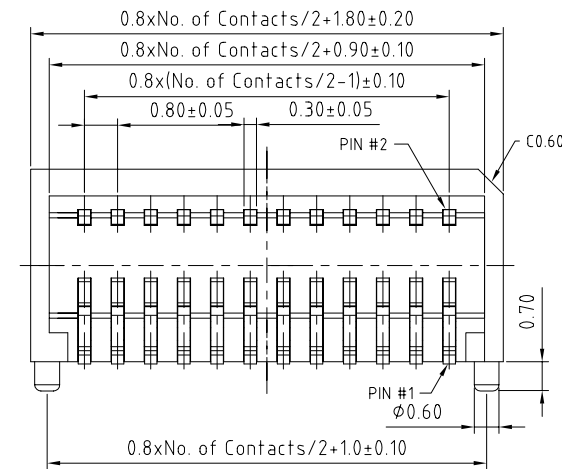
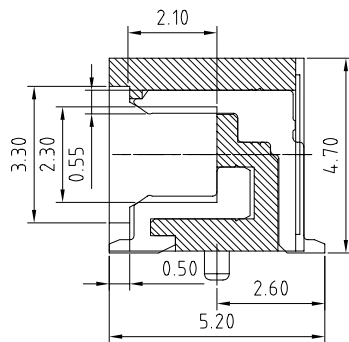
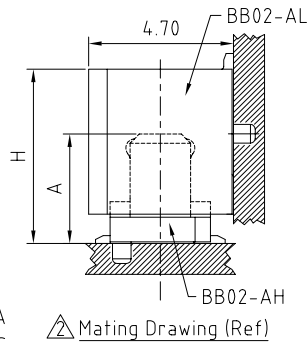

RECOMMENDED PC BOARD LAYOUT

HOW TO ORDER

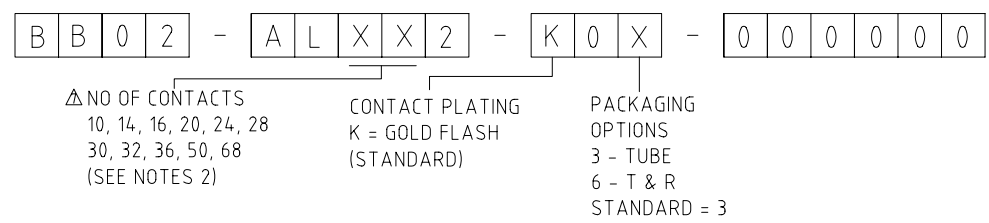

REV. DATE EDRN	11 22/06/07 - NYM RELEASE
ADD MATING CYCLE	12 06/07/07 - NYM
ADD MATEL LAYOUT DIMENSION	13 06/03/08 - NYM
ADD MATEL LAYOUT DIMENSION	14 07/07/08 - NYM
ADD TOLERANCE	15 07/07/08 - CHC
ADD SUGGESTED MATING ANGLES	16 31/07/08 - NYM
AMEND NO. OF CONTACTS	17 25/09/08 - NYM
ADD NOTES 2	18 09/10/08 - NYM
ADD PCB CLEARANCE DIAGRAM	

Scale 8:1	THIRD ANGLE	General Tolerances $\Delta$ X $\pm$ 0.20 XX $\pm$ 0.15	Material SEE NOTE	 www.gradconn.com THIS DRAWING IS CONFIDENTIAL AND MUST NOT BE COPIED OR DISCLOSED WITHOUT WRITTEN CONSENT	Type BB02-AL
Drawn CHC			NOT TO SCALE		BB02-AL
App'd XXX	Title SOCKET		Unit: mm		Drawing Number
Date 9 OCT '08	Revision: 1.8				Sheet 1 of 1
					Drawing  E and OE