

BB02-PG - 0.5mm (0.0197") BOARD STACKER FEMALE 10 TO 120 CONTACTS

SPECIFICATIONS

CURRENT RATING 0.5 AMP AC/DC
 VOLTAGE RATING 50V AC/DC
 CONTACT RESISTANCE 30m OHM MAX
 INSULATION RESISTANCE 100M OHM MIN. AT 100V DC
 DIELECTRIC WITHSTANDING AC 100V (r.m.s.) FOR 1 MINUTE
 OPERATING TEMPERATURE -20° TO +105°C
 CONTACT MATERIAL PHOSPHOR BRONZE
 INSULATOR MATERIAL HI-TEMP PLASTIC (UL 94V-0)
 STANDARD: NYLON 46 (WHITE)
 PLATING GOLD FLASH OVER 30~50U" NICKEL
 MAX. PROCESSING TEMP 260°C FOR 5-10 SECONDS
 MATING CYCLES: 500 TIMES MIN.
 MATES WITH: - BB02-PE
 MATING PARTS AND MATING HEIGHT: -

MALE \ FEMALE	MATING HEIGHT			
	PEXX1-KA8	PEXX1-KB8	PEXX1-KC8	PEXX1-KD8
PGXX2-KA8	3.0MM	3.5MM		
PGXX2-KB8		4.0MM		
PGXX2-KC8			5.0MM	5.5MM
PGXX2-KD8		4.5MM		
PGXX2-KE8				6.0MM

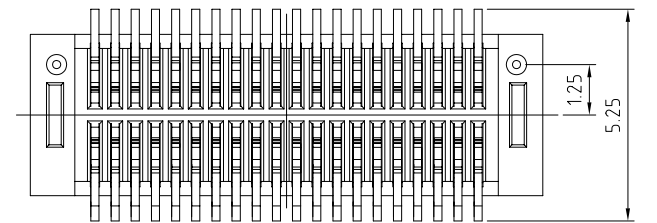
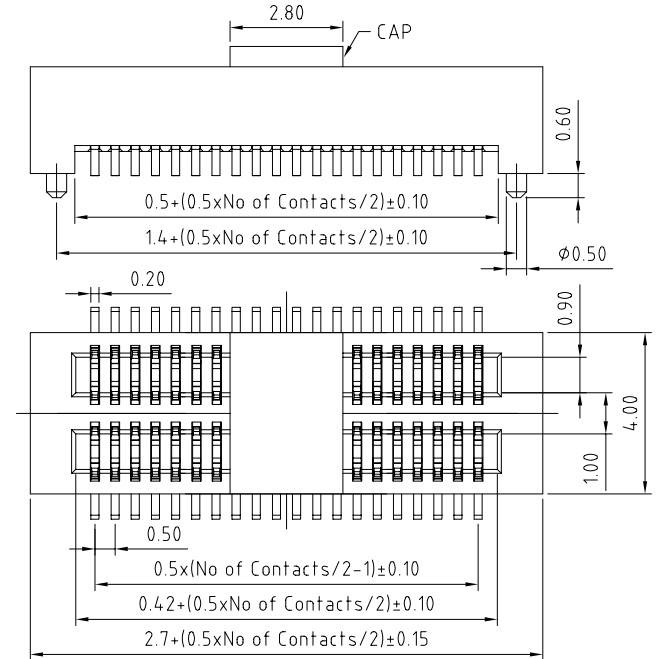
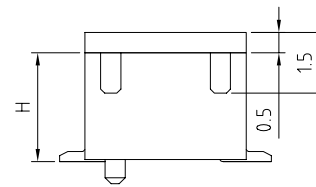
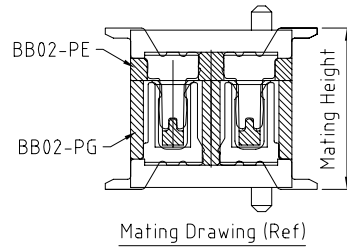

NOTES:

- 1. PACK UNIT PER REEL: \triangle \triangle
 PGXX2-KA8: 1,400PCS (MOQ: 5,600PCS)
 PGXX2-KB8: 1,200PCS (MOQ: 6,000PCS)
 \triangle PGXX2-KC8: 1,000PCS (MOQ: 5,000PCS)
 PGXX2-KD8: 1,000PCS (MOQ: 5,000PCS)
 PGXX2-KE8: 1,000PCS (MOQ: 5,000PCS)

PART NO.	AVAILABLE PIN NUMBERS
PGXX2-KA8	10, 12, 20, 24, 30, 32, 40, 50, 70, 80, 90, 100, 120
PGXX2-KB8	10, 12, 20, 24, 30, 40, 50, 70, 80, 90, 100, 120
PGXX2-KC8	10, 12, 20, 24, 30, 32, 38, 40, 50, 60, 80, 100, 120
PGXX2-KD8	10, 12, 20, 24, 30, 32, 40, 50, 60, 70, 80, 90, 100, 120
PGXX2-KE8	10, 12, 20, 24, 30, 32, 38, 40, 50, 60, 80, 100, 120

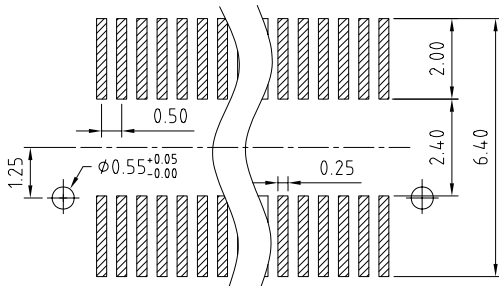

RECOMMENDED PC BOARD LAYOUT

HOW TO ORDER

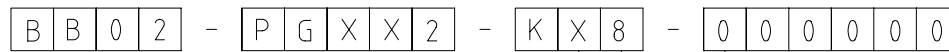

NO OF CONTACTS

10 - 120
 00 = 100PIN
 A0 = 120PIN
 (Please refer to chart for available pin#.)

"H" HEIGHT OPTIONS

A = 2.2MM
 B = 2.7MM
 C = 3.0MM
 D = 3.2MM
 E = 3.5MM

PACKAGING OPTIONS

8 - REEL + CAP
 (Smaller PO for prototype will be packed in tube, code: 3.)

\triangle 0 = WITH LOCATING PEGS

REV. DATE & DRN	10 31/08/07 - N/W RELEASE
1. ADD MOD.	14 08/07/08 - CHC
2. AMEND QTY OF C	15 29/05/08 - NYW
3. AMEND REEL QTY OF C	16 07/07/08 - NYW
4. AMEND HEIGHT	17 13/01/10 - NYW
5. ADD TOLERANCE	18 25/02/10 - NYW
6. ADD MATING CYCLES	
7. ADD MOUNTING OPTION	
8. ADD PIN TO CABLE HEIGHTS	
9. REMOVE WITHOUT PEG OPTION	
10. ADD BIPIN TO A HEIGHT	

Scale 8:1	THIRD ANGLE
Drawn CHC	
App'd XXX	Title SOCKET
Date 25 FEB '10	Revision: 1.8

General Tolerances \triangle	Material SEE NOTE
X ±0.20	
XX ±0.15	
	NOT TO SCALE
	Unit: mm

www.gradconn.com

THIS DRAWING IS CONFIDENTIAL AND MUST NOT BE COPIED OR DISCLOSED WITHOUT WRITTEN CONSENT

Type BB02-PG
BB02-PG
Drawing Number
Sheet 1 of 1
Drawing \triangle E and O E