

BB02-YL:- 1.00MM (0.039") PIN HEADER, SINGLE ROW, STRAIGHT, THROUGH HOLE TYPE, 02 TO 40 CONTACTS, BOARD SPACER

SPECIFICATIONS

CURRENT RATING: 1AMP
 INSULATOR RESISTANCE: 500 MEGOHMS MIN.
 DIELECTRIC WITHSTANDING: AC 600 V
 CONTACT RESISTANCE: 20m OHMS MAX.
 OPERATING TEMPERATURE: -40°C TO +105°C
 CONTACT MATERIAL: BRASS
 INSULATOR MATERIAL: THERMOPLASTIC, UL 94V-0
 STANDARD: LCP
 PLATING: GOLD FLASH OR TIN OVER 30-50U" NICKEL
 SOLDERABILITY IR REFLOW: 280°C FOR 10 SEC
 WAVE: 250°C FOR 5-10 SEC
 MANUAL SOLDER: 380°C FOR 3-5 SEC

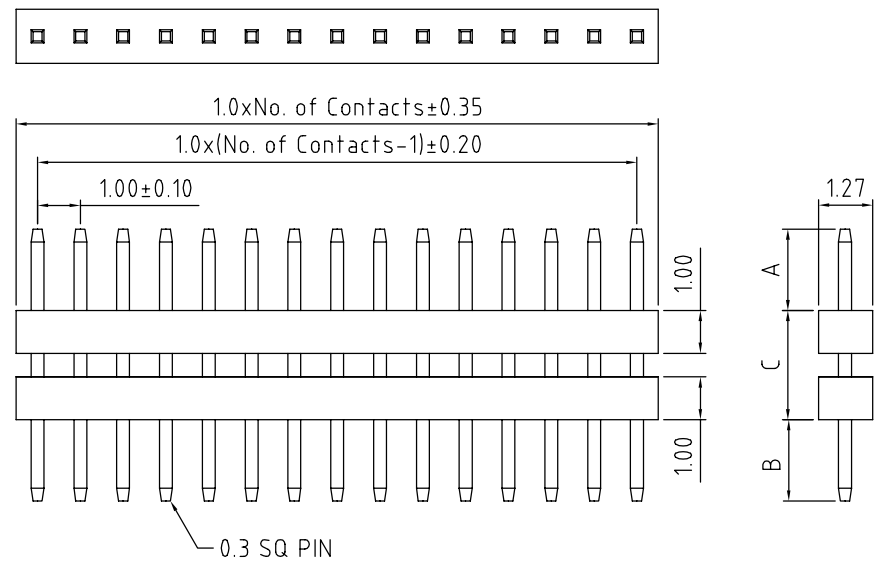
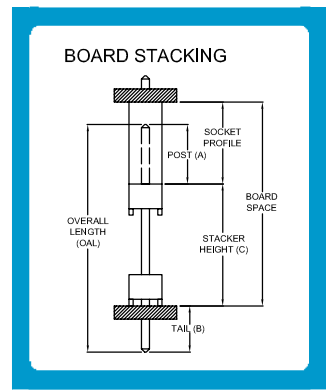

PACKAGING: LOOSE IN BOX OR BAG.

MATES WITH: - BB02-WD BB02-WF
 BB02-WE

NOTES:
 1. MIN. OAL (OVERALL PIN LENGTH A+B+C) = 5.1MM.
 2. MAX. OAL (OVERALL PIN LENGTH A+C+B) = 20MM.⚠

HOW TO ORDER

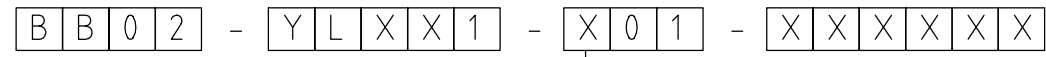

NO. OF CONTACTS 02 to 40	CONTACT PLATING OPTIONS K = GOLD FLASH (STANDARD) T = BRIGHT TIN M = MATT TIN	PIN LENGTH A (1/10mm) SPECIFY PIN LENGTH STANDARD = 15 = 1.5mm MINIMUM = 10 = 1.0mm MAXIMUM = 150 = 15.0mm TOL.: ±0.25mm	PIN LENGTH B (1/10mm) SPECIFY PIN LENGTH STANDARD = 30 = 3.0mm MINIMUM = 10 = 1.0mm MAXIMUM = 150 = 15.0mm TOL.: ±0.25mm	PIN LENGTH C (1/10mm) SPECIFY PIN LENGTH MINIMUM = 20 = 2.0mm MAXIMUM = SEE NOTES 2 TOL.: ±0.25mm
-----------------------------	--	---	---	---

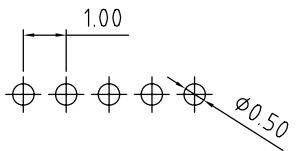

(TOLERANCE: ±0.05)
 RECOMMENDED PCB HOLE LAYOUT

LONGER PIN LENGTH REQUIRED?
 If pin length required is longer than 9.9mm (99), then use a '/' to separate the numbers.
 Example: A=6.0mm, B=3.0mm, C=11.0mm, mark as 60 / 30 / 110.

REV. DATE & DRN 10 10/02/09 - NYW RELEASE 11 10/06/09 - NYW AMEND STANDARD A = 15. 12 30/11/09 - CHC AMEND NOTES 2.	Scale: 8:1	THIRD ANGLE	Unstated Tolerances: X ± 0.30 X ± 0.25 XX ± 0.15 XXX ± 0.10	Material SEE NOTE	 www.gradconn.com	Type BB02-YL
	Drawn: NYW					BB02-YL
	App'd: XXX	Title: PIN HEADER		NOT TO SCALE		Drawing Number:
	Date: 30 NOV '09	Revision: 1.2		Unit: mm		Sheet 1 of 1
					THIS DRAWING IS CONFIDENTIAL AND MUST NOT BE COPIED OR DISCLOSED WITHOUT WRITTEN CONSENT	Drawing E and O E