

BB02-RG :-2.0mm x 2.0mm (0.079" x 0.79") SOCKET, STRAIGHT, SMD, DUAL ROW - 04 to 80 CONTACTS LOW PROFILE:2.2mm, DUAL ENTRY

SPECIFICATIONS

CURRENT RATING	2 AMP
INSULATOR RESISTANCE	1000 MEGOHMS MIN.
CONTACT RESISTANCE	20m ohms MAX.
DIELECTRIC WITHSTANDING	AC 500 V
OPERATING TEMPREATURE	-40°C TO +105°C
CONTACT MATERIAL	PHOSPHOR BRONZE
INSULATOR MATERIAL	THERMOPLASTIC, UL 94V-0 STANDARD: NYLON 6T
PLATING	GOLD OR TIN OVER 30-50U" NICKEL
SOLDERABILITY	IR REFLOW: 260°C FOR 10 SEC MANUAL SOLDER: 350°C FOR 3-5 SEC

NOTES:

1. RECOMMENDED MATING PIN LENGTH FOR TOP ENTRY: 1.5MM. Δ
2. PARTS WITH SMALLER NUMBER OF CONTACTS MIGHT BE PACKED IN BOX INSTEAD OF IN TUBE.

MATES WITH:

BB02-FA	BB02-FZ
BB02-FD	BB02-RH
BB02-FE	BB02-RN
BB02-FG	BB02-2F
BB02-FU	BB02-4F

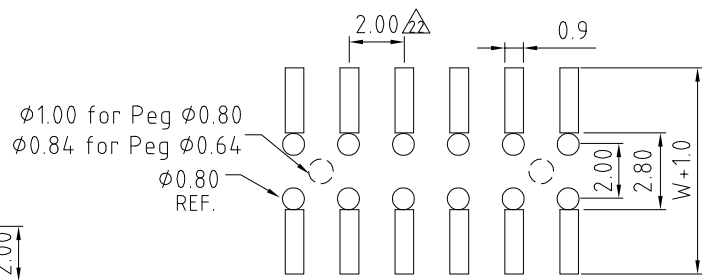
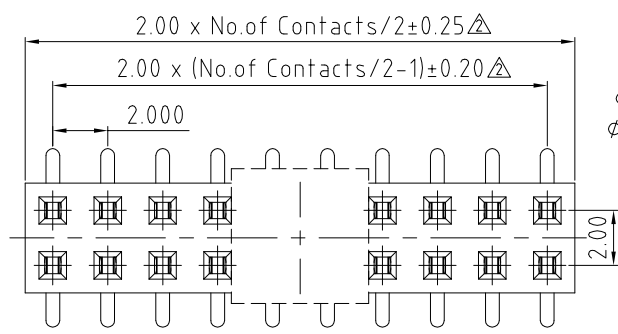
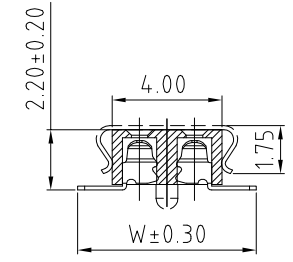
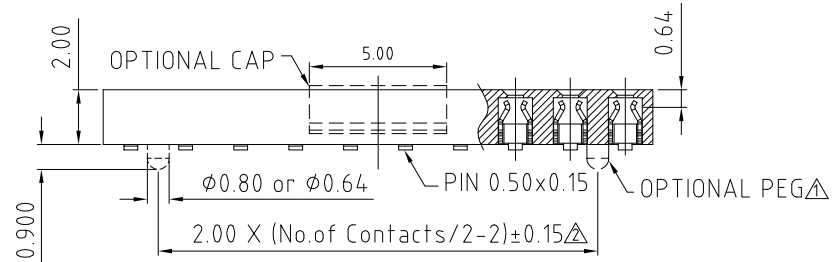

BOTTOM ENTRY TYPE
RECOMMENDED PC BOARD LAYOUT
(TOLERANCE:±0.05)

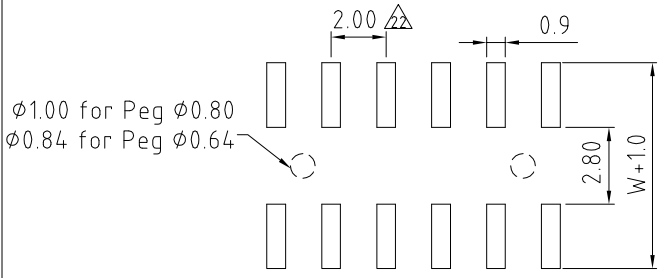

TOP ENTRY TYPE
RECOMMENDED PC BOARD LAYOUT
 Δ (TOLERANCE:±0.05)

HOW TO ORDER

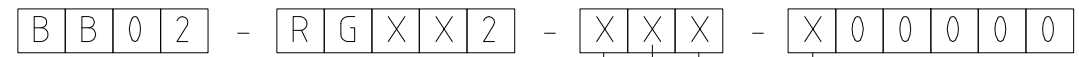

- NO. OF CONTACTS:** Δ 04 TO 80 (MIN. 06 FOR W/PEG)
- CONTACT PLATING OPTIONS:**
 - Δ K = GOLD FLASH (STANDARD)
 - Δ A = 10U" GOLD ON CONTACT/GOLD FLASH ON TAIL
 - Δ B = 15U" GOLD ON CONTACT/GOLD FLASH ON TAIL
 - Δ C = 30U" GOLD ON CONTACT/GOLD FLASH ON TAIL
 - Δ T = BRIGHT TIN
 - Δ M = MATT TIN
- FOOTPRINT "W" OPTIONS:**
 - Δ 0 = 6.5MM
 - Δ A = 5.3MM
 - Δ B = 6.1MM
- PACKAGING OPTIONS:**
 - Δ 3 = TUBE
 - Δ 4 = TUBE + FILM
 - Δ 5 = TUBE + CAP
 - Δ 6 = TAPE & REEL
 - Δ 7 = TAPE & REEL + FILM
 - Δ 8 = TAPE & REEL + CAP (see note 2)
- LOCATING PEG OPTIONS:**
 - Δ A = WITH PEG ϕ 0.80 (W=6.5 OR 5.3)
 - Δ B = WITHOUT PEG
 - Δ C = WITH PEG ϕ 0.64 (W=6.5, 5.3 OR 6.1)

REV. DATE & DRN	10. 12/05/05 - NYW RELEASE
11. 3/06/07 - NYW	12. 06/06/06 - NYW
13. 08/08/06 - NYW	14. 02/10/06 - CHC
15. 31/05/07 - NYW	16. 25/07/07 - CHC
17. 16/10/07 - CHC	18. 08/07/08 - NYW
19. 04/03/08 - CHC	20. 10/03/08 - CHC
21. 31/12/08 - NYW	22. 23/03/10 - NYW
23. 04/05/12 - NYW	24. 30/10/13 - NYW
25. 07/03/14 - NYW	26. 12/10/20 - NYW

Scale: 5:1	THIRD ANGLE	Unstated Tolerances: X ± 0.30 X ± 0.25 XX ± 0.15 XXX ± 0.10	Material SEE NOTE
Drawn: NYW			NOT TO SCALE
App'd: XXXX	Title: SOCKET		Unit: mm
Date: 12 OCT. '20	Revision: 2.6		

www.gradconn.com

Type: BB02-RG
BB02-RG
Drawing Number:
Sheet 1 of 1
Drawing © E and OE