

BB02-HA :- 2.54mm (0.1") PIN HEADER,SINGLE ROW, THROUGH HOLE 02 TO 40 CONTACTS

SPECIFICATIONS

CURRENT RATING 3 AMP
 INSULATOR RESISTANCE 1000 MEGOHMS MIN.
 DIELECTRIC WITHSTANDING AC 600 V
 OPERATING TEMPERATURE -40°C TO 105°C
 CONTACT MATERIAL BRASS
 INSULATOR MATERIAL THERMOPLASTIC, UL 94V-0
 NYLON 6T : STANDARD
 PLATING GOLD, TIN OR SELECTIVE OVER 30-50U" NICKEL
 SOLDERABILITY: IR REFLOW: 260°C FOR 10 SEC
 WAVE: 230°C FOR 5-10 SEC
 MANUAL SOLDER: 350°C FOR 3-5 SEC
 PACKED LOOSE IN BAG OR BOX.

MATES WITH :- BB02-JB BB02-JL
 BB02-JC BB02-JR
 BB02-JD BB02-JS
 BB02-JE BB02-JT
 BB02-JF BB02-JU
 BB02-JG BB02-KR
 BB02-JJ

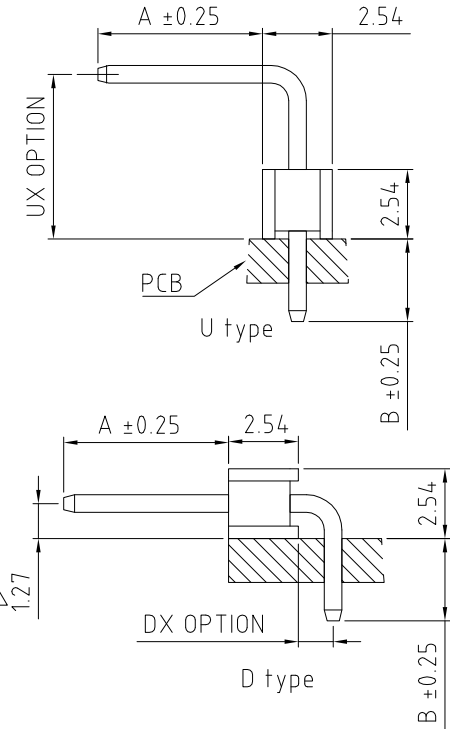
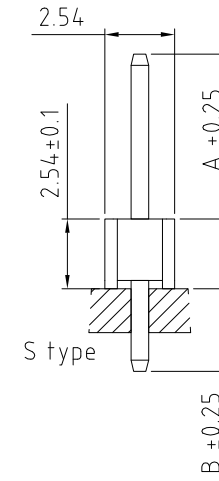
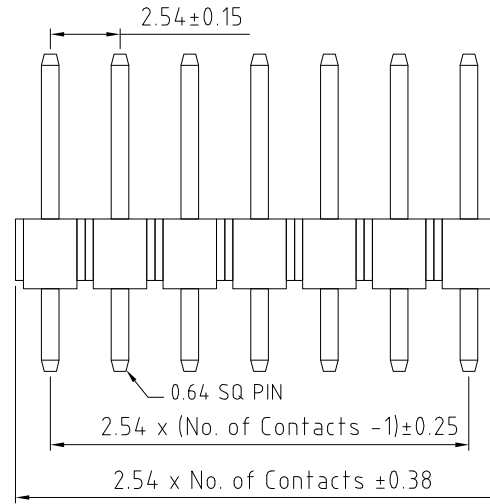

HOW TO ORDER

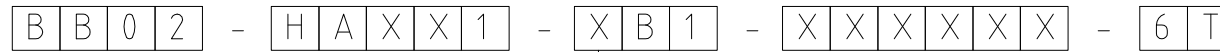

NO. OF CONTACTS:
02 TO 40

CONTACT PLATING OPTIONS:
 K = GOLD FLASH (STANDARD)
 A = 10U" GOLD ON CONTACT/GOLD FLASH ON TAIL
 B = 15U" GOLD ON CONTACT/GOLD FLASH ON TAIL
 C = 30U" GOLD ON CONTACT/GOLD FLASH ON TAIL
 T = BRIGHT TIN
 M = MATT TIN
 D = GOLD FLASH ON CONTACT/BRIGHT TIN ON TAIL
 E = 10U" GOLD ON CONTACT/BRIGHT TIN ON TAIL
 F = 15U" GOLD ON CONTACT/BRIGHT TIN ON TAIL
 G = 30U" GOLD ON CONTACT/BRIGHT TIN ON TAIL

PIN LENGTH A (1/10mm)
PLEASE SPECIFY PIN LENGTH REQUIRED
I.E. 2.5mm = 25
STANDARD = 60

PIN LENGTH B (1/10mm)
PLEASE SPECIFY PIN LENGTH REQUIRED
I.E. 2.5mm = 25
STANDARD = 30

CONNECTOR TYPE:
 S0 = STRAIGHT
 U1 = UP ANGLE 4.8mm
 U2 = UP ANGLE 6.0mm
 U3 = UP ANGLE 6.6mm
 U4 = UP ANGLE 2.86mm
 U5 = UP ANGLE 3.3mm
 U6 = UP ANGLE 8.5mm
 D1 = DOWN ANGLE 1.5mm
 D2 = DOWN ANGLE 2.0mm
 D3 = DOWN ANGLE 0.32mm
 D4 = DOWN ANGLE 1.0mm
 D5 = DOWN ANGLE 0.68mm
 D6 = DOWN ANGLE 1.36mm

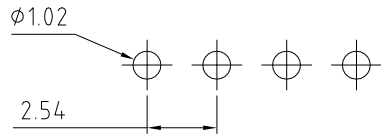

RECOMMENDED PCB HOLE LAYOUT (TOLERANCE: ±0.05)

REV.	DATE & DRN
10	29/06/02 - SJT - NEW
11	03/07/04 - NJR
12	23/08/04 - NYW
13	25/01/05 - NYW
14	14/08/06 - NYW
15	25/02/08 - NYW
16	29/08/08 - NYW
17	06/02/09 - CHC
18	19/06/09 - NYW
19	11/09/13 - NYW
20	27/01/16 - NYW
21	12/10/18 - NYW
22	16/03/19 - NYW

Scale:	5:1
Drawn:	SJT
App'd:	XXXX
Date:	6 MAR. '19

THIRD ANGLE	Unstated Tolerances: X ± 0.30 .X ± 0.25 .XX ± 0.15 .XXX ± 0.10
Title	PIN HEADER
Revision:	2.2

Material	SEE NOTE
Unit:	mm

www.gradconn.com

THIS DRAWING IS CONFIDENTIAL AND MUST NOT BE COPIED OR DISCLOSED WITHOUT WRITTEN CONSENT

Type:	BB02-HA
Drawing Number:	BB02-HA
Sheet 1 of 1	
Drawing	E and OE