

BB02-BE :- 1.27mm X 1.27mm (0.05" X 0.05") BOX HEADER, THROUGH HOLE, DUAL ROW, STRAIGHT - 10 TO 100 CONTACTS

SPECIFICATIONS :

CURRENT RATING	1 AMP
INSULATOR RESISTANCE	1000 MEGOHMS MIN.
DIELECTRIC WITHSTANDING	AC 300 V
CONTACT RESISTANCE	20m OHMS MAX.
OPERATING TEMPERATURE	-40°C TO +105°C
CONTACT MATERIAL	PHOSPHOR BRONZE
INSULATOR MATERIAL	THERMOPLASTIC, UL 94V-0 STANDARD : LCP + 30% G/F Δ
PLATING	GOLD, TIN, OR SELECTIVE OVER 30~50U" NICKEL
SOLDERABILITY	IR REFLOW: 280°C FOR 10 SEC WAVE: 250°C FOR 5-10 SEC MANUAL SOLDER: 380°C FOR 3-5 SEC

PACKED IN TRAY OR TUBE.

MATES WITH

PERFECT MATING PARTS: BB02-CM, BB02-CU
OTHER MATING PARTS: BB02-CL, BB02-CN (4.40MM PROFILE ONLY)

NOTES:

1. MATING HEIGHTS:

- a). WITH INSULATION HEIGHT OF A=5.7MM, THE MATING HEIGHT IS 1.6MM+SOCKET HEIGHT.
- b). WITH INSULATION HEIGHT OF B=7.3MM, THE MATING HEIGHT IS 3.2MM+SOCKET HEIGHT.

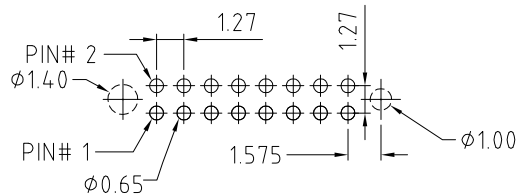

RECOMMENDED PC BOARD SMD LAYOUT
(TOLERANCE: ±0.05)

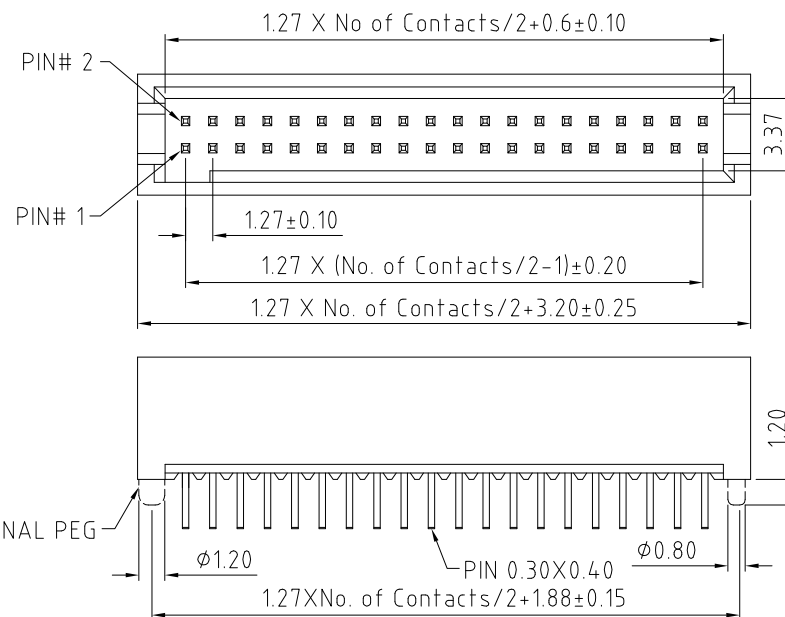
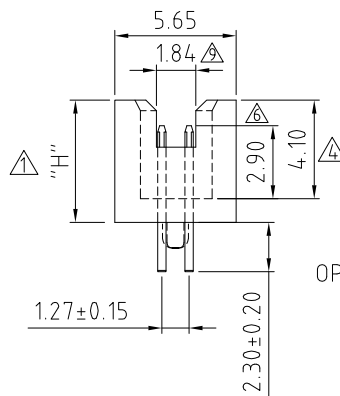

HOW TO ORDER

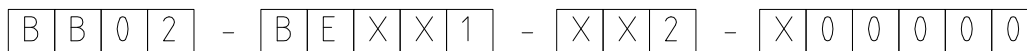

NO. OF CONTACTS:
10 TO 98
100 Contacts = 00

Δ CONTACT PLATING OPTIONS:

- K = GOLD FLASH (STANDARD)
- A = 10U" GOLD ON CONTACT/GOLD FLASH ON TAIL
- B = 15U" GOLD ON CONTACT/GOLD FLASH ON TAIL
- C = 30U" GOLD ON CONTACT/GOLD FLASH ON TAIL
- T = BRIGHT TIN
- M = MATT TIN
- D = GOLD FLASH ON CONTACT/BRIGHT TIN ON TAIL
- E = 10U" GOLD ON CONTACT/BRIGHT TIN ON TAIL
- F = 15U" GOLD ON CONTACT/BRIGHT TIN ON TAIL
- G = 30U" GOLD ON CONTACT/BRIGHT TIN ON TAIL

Δ "H" HEIGHT
OPTIONS:
A = 5.70MM
B = 7.30MM

LOCATING PEG OPTIONS:
A = WITH PEG
B = WITHOUT PEG

REV.	DATE & DRN	10	19/09/05 - CHC RELEASE
11	28/10/05 - NYW	11	ADD INSULATOR H OPTION
12	17/07/06 - NYW	12	AMEND PLATING OPTIONS
13	20/05/08 - CHC	13	DRAWING MODIFICATION
14	14/08/08 - NYW	14	PLATING MODIFICATION
15	02/07/08 - CHC	15	ADD INSULATOR DIMENSION
16	25/11/08 - NYW	16	ADD PIN T INDICATION
17	27/02/10 - NYW	17	ADD DIMENSION
18	04/03/11 - NYW	18	CHANGE INSULATOR TO LCP
19	26/02/15 - NYW	19	AMEND MATES WITH P/N
20	21/06/17 - NYW	20	ADD DIMENSION
21		21	AMEND PIN MATERIAL

Scale:	4:1
Drawn:	CHC
App'd:	NYW
Date:	21 JUN. '17

THIRD ANGLE	
Title	BOX HEADER
Revision:	2.0

Unstated Tolerances:	X ± 0.30
	X ± 0.25
	XX ± 0.15
	XXX ± 0.10

Material	SEE NOTE
	NOT TO SCALE
UNIT:	mm

www.gradconn.com

THIS DRAWING IS CONFIDENTIAL AND MUST NOT BE COPIED OR DISCLOSED WITHOUT WRITTEN CONSENT

Type:	BB02-BE
	BB02-BE
Drawing Number:	Sheet 1 of 1
	Drawing © E and O E