

BB02-AY:- 0.8x1.2MM PIN HEADER, DUAL ROW, STRAIGHT, SMT TYPE, 06 TO 100 CONTACTS

**SPECIFICATIONS:**

- CURRENT RATING: 0.5AMP
- INSULATOR RESISTANCE: 1000 MEGOHMS MIN.
- DIELECTRIC WITHSTANDING: AC 300 V
- CONTACT RESISTANCE: 20m OHMS MAX.
- OPERATING TEMPERATURE: -40°C TO +105°C
- CONTACT MATERIAL: PHOSPHOR BRONZE
- INSULATOR MATERIAL: POLYESTER UL 94V-0
- STANDARD: LCP OR EQUIVALENT
- PLATING: GOLD, TIN OR SELECTIVE FLASH OVER 30-50U" NICKEL
- SOLDERABILITY IR REFLOW: 260°C FOR 10 SEC
- MANUAL SOLDER: 350°C FOR 3-5 SEC

**NOTES:**

1. PRODUCTS WITH 6 CONTACTS ARE PACKED IN BOX.

MATES WITH: - BB02-AZ

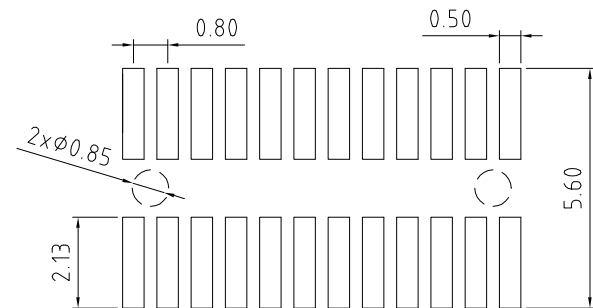
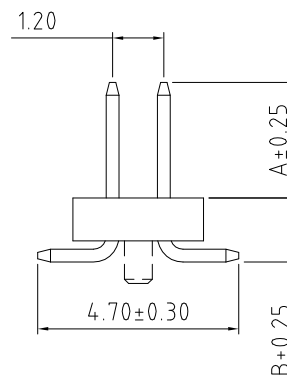
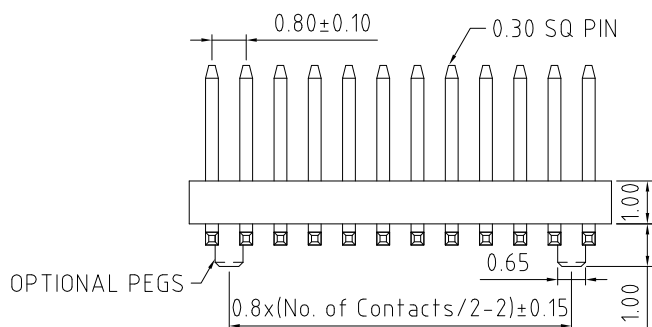
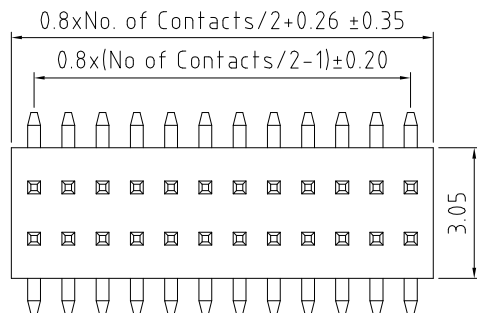

RECOMMENDED PCB HOLE LAYOUT

**HOW TO ORDER**

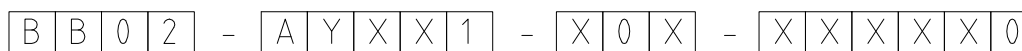

NO. OF CONTACTS:  
 06 to 98  
 00 = 100

CONTACT PLATING OPTIONS:  
 K = GOLD FLASH (STANDARD)  
 T = BRIGHT TIN  
 M = MATT TIN  
 D = GOLD FLASH ON CONTACT/BRIGHT TIN ON TAIL

PACKAGING OPTIONS:  
 3 = TUBE (SEE NOTE 1)  
 8 = T & R + CAP

PIN LENGTH A (1/10mm)  
 PLEASE SPECIFY PIN LENGTH  
 REQUIRED  
 I.E. 2.5mm = 25  
 STANDARD = 27

PIN LENGTH B (1/10mm)  
 PLEASE SPECIFY PIN LENGTH  
 REQUIRED  
 I.E. 2.5mm = 25  
 STANDARD = 15

LOCATING PEG OPTIONS:  
 A = WITH PEG  
 B = WITHOUT PEG

|      |                |  |
|------|----------------|--|
| REV. | DATE & DRN     | RELEASE  |
| 10   | 08/08/08-NYW   |  |
| 11   | 20/07/10-NYW   | ADD PACKAGING OPTION 8                             |
| 12   | 24/07/13 - NYW | ADD INSULATOR MATERIAL TO LCP                      |
| 13   | 06/09/13 - NYW | ADD NOTE 1 TO PACKAGING REMOVE PACKAGING OPTION 6. |

|                  |                   |  |                      |
|------------------|-------------------|--|----------------------|
| Scale: 8:1       | THIRD ANGLE       | Unstated Tolerances:<br>X ± 0.25<br>.XX ± 0.15<br>XXX ± 0.10 | Material<br>SEE NOTE |
| Drawn: NYW       |                   |  |                      |
| App'd: XXX       | Title: PIN HEADER |  | NOT TO SCALE         |
| Date: 6 SEP. '13 | Revision: 1.3     |  | Unit: mm             |

www.gradconn.com

THIS DRAWING IS CONFIDENTIAL AND MUST NOT BE COPIED OR DISCLOSED WITHOUT WRITTEN CONSENT

|                     |
|---------------------|
| Type BB02-AY        |
| BB02-AY             |
| Drawing Number:     |
| Sheet 1 of 1        |
| Drawing © E and O E |