



BB02-5B :- 1.27mm (0.05") PIN HEADER, SINGLE ROW, U TYPE, THROUGH HOLE, 01 to 50 CONTACTS

SPECIFICATIONS

CURRENT RATING	1 AMP
VOLTAGE RATING	100V AC/DC
CONTACT RESISTANCE	30m OHMS MAX.
INSULATOR RESISTANCE	5000 MEGOHMS MIN.
DIELECTRIC WITHSTANDING	AC 500 V
OPERATING TEMPERATURE	-40°C TO +105°C
CONTACT MATERIAL	BRASS
INSULATOR MATERIAL	THERMOPLASTIC, UL 94V-0
	STANDARD : NYLON 6T

PLATING GOLD, TIN, OR SELECTIVE OVER 30-50U" NICKEL  
 SOLDERABILITY: IR REFLOW: 260°C FOR 10 SEC  
 WAVE: 230°C FOR 5-10 SEC  
 MANUAL SOLDER: 350°C FOR 3-5 SEC

NOTES:

- 1. BULK PACKAGE IN BAG.
- MATES WITH:- BB02-CP
- BB02-CT
- BB02-CY

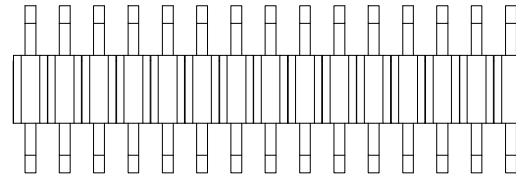

(EXAMPLE OF 15 CONTACTS PART)

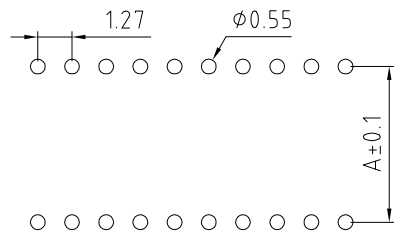
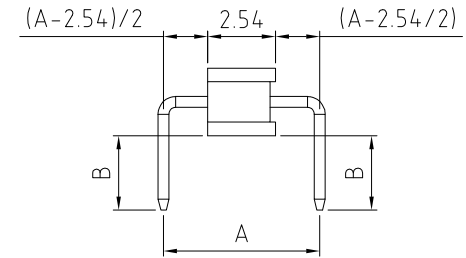
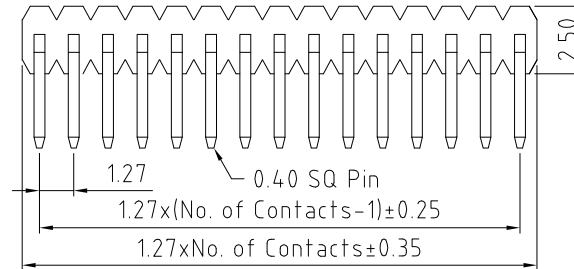

(TOLERANCE: ±0.05)  
 RECOMMENDED PCB HOLE LAYOUT

HOW TO ORDER

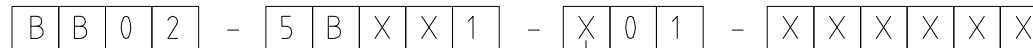

NO. OF CONTACTS:  
 01 TO 50

CONTACT PLATING OPTIONS :  
 K = GOLD FLASH (STANDARD)  
 T = BRIGHT TIN  
 M = MATT TIN  
 P = 10U" GOLD ALL OVER  
 Q = 15U" GOLD ALL OVER  
 R = 30U" GOLD ALL OVER

PIN LENGTH A (1/10mm)  
 SPECIFY PIN LENGTH  
 STANDARD = 050 = 5.0mm  
 MINIMUM = 050 = 5.0mm  
 MAXIMUM = 200 = 20.0mm  
 TOL.: ±0.25mm

PIN LENGTH B (1/10mm)  
 SPECIFY PIN LENGTH  
 STANDARD = 026 = 2.6mm  
 MINIMUM = 020 = 2.0mm  
 MAXIMUM = 150 = 15.0mm  
 TOL.: ±0.25mm

REV. DATE & DRN  
 1.0 27/02/13 - NYW RELEASE  
 1.1 13/05/13 - NYW  
 ADD MATING HALVES

Scale: 5:1	THIRD ANGLE	Unstated Tolerances: X ± 0.30 X ± 0.25 XX ± 0.15 XXX ± 0.10	Material SEE NOTE
Drawn: NYW			
App'd: XXXX	Title: PIN HEADER		NOT TO SCALE
Date: 13 MAY '13	Revision: 1.1		Unit: mm

www.gradconn.com

THIS DRAWING IS CONFIDENTIAL AND MUST NOT BE COPIED OR DISCLOSED WITHOUT WRITTEN CONSENT

Type: BB02-5B
BB02-5B
Drawing Number:
Sheet 1 of 1
Drawing © E and O E